

64157

TEMPORARY AND EXISTING SIGNALS IL 2 AT COLFAX

F.A.P. RTE.	SECTION	COUNTY	TOTAL SHEETS	SHEET NO.
742	37R-2	OGLE	389	134
STA.		TO STA.		
FED. ROAD DIST. NO.		ILLINOIS	FED. AID PROJECT	

SHEET 5 OF 10

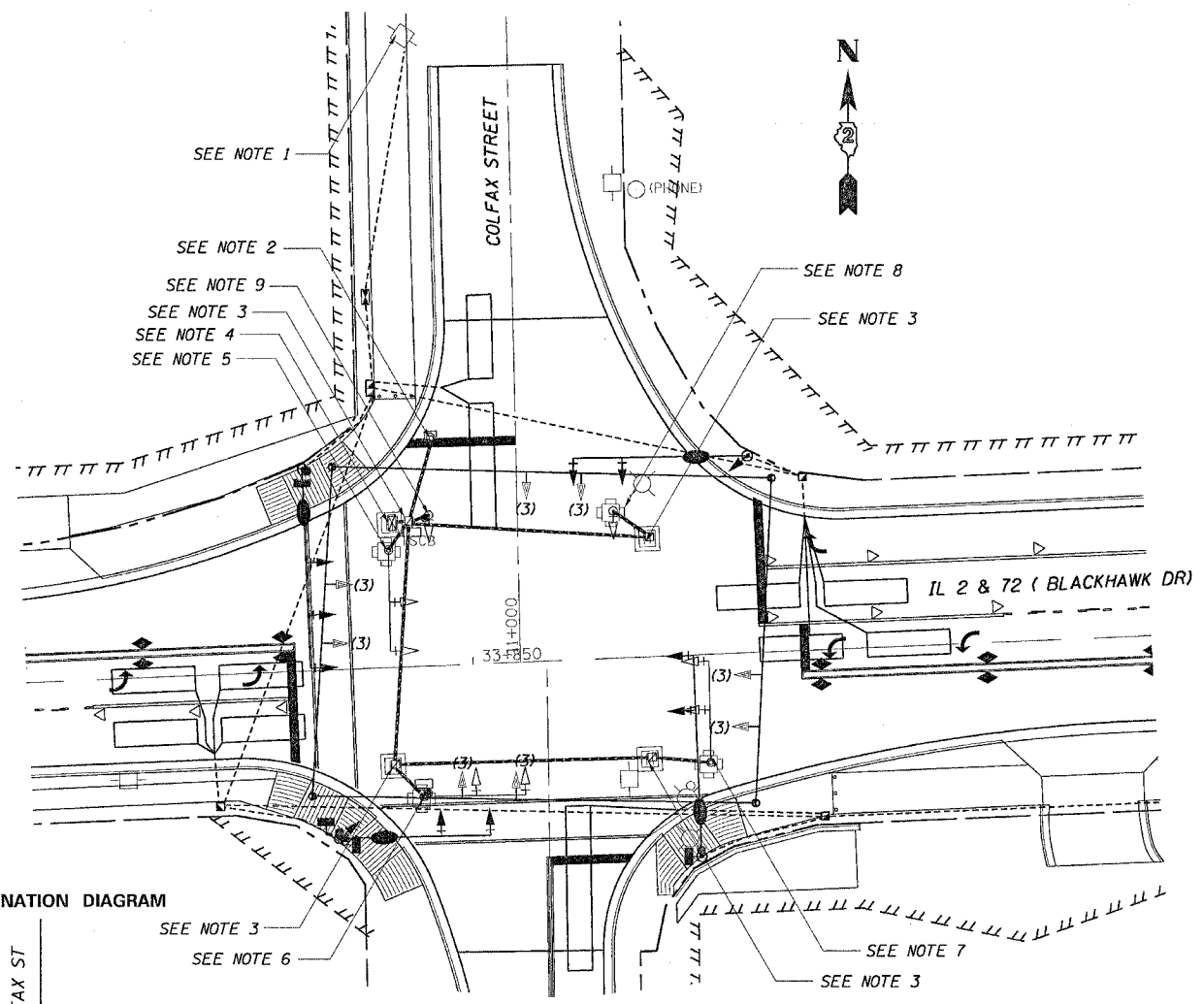

- NOTES**
- REMOVE THE EXISTING SERVICE INSTALLATION.
 - REMOVE THE EXISTING JUNCTION BOX.
 - REMOVE THE EXISTING CONCRETE HANDHOLE.
 - REMOVE THE EXISTING CONTROLLER AND CABINET.
 - REMOVE THE EXISTING SIGNAL HEADS, MAST ARM ASSEMBLY, POLE AND FOUNDATION.
 - REMOVE THE EXISTING SIGNAL HEADS, MAST ARM ASSEMBLY, POLE PEDESTRIAN HEAD, PEDESTRIAN PUSHBUTTON AND FOUNDATION.
 - REMOVE THE EXISTING SIGNAL HEAD, POST AND FOUNDATION.
 - REMOVE THE EXISTING SIGNAL HEAD, PEDESTRIAN HEAD, PEDESTRIAN PUSHBUTTON, POST AND FOUNDATION.
 - THE FOLLOWING EXISTING TRAFFIC SIGNAL EQUIPMENT SHALL BE REMOVED BY THE CONTRACTOR AND RETAINED BY HIM FOR SALVAGE VALUE.

8	EACH	ONE(1) FACE SIGNAL HEAD
2	EACH	ONE(1) FACE PEDESTRIAN HEAD
2	EACH	PEDESTRIAN PUSHBUTTON
2	EACH	SIGNAL POST
2	EACH	MAST ARM ASSEMBLY AND POLE
1	EACH	CONTROLLER AND CABINET
1	EACH	SERVICE INSTALLATION
ALL	FOOT	ELECTRIC CABLE BEING REPLACED
 - THE TEMPORARY SIGNAL CABLE SHALL HAVE SUFFICIENT SLACK SO THAT THE SIGNAL HEADS CAN BE RELOCATED DURING THE VARIOUS CONSTRUCTION STAGES

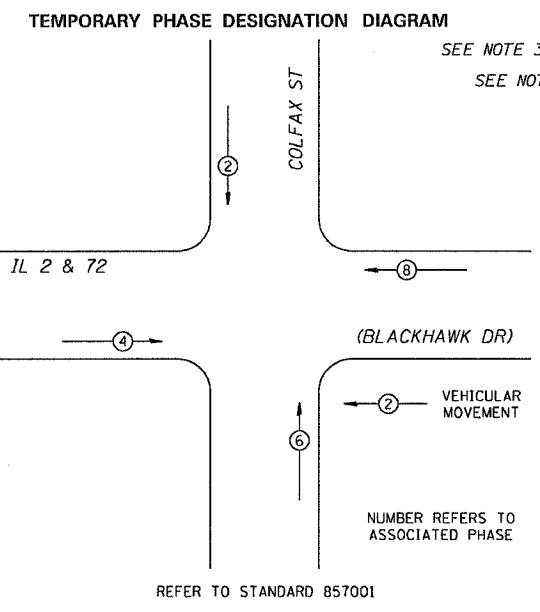

- LEGEND**
- TETHER AND SPAN WIRE
 - ⊗ WOOD POLE
 - (3) ◁ TEMPORARY SIGNAL (NUMBER OF SECTIONS)
 - ⊙ PEDESTRIAN PUSHBUTTON
 - ▬ PEDESTRIAN HEAD

REVISIONS		ILLINOIS DEPARTMENT OF TRANSPORTATION
NAME	DATE	
L. HILL	7/5/02	

DATE 7/30/02

DRAWN BY L.D.HILL
CHECKED BY H.KNUDSON

Mon Aug 30 07:25:35 2004
 c:\p\projects\m288956\tr\af_plm.dgn