

T10N, R7E, SECTION 4

F.A.I. RTE.	SECTION	COUNTY	TOTAL SHEETS	SHEET NO.
57		**	76	26
STA. 144+00	TO STA. 176+00			
FED. ROAD DIST. NO.	ILLINOIS FED. AID PROJECT			

CONTRACT NO. T0028  
 (15,18-20) RS-2 (15-22) RS-2  
 COLES & CUMBERLAND  
 1"=100'

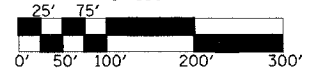

EXISTING 36" x 156'  
 R.C. PIPE CULVERT  
 W/STD. 1976 D36-2 HDWL  
 A.R. STATION 176+24

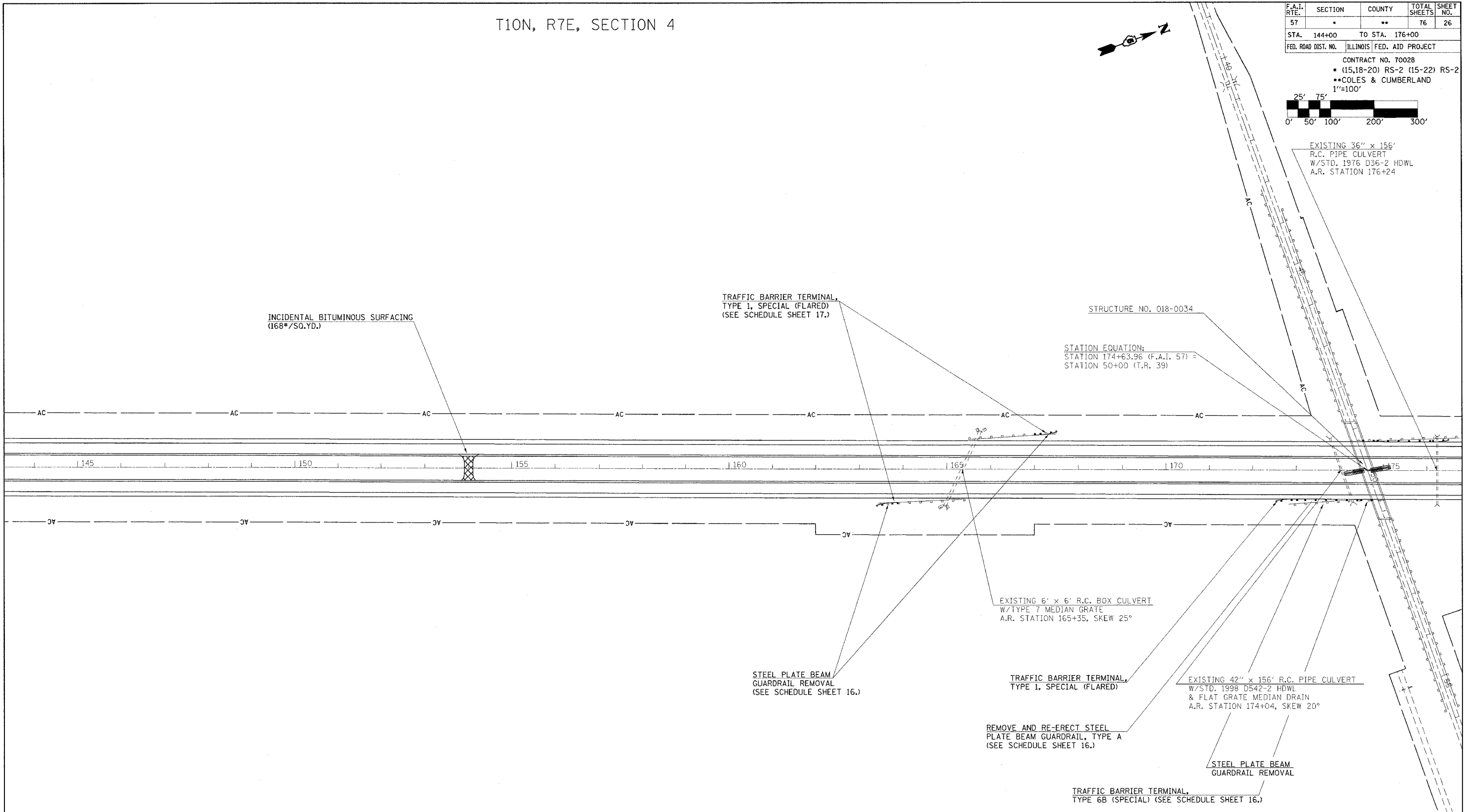

BITUMINOUS SURFACE REMOVAL, 1 1/2"

REVISIONS	
NAME	DATE

ILLINOIS DEPARTMENT OF TRANSPORTATION

SCALE: \_\_\_\_\_  
 DATE \_\_\_\_\_

DRAWN BY \_\_\_\_\_  
 CHECKED BY \_\_\_\_\_