

EXISTING I-57 WEATHER STATION AND WIRING SCHEMATIC

F.A.I. RTE.	SECTION	COUNTY	TOTAL SHEETS	SHEET NO.
57	*	**	76	63

• (15,18-20)RS-2 & (15-22)RS-2
 ** COLES & CUMBERLAND
 CONTRACT NO. 70028

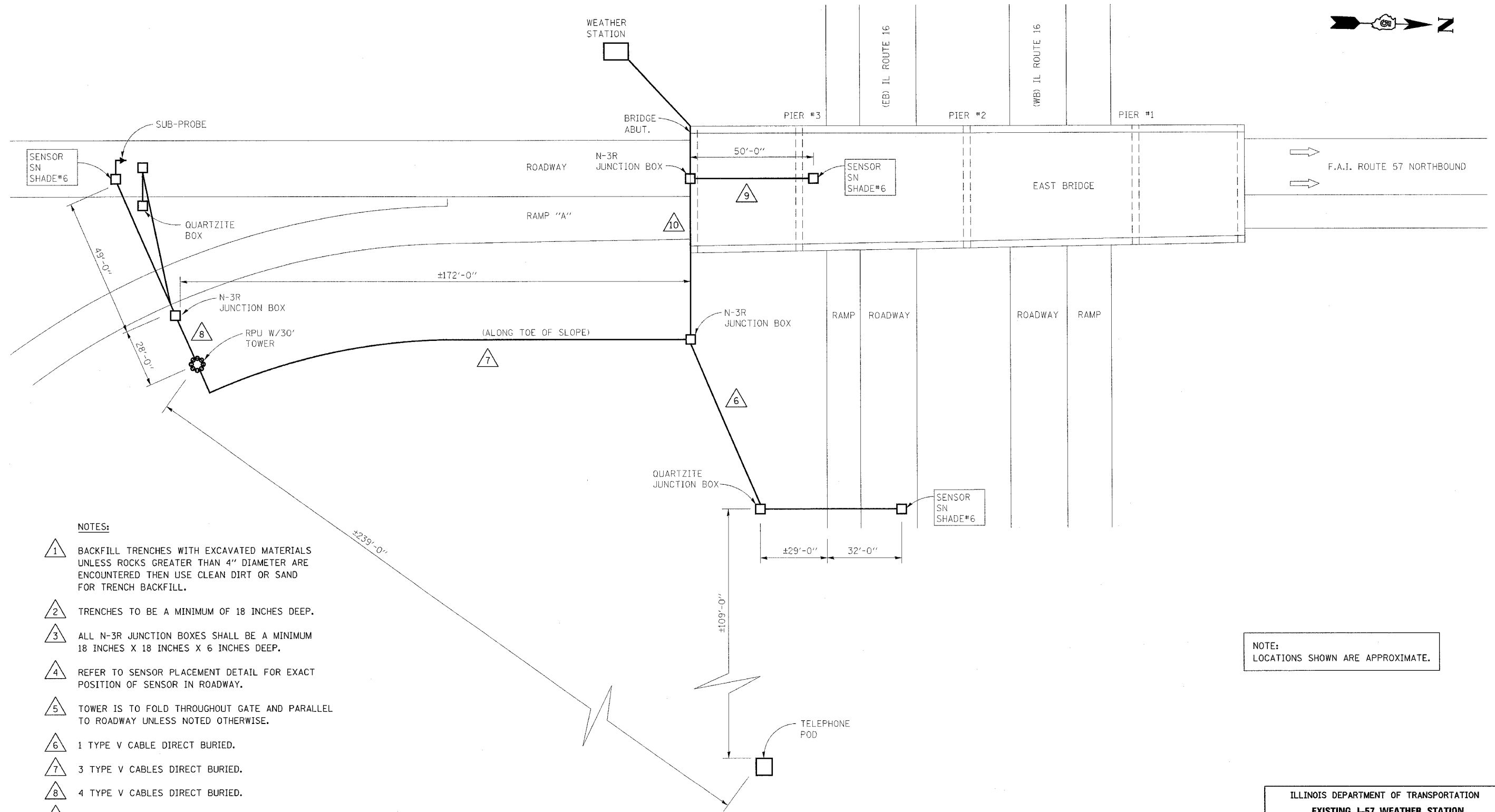
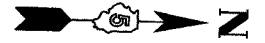

NOTES:

- 1 BACKFILL TRENCHES WITH EXCAVATED MATERIALS UNLESS ROCKS GREATER THAN 4" DIAMETER ARE ENCOUNTERED THEN USE CLEAN DIRT OR SAND FOR TRENCH BACKFILL.
- 2 TRENCHES TO BE A MINIMUM OF 18 INCHES DEEP.
- 3 ALL N-3R JUNCTION BOXES SHALL BE A MINIMUM 18 INCHES X 18 INCHES X 6 INCHES DEEP.
- 4 REFER TO SENSOR PLACEMENT DETAIL FOR EXACT POSITION OF SENSOR IN ROADWAY.
- 5 TOWER IS TO FOLD THROUGHOUT GATE AND PARALLEL TO ROADWAY UNLESS NOTED OTHERWISE.
- 6 1 TYPE V CABLE DIRECT BURIED.
- 7 3 TYPE V CABLES DIRECT BURIED.
- 8 4 TYPE V CABLES DIRECT BURIED.
- 9 1 TYPE II CABLE IN 1" GRC CONDUIT MOUNTED ON UNDERSIDE OF BRIDGE.
- 10 2 TYPE II CABLES IN 1" GRC CONDUIT MOUNTED ON BRIDGE ABUTMENT.

NOTE:
LOCATIONS SHOWN ARE APPROXIMATE.

ILLINOIS DEPARTMENT OF TRANSPORTATION
EXISTING I-57 WEATHER STATION AND WIRING SCHEMATIC
 F.A.I. ROUTE 57
 SECTION (15,18-20)RS-2 & (15-22)RS-2
 COLES & CUMBERLAND COUNTY

SCALE: DO NOT SCALE
 DATE: 10/13/04

DRAWN BY: CADD
 CHECKED BY: