

FAP NO.	SECTION	COUNTY	TOTAL SHEETS	SHEET NO.
586	60R-2, 37R-1	MADISON	502	63
STA. 584+00		TO STA. 590+00		
CONTRACT NO.: 76301				

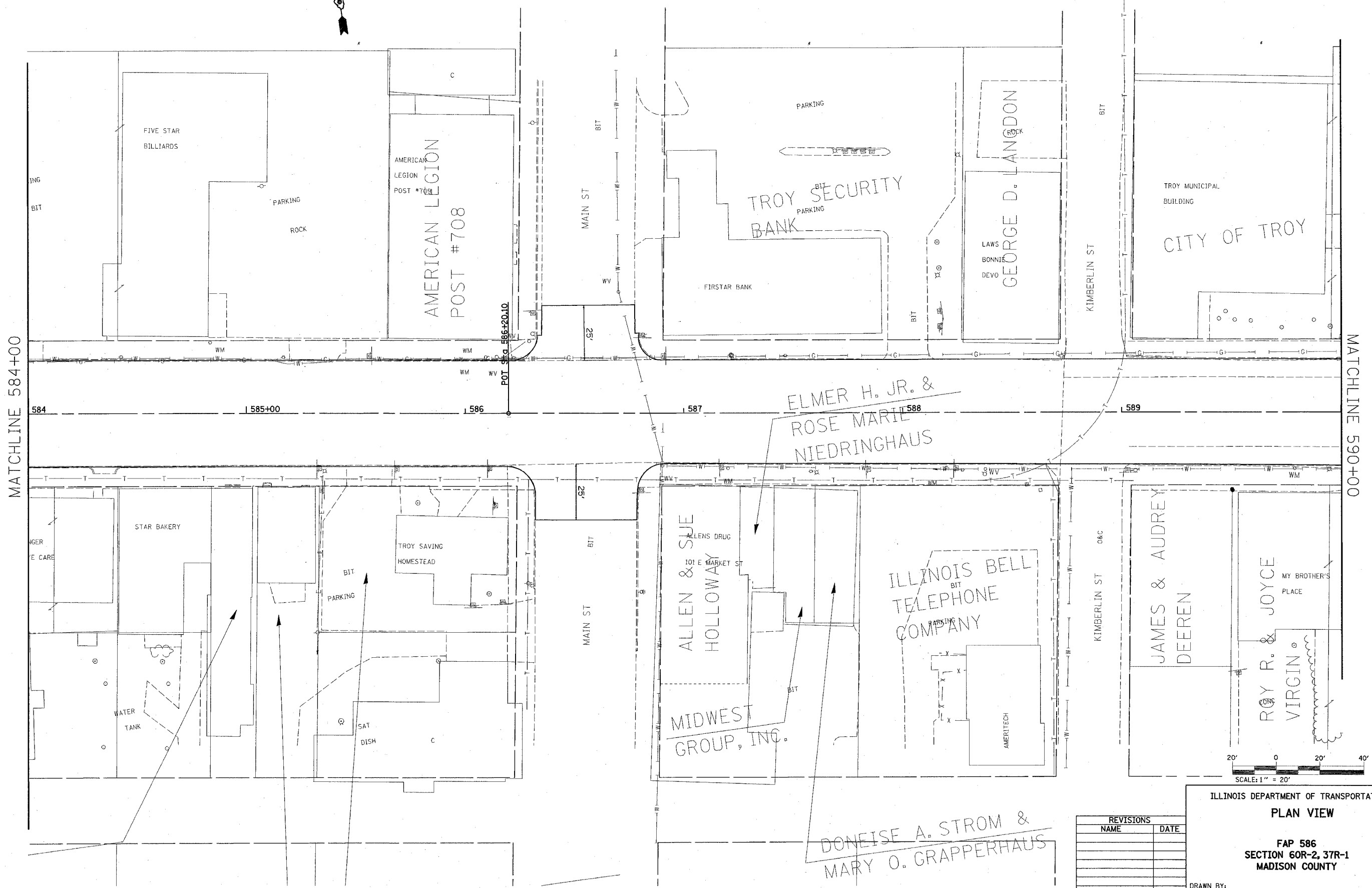

PLAN NO.	
NOTE BOOK NO.	
DATE	
BY	
CHECKED	
ALIGNED	
PLOTTED	
CADD FILE NAME	



ELMER H. JR. &
ROSE MARIE
NIEDRINGHAUS

DONEISE A. STROM &
MARY O. GRAPPERHAUS



REVISIONS	
NAME	DATE

ILLINOIS DEPARTMENT OF TRANSPORTATION
PLAN VIEW
 FAP 586
 SECTION 60R-2, 37R-1
 MADISON COUNTY
 DRAWN BY:

7/1/2004 11:01 AM 2004 8 204450 PM
 C:\pro\secta\60R-2,37R-1\plan\60R-2,37R-1.dgn LV1-63
 C:\pro\secta\60R-2,37R-1\plan\60R-2,37R-1.dgn LV1-63
 C:\pro\secta\60R-2,37R-1\plan\60R-2,37R-1.dgn LV1-63
 C:\pro\secta\60R-2,37R-1\plan\60R-2,37R-1.dgn LV1-63
 C:\pro\secta\60R-2,37R-1\plan\60R-2,37R-1.dgn LV1-63