

FAP ROUTE	SECTION	COUNTY	TOTAL SHEETS	SHEET NO.
586	60R-2, 37R-1	MADISON	502	86
STA. 716+00		TO STA. 719+45.59		
CONTRACT NO.: 76301				

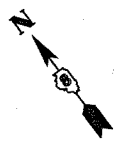

PI STA. = 718+18.73
 $\Delta = 49^\circ 05' 22''$ (RT)
 $D = 44^\circ 43' 39''$
 $R = 128.10'$
 $T = 58.50'$
 $L = 109.75'$
 $E = 12.73'$
 $e = \text{---}$
 $T.R. = \text{---}$
 $S.E. RUN = \text{---}$
 $P.C. STA = 717+60.23$
 $P.T. STA = 718+69.98$

PLAN	REVISED	DATE
NOTE BOOK	ALIGNED	
	CHECKED	
	FILE NAME	

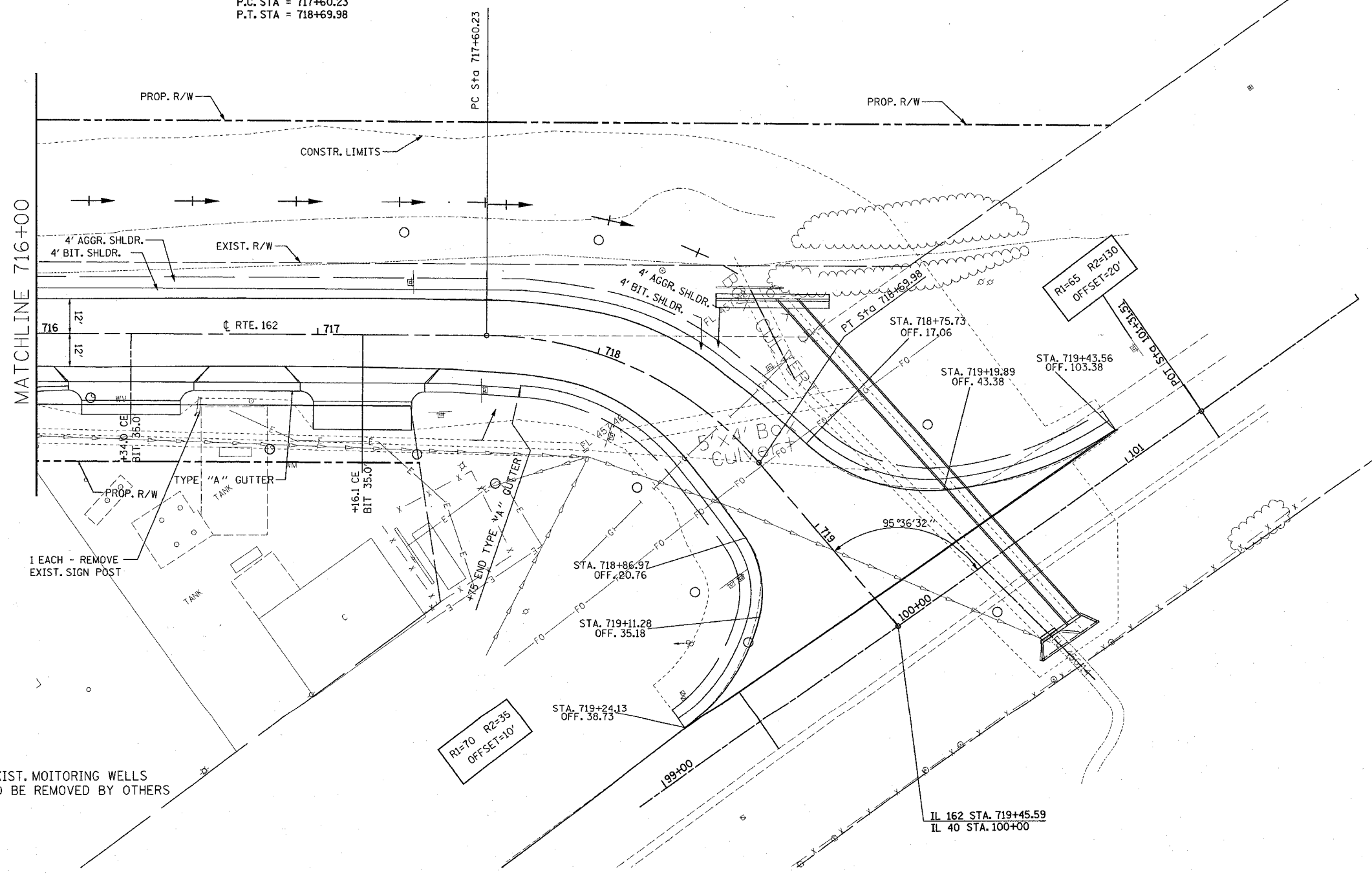

7/1/2004
 Thursday, July 01, 2004 2:04:51 PM
 C:\p04\mca\work\118\013\049 - LV24-6-6.1214-1517.222-27-2037-48.44.46-48.56-53.57-59
 C:\p04\mca\work\118\013\049 - LV24-6-6.1214-1517.222-27-2037-48.44.46-48.56-53.57-59
 C:\p04\mca\work\118\013\049 - LV24-6-6.1214-1517.222-27-2037-48.44.46-48.56-53.57-59
 C:\p04\mca\work\118\013\049 - LV24-6-6.1214-1517.222-27-2037-48.44.46-48.56-53.57-59
 C:\p04\mca\work\118\013\049 - LV24-6-6.1214-1517.222-27-2037-48.44.46-48.56-53.57-59
 C:\p04\mca\work\118\013\049 - LV24-6-6.1214-1517.222-27-2037-48.44.46-48.56-53.57-59



ILLINOIS DEPARTMENT OF TRANSPORTATION
PLAN VIEW
 FAP 586
 SECTION 60R-2, 37R-1
 MADISON COUNTY

REVISIONS	
NAME	DATE

DRAWN BY:
 PLOT DATE: Thursday July 01, 2004 @ 2:04:51 PM

○ EXIST. MONITORING WELLS
 TO BE REMOVED BY OTHERS

1 EACH - REMOVE
 EXIST. SIGN POST