

FAP ROUTE	SECTION	COUNTY	TOTAL SHEETS	SHEET NO.
586	60R-2, 37R-1	MADISON	502	132
STA. 506+00				TO STA. 512+00
EXISTING CONDITIONS:				76301

NO.	DATE	BY

7/2/2004
 C:\p\projects\586\586_2380\586_2380.dwg
 C:\p\projects\586\586_2380\586_2380.dwg
 C:\p\projects\586\586_2380\586_2380.dwg
 C:\p\projects\586\586_2380\586_2380.dwg
 C:\p\projects\586\586_2380\586_2380.dwg
 C:\p\projects\586\586_2380\586_2380.dwg

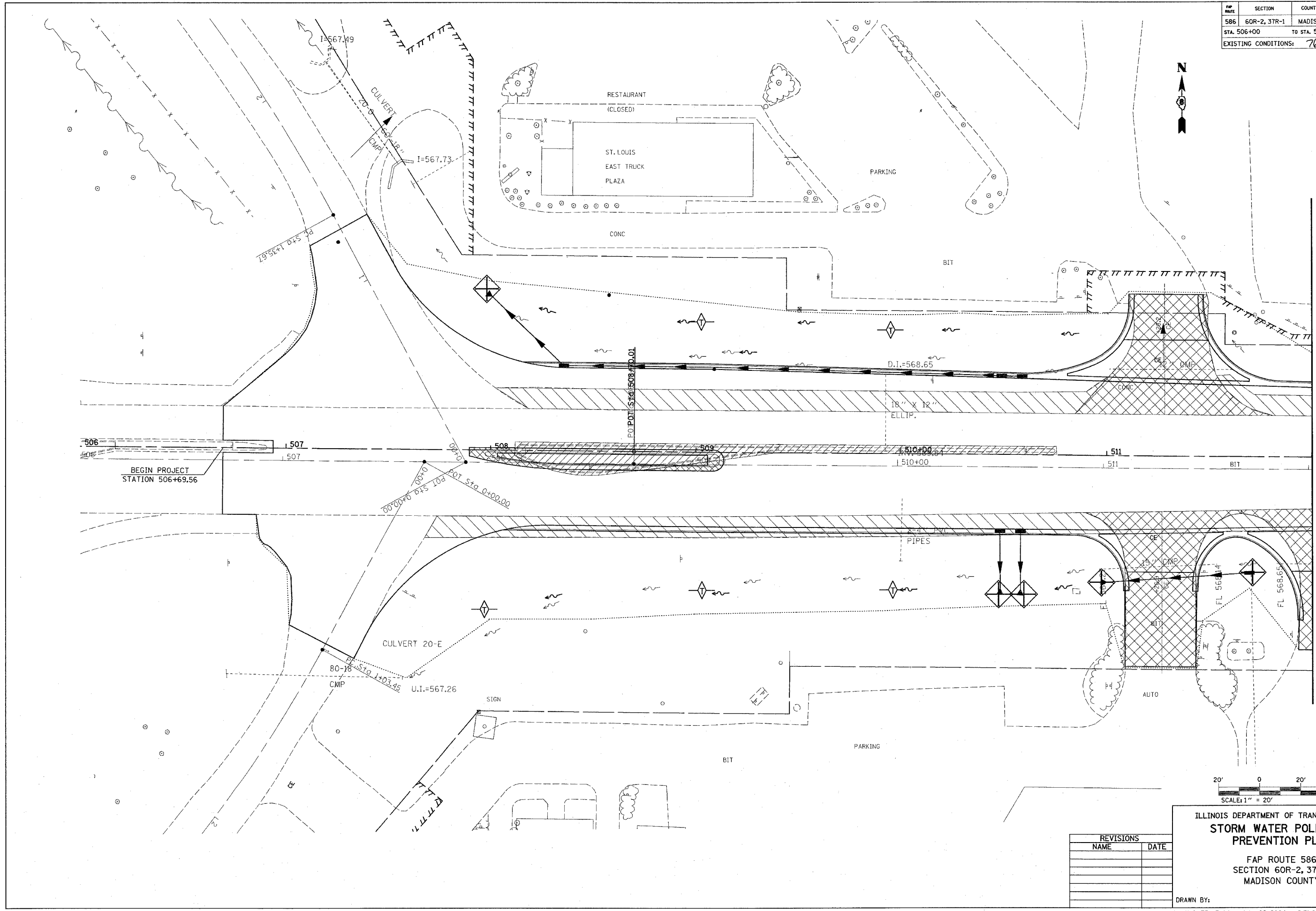

REVISIONS		
NO.	NAME	DATE

ILLINOIS DEPARTMENT OF TRANSPORTATION
STORM WATER POLLUTION PREVENTION PLAN
 FAP ROUTE 586
 SECTION 60R-2, 37R-1
 MADISON COUNTY
 DRAWN BY:
 PLOT DATE: Friday July 02, 2004 @ 8:31:00 AM