

**LEGEND**

- EXISTING CENTERLINE
- EXISTING RIGHT OF WAY LINE
- EXISTING EASEMENT LINE
- PROPOSED CENTERLINE
- PROPOSED RIGHT OF WAY LINE
- PROPOSED TEMPORARY EASEMENT LINE
- PROPOSED PERMANENT EASEMENT LINE
- SECTION LINE
- QUARTER SECTION LINE
- QUARTER SECTION LINE
- PROPERTY (DEED) LINE
- APPARENT PROPERTY LINE
- MEASURED DIMENSION
- COMPUTED DIMENSION
- RECORDED DIMENSION
- FOUND IRON PIPE OR IRON ROD
- SET 3/8 INCH IRON ROD
- PERMANENT SURVEY MONUMENT, I.D.O.T. STD. 2135 (TO BE SET BY OTHERS)
- CUT CROSS FOUND OR SET
- SAME OWNERSHIP

- STAKING OF PROPOSED RIGHT OF WAY. SET 3/8 INCH METAL ROD WITH DIVISION OF HIGHWAY SURVEY MARKER TO MONUMENT THE POSITION SHOWN, IDENTIFIED BY INSCRIPTION DATA AND SURVEYORS REGISTRATION NUMBER.
- M STAKING OF PROPOSED RIGHT OF WAY IN CULTIVATED AREAS. SET 3/8 INCH METAL ROD WITH DIVISION OF HIGHWAY SURVEY MARKER 20 INCHES BELOW GROUND SURFACE TO MONUMENT THE POSITION SHOWN, IDENTIFIED BY INSCRIPTION DATA AND SURVEYORS REGISTRATION NUMBER.

STATE OF ILLINOIS )  
COUNTY OF ) SS

THIS IS TO CERTIFY THAT I, THOMAS M. DRONE, AN ILLINOIS PROFESSIONAL LAND SURVEYOR, HAS SURVEYED THE PLAT OF HIGHWAYS SHOWN HEREON IN SECTION 10, TOWNSHIP 3 NORTH, RANGE 7 WEST, OF THE THIRD PRINCIPAL MERIDIAN, MADISON COUNTY, THAT THE SURVEY IS TRUE AND COMPLETE AS SHOWN TO THE BEST OF MY KNOWLEDGE AND BELIEF, THAT THE PLAT CORRECTLY REPRESENTS SAID SURVEY, THAT ALL MONUMENTS FOUND AND ESTABLISHED ARE OF PERMANENT QUALITY AND OCCUPY THE POSITIONS SHOWN THEREON AND THAT THE MONUMENTS ARE SUFFICIENT TO ENABLE THE SURVEY TO BE RETRACED. MADE FOR THE DEPARTMENT OF TRANSPORTATION, STATE OF ILLINOIS.

DATED \_\_\_\_\_  
THOMAS M. DRONE, PLS #2273

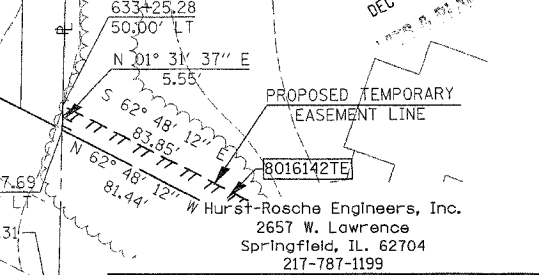

PARCEL NO.	OWNER	TOTAL HOLDING	R.O.W. REQUIRED	PREVIOUSLY DEDICATED	REMAINDER	EASEMENTS		EASEMENT PURPOSE	PERMANENT TAX NUMBER	PROPERTY ACQUIRED BY
						TEMP	PERM			
8016135	EVANGELICAL FRIEDENS GEMEINDE TITLE REPORT NO. MA-2393.0	13.5924 AC				A=0.0300 AC 1308 SF B=0.0225 AC 980 SF		ENTRANCE CONSTRUCTION	09-1-22-10-03-301-032	
8016136	GLADYS E. BLISS TITLE REPORT NO. MA-2390.0	0.7507 AC				0.0205 AC 895 SF		SHAPING & GRADING	09-2-22-10-03-301-021	
8016137	DOUGLAS G. CURNAYN AND STARLETT A. CURNAYN TITLE REPORT NO. MA-2389.0	0.1794 AC				0.0080 AC 347 SF		SHAPING & GRADING	09-1-22-10-03-301-023	
8016138	LINDA LUNA TITLE REPORT NO. MA-2381.0	0.1608 AC				0.0123 AC 537 SF		SHAPING & GRADING	09-1-22-10-03-301-024	
8016139	GARY L. JACKSON, Sr. AND JANICE G. JACKSON, HUSBAND AND WIFE AS JOINT TENANTS TITLE REPORT NO. MA-2380.0	0.2557 AC				0.0177 AC 772 SF		SHAPING & GRADING	09-1-22-10-03-301-025.001	
8016191	KENDALL B. STOUT TITLE REPORT NO. MA-	0.2411 AC				0.0030 AC 132 SF		SHAPING & GRADING	09-2-22-10-03-301-087	

COORDINATES SHOWN HEREON ARE BASED ON SURVEY CONTROL DATA AS PROVIDED BY THE ILLINOIS DEPARTMENT OF TRANSPORTATION.

STATION	OFFSET	NORTH	EAST
630+18.64	0.00' RT	749067.7582	2380888.1471
631+16.78	444.05' LT	749417.8652	2381178.3887

ILLINOIS DEPARTMENT OF TRANSPORTATION  
**PLAT OF HIGHWAYS**  
FAP ROUTE 586 (IL 162)  
SECTION 60R-2  
MADISON COUNTY  
JOB NO. R-98-016-00  
STATION 628+00 TO STATION 633+00

SCALE: 1" = 20'

SHEET 7 OF

ILLINOIS DEPARTMENT OF TRANSPORTATION  
DIVISION OF HIGHWAYS/DISTRICT 8  
1102 EASTPORT PLAZA DRIVE  
COLLINGSVILLE, ILLINOIS 62234-6198