

FAP NO.	SECTION	COUNTY	TOTAL SHEETS	SHEET NO.
596	60R-2,37R-1	MADISON	502	219B
STA.	TO STA.		EXISTING CONDITIONS:	
			76301	

PLAN NO.	DATE
BY:	
CHECKED:	
APPROVED:	
CADD FILE NAME:	
PROJECT:	
SHEET:	
DATE:	
SCALE:	

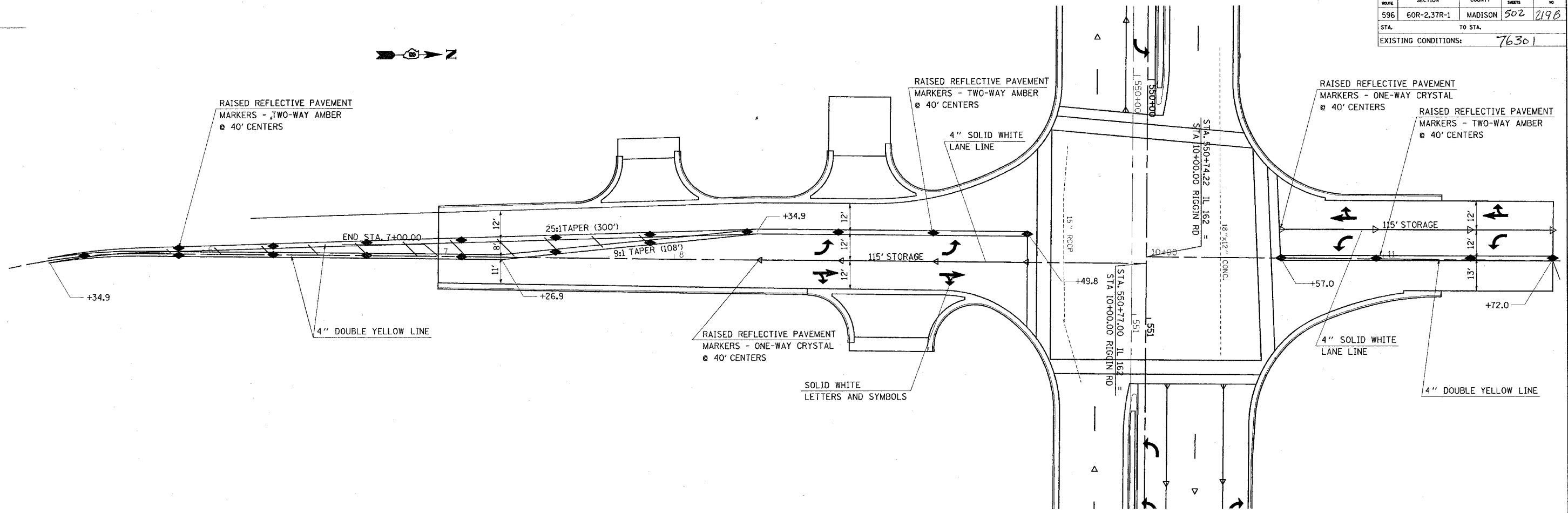

ILLINOIS DEPARTMENT OF TRANSPORTATION
PAVEMENT MARKING

FAP ROUTE 586
SECTION 60R-2,37R-1
MADISON COUNTY

REVISIONS	
NAME	DATE

DRAWN BY:
PLOT DATE: Friday July 02, 2004 @ 9:38:54 AM

7/2/2004
F:\p\72004 e 93854.dwg
D:\projects\72004\pavement\72004_219B.dwg
D:\projects\72004\pavement\72004_219B.dwg
D:\projects\72004\pavement\72004_219B.dwg
D:\projects\72004\pavement\72004_219B.dwg
D:\projects\72004\pavement\72004_219B.dwg