

F.A. RTE.	SECTION	COUNTY	TOTAL SHEETS	SHEET NO.
586	60R-2, 37R-1	MADISON	502	413
STA.		TO STA.		
CONTRACT NO. 76301				

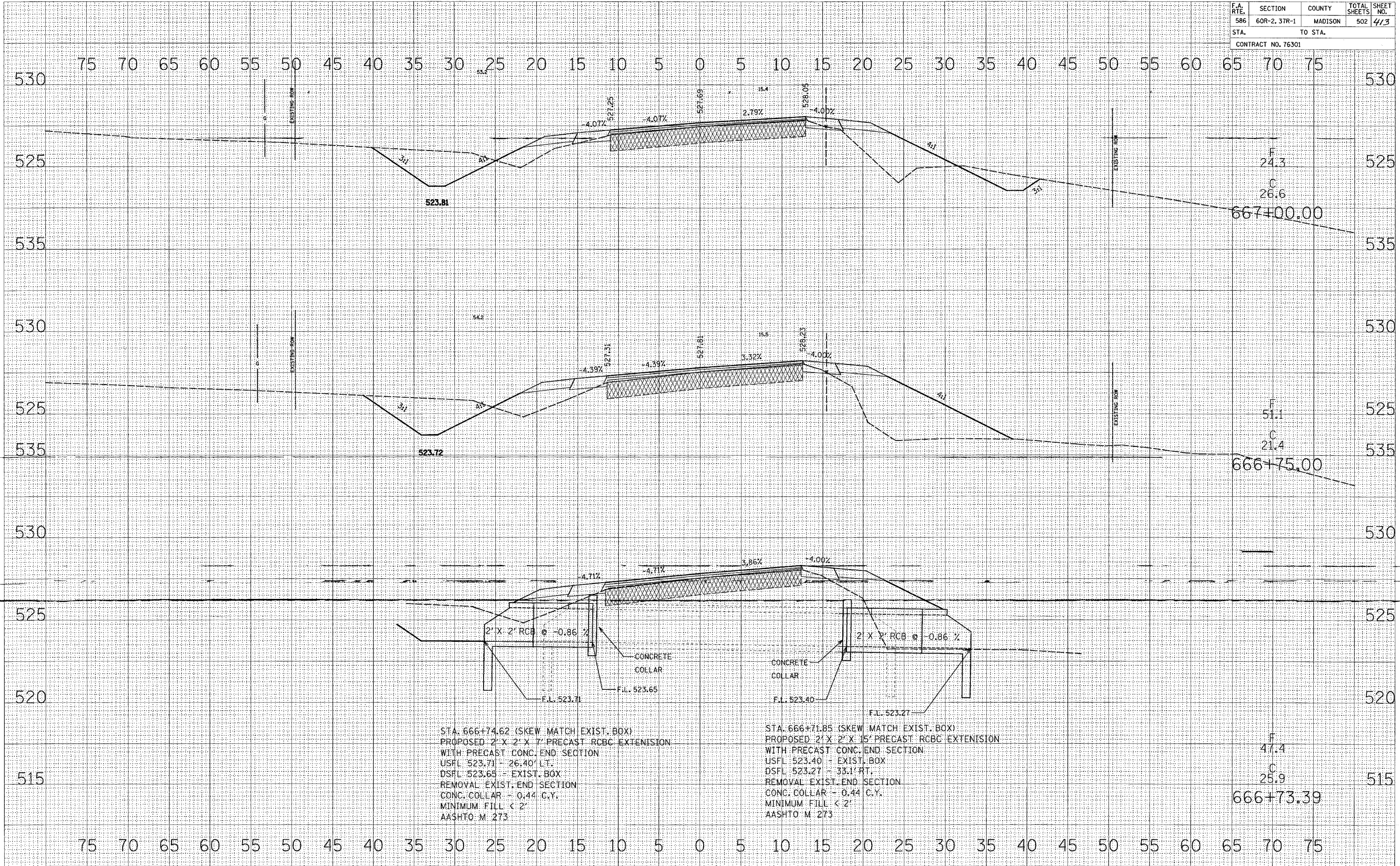

STA. 666+74.62 (SKEW MATCH EXIST. BOX)
 PROPOSED 2' X 2' X 7' PRECAST RCBC EXTENSION
 WITH PRECAST CONC. END SECTION
 USFL 523.71 - 26.40' LT.
 DSFL 523.65 - EXIST. BOX
 REMOVAL EXIST. END SECTION
 CONC. COLLAR - 0.44 C.Y.
 MINIMUM FILL < 2'
 AASHTO M 273

STA. 666+71.85 (SKEW MATCH EXIST. BOX)
 PROPOSED 2' X 2' X 15' PRECAST RCBC EXTENSION
 WITH PRECAST CONC. END SECTION
 USFL 523.40 - EXIST. BOX
 DSFL 523.27 - 33.1' RT.
 REMOVAL EXIST. END SECTION
 CONC. COLLAR - 0.44 C.Y.
 MINIMUM FILL < 2'
 AASHTO M 273

F
24.3
C
26.6
667+00.00

F
51.1
C
21.4
666+75.00

F
47.4
C
25.9
666+73.39

DATE	
BY	
NO.	
ORIGINAL SURVEY	
PLOTTED	
TEMPLATE	
NOTE BOOK	
AREAS CHECKED	

DATE	
BY	
NO.	
ORIGINAL SURVEY	
PLOTTED	
TEMPLATE	
NOTE BOOK	
AREAS CHECKED	