

**CROSS SECTION**  
(Looking North)

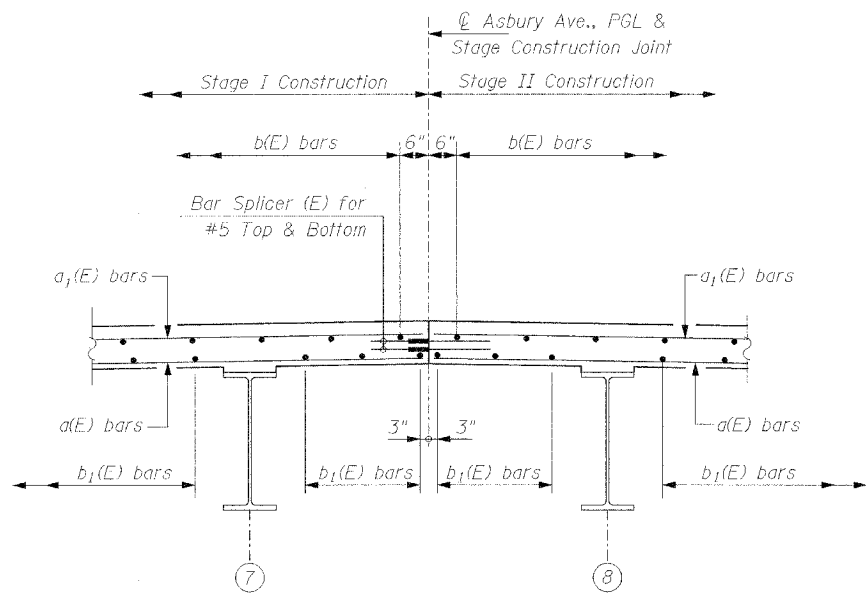

**DETAIL "A"**

Notes:  
 See Sheet S-9 for superstructure details and Bill of Material.  
 Reinforcement bars designated (E) shall be epoxy coated.  
 Bars indicated thus 20 x 3-#5 etc. indicates 20 lines of bars with 3 lengths per line.  
 See Sheet S-9 for parapet reinforcement and Parapet Joint Details.

REVISIONS	
NAME	DATE

**Clorba Group, Inc.**  
 CONSULTING ENGINEERS  
 5911 NORTH CUMBERLAND AVENUE • CHICAGO, ILLINOIS 60630 • (773) 775-4900

**CITY OF EVANSTON, ILLINOIS**  
 SUPERSTRUCTURE SECTION & DETAILS  
 ASBURY AVENUE OVER CTA YELLOW LINE  
 SECTION 00-00215-00-BR  
 COOK COUNTY  
 STA. 103+20.00  
 STRUCTURE NO. 016-6959

SCALE: NONE  
 DATE: OCTOBER 2004  
 FILE: 3212

DRAWN BY: IMG  
 CHECKED BY: SCD