

F.A.U. RTE.	SECTION	COUNTY	TOTAL SHEETS	SHEET NO.
	02-00048-00-BR	COOK	27	1
STA. TO STA.				
FED. ROAD DIST. NO. 7 ILLINOIS		FED. AID PROJECT		
CONTRACT NO. 83779		D-91-098-03		

INDEX OF SHEETS

1	COVER SHEET
2	GENERAL NOTES AND LISTING OF HIGHWAY STANDARDS
3-5	SUMMARY OF QUANTITIES
6	EXISTING TYPICAL SECTIONS
7	PROPOSED TYPICAL SECTIONS
8-10	PLAN AND PROFILE
11-13	DETOUR SIGNING PLAN
14-15	LANDSCAPING AND EROSION CONTROL DETAILS
ARTHUR AVENUE CULVERT PLANS	
16	GENERAL PLAN
17	CULVERT PLAN & SECTIONS
18	WINGWALL DETAILS
19	BORING LOGS
PRATT BOULEVARD CULVERT PLANS	
20	GENERAL PLAN
21	CULVERT PLAN & SECTIONS
22	WINGWALL DETAILS
23	BORING LOGS
LUNT AVENUE CULVERT PLANS	
24	GENERAL PLAN
25	CULVERT PLAN & SECTIONS
26	WINGWALL DETAILS
27	BORING LOGS

**STATE OF ILLINOIS
DEPARTMENT OF TRANSPORTATION
DIVISION OF HIGHWAYS**

**PROPOSED
HIGHWAY PLANS**

**RECONSTRUCTION OF THE ARTHUR AVENUE, PRATT BOULEVARD
AND LUNT AVENUE CULVERTS OVER WILLOW CREEK
SECTION NO. 02-00048-00-BR
PROJECT NO. BROS-00D1 (626)
CULVERT REMOVAL AND REPLACEMENT
COOK COUNTY
JOB NO. C-91-098-03**

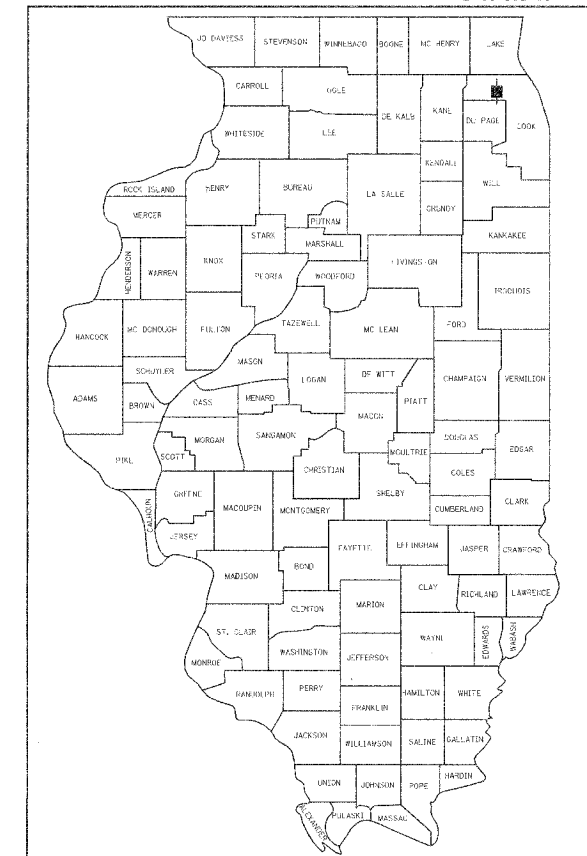

LOCATION OF SECTION INDICATED THIS: - [shaded area]

**STATE OF ILLINOIS
DEPARTMENT OF TRANSPORTATION
DIVISION OF HIGHWAYS**

APPROVED October 27 2004

Alan J. Bordin
**ELK GROVE VILLAGE - DIRECTOR OF ENGINEERING
AND COMMUNITY DEVELOPMENT**

APPROVED _____ 2004

ENGINEER OF LOCAL ROADS AND STREETS

APPROVED November 10 2004

Dina O'Keefe
DISTRICT ENGINEER

**PRINTED BY THE AUTHORITY
OF THE STATE OF ILLINOIS**

Robert L. Peters 10/27/04
TRANSYSTEMS CORPORATION
ROBERT L. PETERS, P.E., S.E.
NO. 081-04697
EXP. DATE 11/30/06

Scott D. Czaplacki 10-27-04
TRANSYSTEMS CORPORATION
SCOTT D. CZAPLICKI, P.E.
NO. 062-053236
EXP. DATE 11/30/05

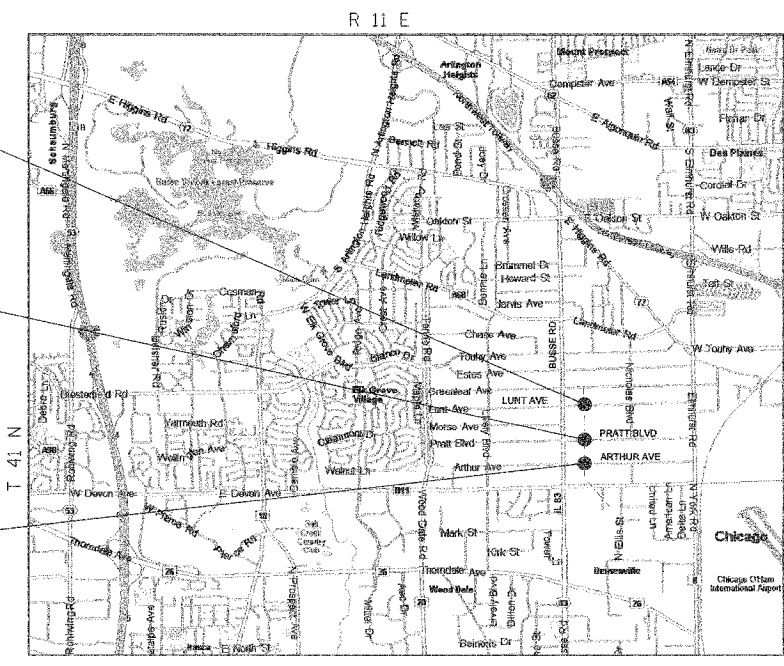

LOCATION MAP

LUNT AVENUE = 60 FEET (0.011 MILES)
PRATT BOULEVARD = 62 FEET (0.012 MILES)
ARTHUR AVENUE = 60 FEET (0.011 MILES)
TOTAL NET/GROSS LENGTH = 182 FEET (0.034 MILES)

PROJECT LOCATION
S/N 016-7853, STATION 18+00.83
LUNT AVENUE OVER WILLOW CREEK
BEGIN STATION 17+70
END STATION 18+30

PROJECT LOCATION
S/N 016-7852, STATION 38+01.07
PRATT BOULEVARD OVER WILLOW CREEK
BEGIN STATION 37+70
END STATION 38+32

PROJECT LOCATION
S/N 016-7851, STATION 58+00.37
ARTHUR AVENUE OVER WILLOW CREEK
BEGIN STATION 57+70
END STATION 58+30

PROJECT LOCATED IN:
ELK GROVE VILLAGE

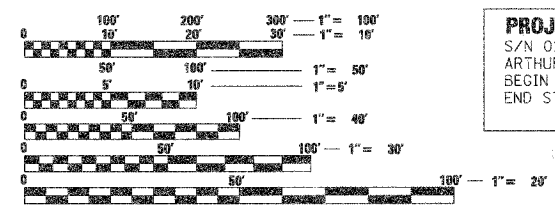

FULL SIZE PLANS HAVE BEEN PREPARED USING STANDARD ENGINEERING SCALES. REDUCED SIZED PLANS WILL NOT CONFORM TO STANDARD SCALES. IN MAKING MEASUREMENTS ON REDUCED PLANS, THE ABOVE SCALES MAY BE USED.

**J.U.L.I.E.
JOINT UTILITY LOCATION INFORMATION FOR EXCAVATION
1-800-892-0123**

CONTRACT NO. 83779

IDOT FEDERAL AID DESIGN ENGINEER
 MAZHAR KHAN (847) 705-4179
 CONSULTANT
 TRANSYSTEMS CORPORATION (847) 605-9800
 1051 PERIMETER DRIVE, SCHALLMBURG, IL 60173