

FAS ROUTE NO.	SEC	COUNTY	TOTAL SHEETS	SHEET NO
-	*	LEE	23	8

ILLINOIS PROJECT TE-D2(115)

* 01-P4000-00-BT

NOTE: DECORATIVE LIGHT POLES, FIXTURES AND ELECTRIC CABLE SHALL BE INSTALLED BY OTHERS. CONTRACTOR SHALL VERIFY BOLT PATTERN IN LIGHT POLE FOUNDATION WITH THE PROJECT ENGINEER.

SEE SHEET 14 FOR TOP OF RETAINING WALL ELEVATIONS.

PI Sta = 108+87.90
 N = 257.81
 E = 319.97
 I = 07°35'40"L
 CIRCULAR
 Da = 38°11'50"
 Dc = 38°56'33"
 T = 9.96
 R = 150.00
 L = 19.88
 C = 19.87
 E = 0.33
 M = 0.33

PI Sta = 109+98.59
 N = 272.35
 E = 429.72
 I = 05°24'00"R
 CIRCULAR
 Da = 09°52'23"
 Dc = 09°53'07"
 T = 27.37
 R = 580.32
 L = 54.70
 C = 54.67
 E = 0.64
 M = 0.64

PI Sta = 110+48.92
 N = 273.99
 E = 480.07
 I = 13°10'09"L
 CIRCULAR
 Da = 28°44'40"
 Dc = 29°03'17"
 T = 23.01
 R = 199.33
 L = 45.82
 C = 45.71
 E = 1.32
 M = 1.31

PI Sta = 110+91.68
 N = 285.13
 E = 521.56
 I = 11°23'34"R
 CIRCULAR
 Da = 28°38'52"
 Dc = 28°57'18"
 T = 19.95
 R = 200.00
 L = 39.77
 C = 39.70
 E = 0.99
 M = 0.99

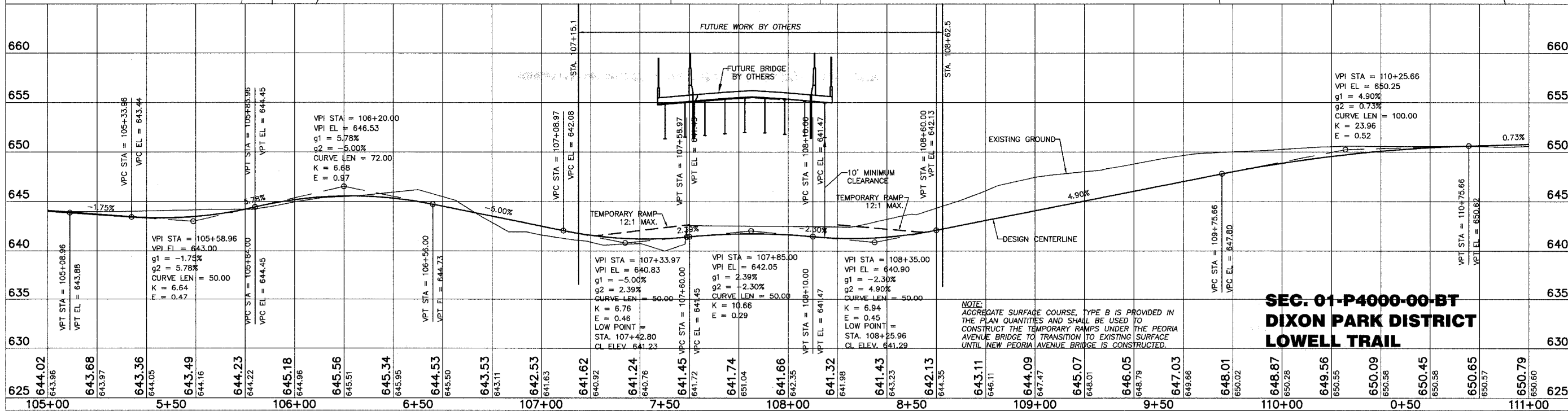
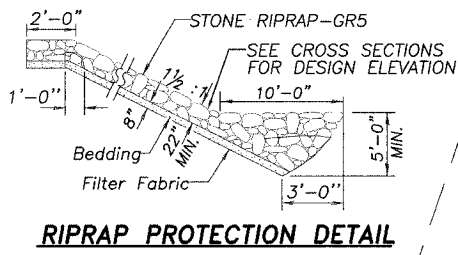
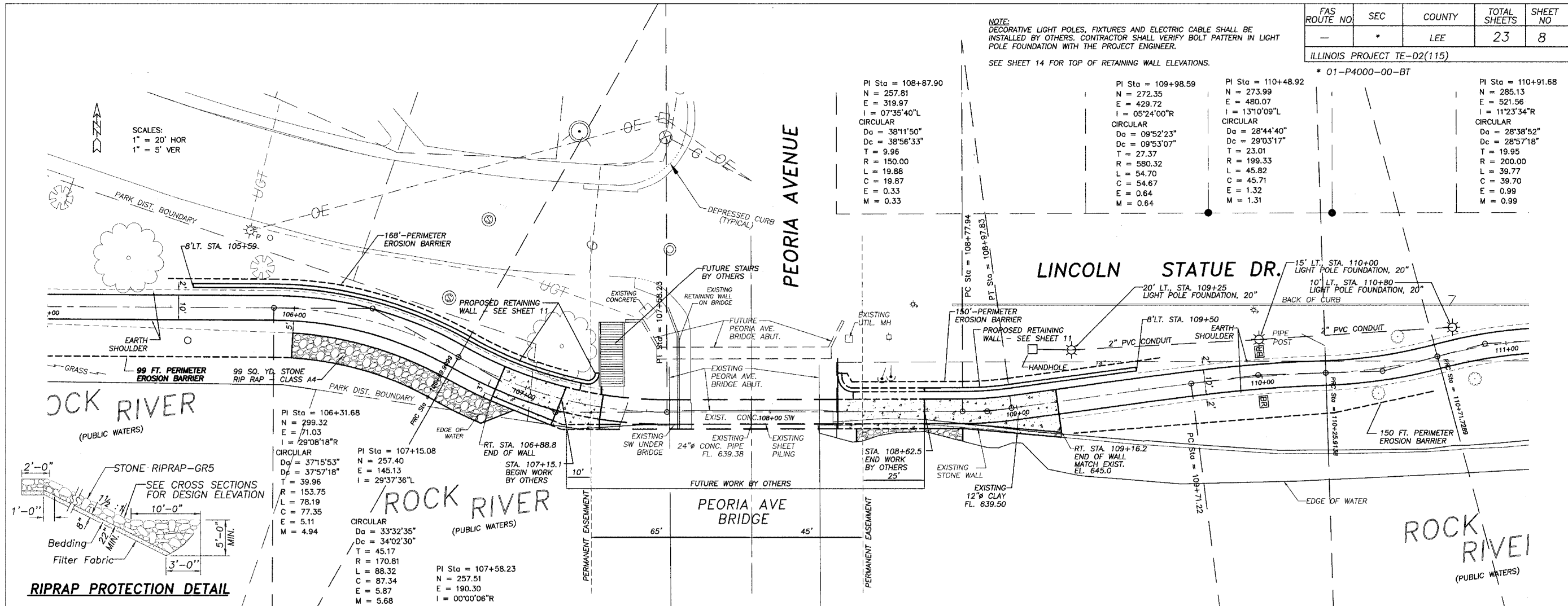

**SEC. 01-P4000-00-BT
 DIXON PARK DISTRICT
 LOWELL TRAIL**

NOTE: AGGREGATE SURFACE COURSE, TYPE B IS PROVIDED IN THE PLAN QUANTITIES AND SHALL BE USED TO CONSTRUCT THE TEMPORARY RAMP UNDER THE PEORIA AVENUE BRIDGE TO TRANSITION TO EXISTING SURFACE UNTIL NEW PEORIA AVENUE BRIDGE IS CONSTRUCTED.

698 TIMBER CREEK ROAD - P.O. BOX 466 - DIXON, IL 61021 - 815-288-2261
 28 E. MARION - SUITE 3 - PRINCETON, IL 61356 - 815-879-4731
 1778 WEST STATE ST. - STYONMIRE, IL 60178 - 815-865-5008
 804 FREEDPORT RD. - STERLING, IL 61081 - (815) 626-4428
 E-MAIL: info@wendler.com

WENDLER ENGINEERING SERVICES, INC.
 Structural & Civil Engineers—Land Surveying—Environmental Services
 Illinois Professional Design Firm No. 184-000648

1908 - 2003
 35th Anniversary
 Planning Life...
 - And Really!