

RTE.	SECTION	COUNTY	TOTAL SHEETS	SHEET NO.
FAI80	(50-2)HBR	LA SALLE	460	42
STA. 663+50		TO STA. 676+50		
FED. ROAD DIST. NO.		ILLINOIS	FED. AID PROJECT	

CONTRACT NO. 86603

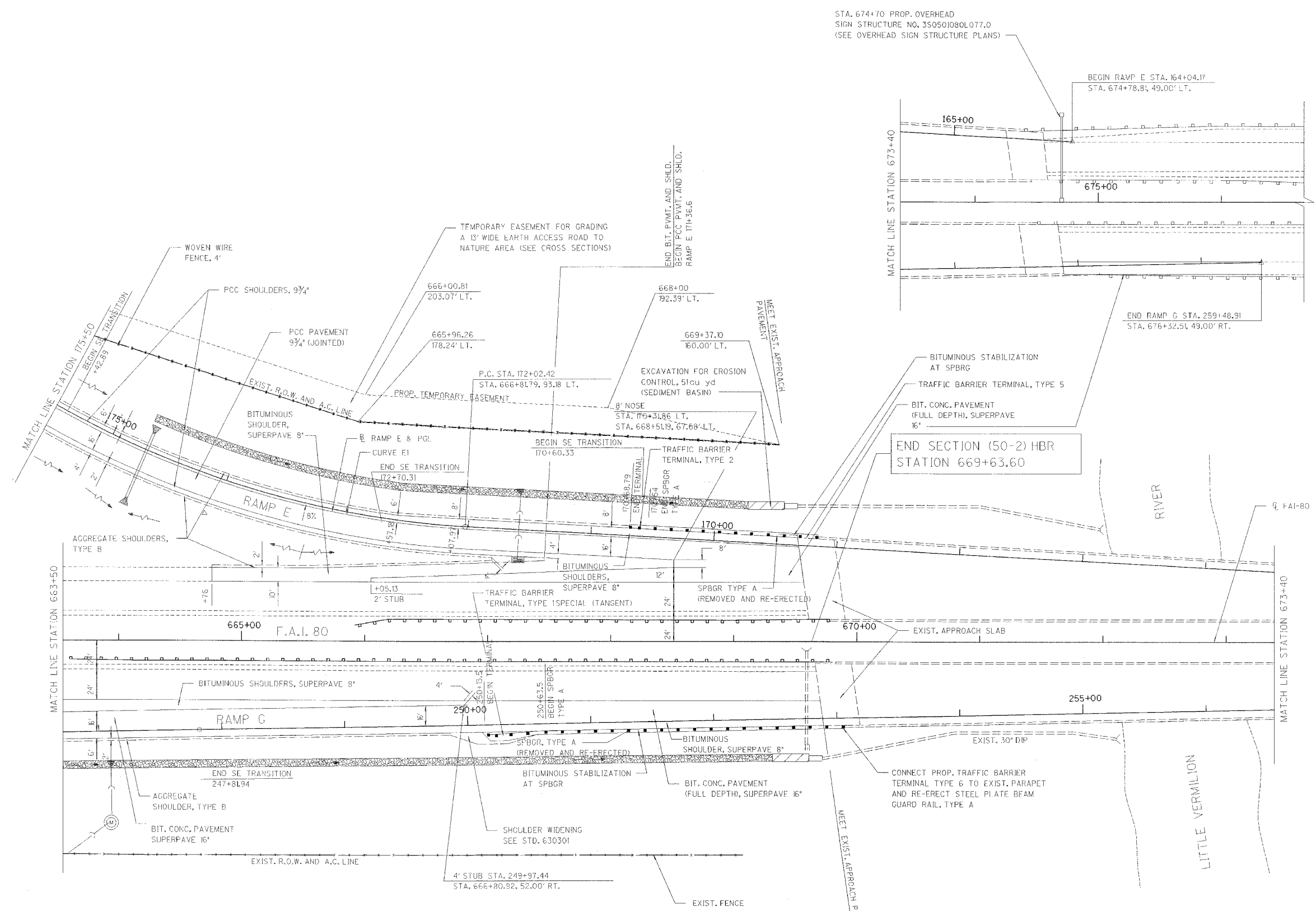

STA. 674+70 PROP. OVERHEAD  
SIGN STRUCTURE NO. 350501080L077.0  
(SEE OVERHEAD SIGN STRUCTURE PLANS)

BEGIN RAMP E STA. 164+04.17  
STA. 674+78.8; 49.00' LT.

END RAMP G STA. 259+48.91  
STA. 676+32.51, 49.00' RT.

END SECTION (50-2) HBR  
STATION 669+63.60

MATCH LINE STATION 673+40

MATCH LINE STATION 663+50

MATCH LINE STATION 673+40

ILLINOIS DEPARTMENT OF TRANSPORTATION

ROADWAY PLAN

F.A.I. 80 AT ILLINOIS ROUTE 351  
STATION 663+50 TO STATION 676+50

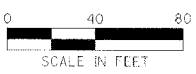

DATE: 09/04  
DRAWN BY: JJK  
CHECKED BY: MTD

REVISIONS	NAME	DATE