

RTE.	SECTION	COUNTY	TOTAL SHEETS	SHEET NO.
FAI80	150-21HBR	LA SALLE	460	50
STA. 0+00	TO STA. 11+68.78			
FED. ROAD DIST. NO.	ILLINOIS	FED. AID PROJECT		

TEMPORARY RAMP H PROFILE

CONTRACT NO. 86603

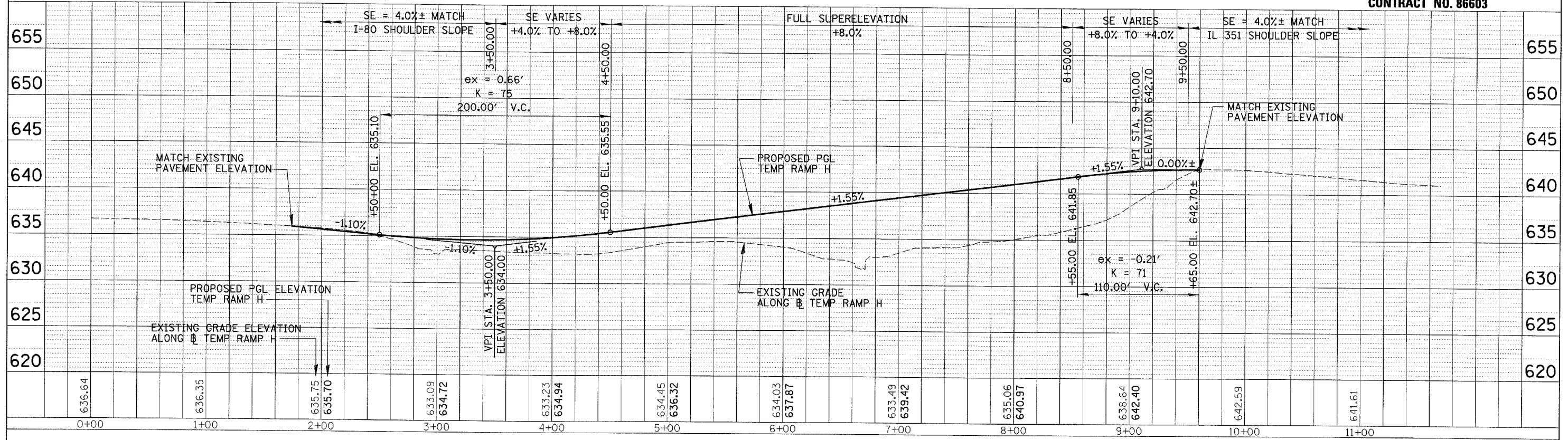

DATE	
BY	
REVISIONS	
PLANNED	
ALIGNED	
DESIGNED	
NOTED	
FILED	
NO.	

DATE	
BY	
REVISIONS	
PLANNED	
ALIGNED	
DESIGNED	
NOTED	
FILED	
NO.	

REVISIONS	NAME	DATE

ILLINOIS DEPARTMENT OF TRANSPORTATION  
**TEMPORARY RAMP H PROFILE**  
 F.A.I. 80 @ ILLINOIS ROUTE 351

0 40 80  
 SCALE IN FEET

DATE: 09/04  
 DRAWN BY: MES  
 CHECKED BY: MTD