

|                     |           |                           |              |           |
|---------------------|-----------|---------------------------|--------------|-----------|
| ROUTE               | SECTION   | COUNTY                    | TOTAL SHEETS | SHEET NO. |
| FAI 80              | (50-2)HBR | LA SALLE                  | 440          | 50        |
| STA. 643+00         |           | TO STA. 653+75            |              |           |
| FED. ROAD DIST. NO. |           | ILLINOIS FED. AID PROJECT |              |           |

**CONTRACT NO. 86603**

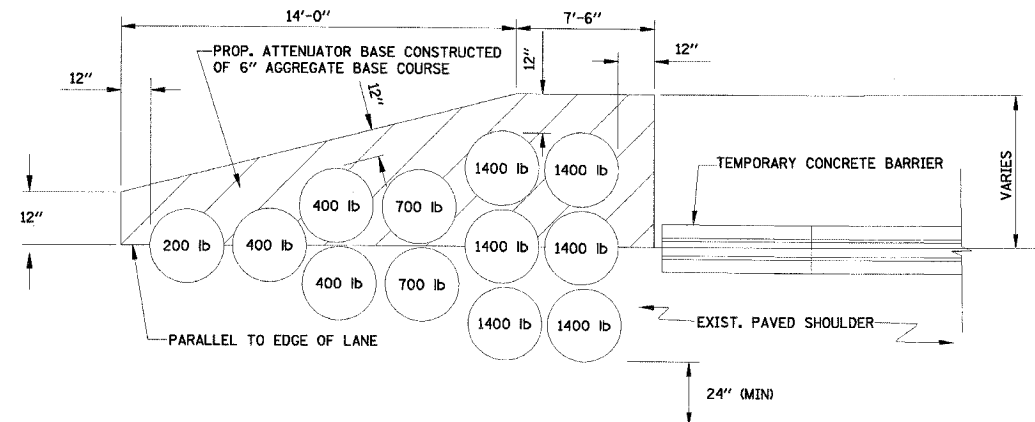

NOTE:  
CONSTRUCTION AND REMOVAL OF ATTENUATOR  
BASE SHALL BE INCLUDED IN THE COST OF  
THE IMPACT ATTENUATOR INSTALLATION.

**DETAIL B**  
IMPACT ATTENUATORS, TEMPORARY OR RELOCATED  
(NON-REDIRECTIVE), TEST LEVEL 3

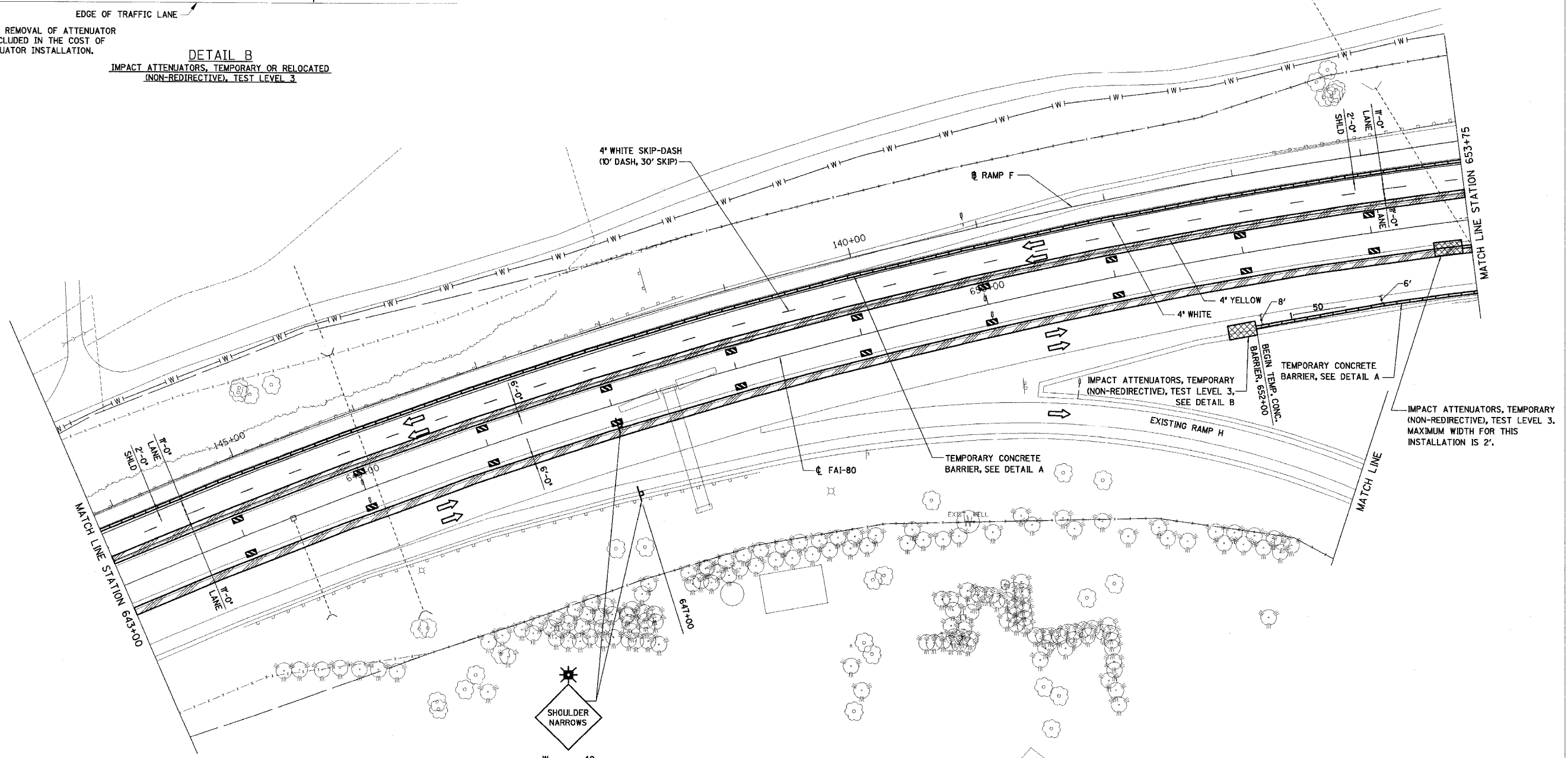

| REVISIONS | NAME | DATE |
|-----------|------|------|
|           |      |      |
|           |      |      |
|           |      |      |
|           |      |      |

ILLINOIS DEPARTMENT OF TRANSPORTATION

**STAGE I CONSTRUCTION PLAN**

F.A.I. 80 AT ILLINOIS ROUTE 351  
STATION 643+00 TO STATION 653+75

DATE: 09/04  
DRAWN BY: MES  
CHECKED BY: MTD

SCALE IN FEET