

ROUTE NO.	SECTION	COUNTY	TOTAL SHEETS	SHEET NO.
FA.I. 80 (50-2)HBR	LA SALLE	460	191	
STA 170+00			TO STA 173+00	
FED. ROAD DIST. NO. 3	ILLINOIS	FED. AID PROJECT		

CONTRACT NO. 86603

DATE	BY
REVISIONS	
NO.	DESCRIPTION
FINAL SURVEY	PLOTTED
NOTE BOOK	AREAS CHECKED
NO.	

DATE	BY
REVISIONS	
NO.	DESCRIPTION
ORIGINAL SURVEY	PLOTTED
NOTE BOOK	AREAS CHECKED
NO.	

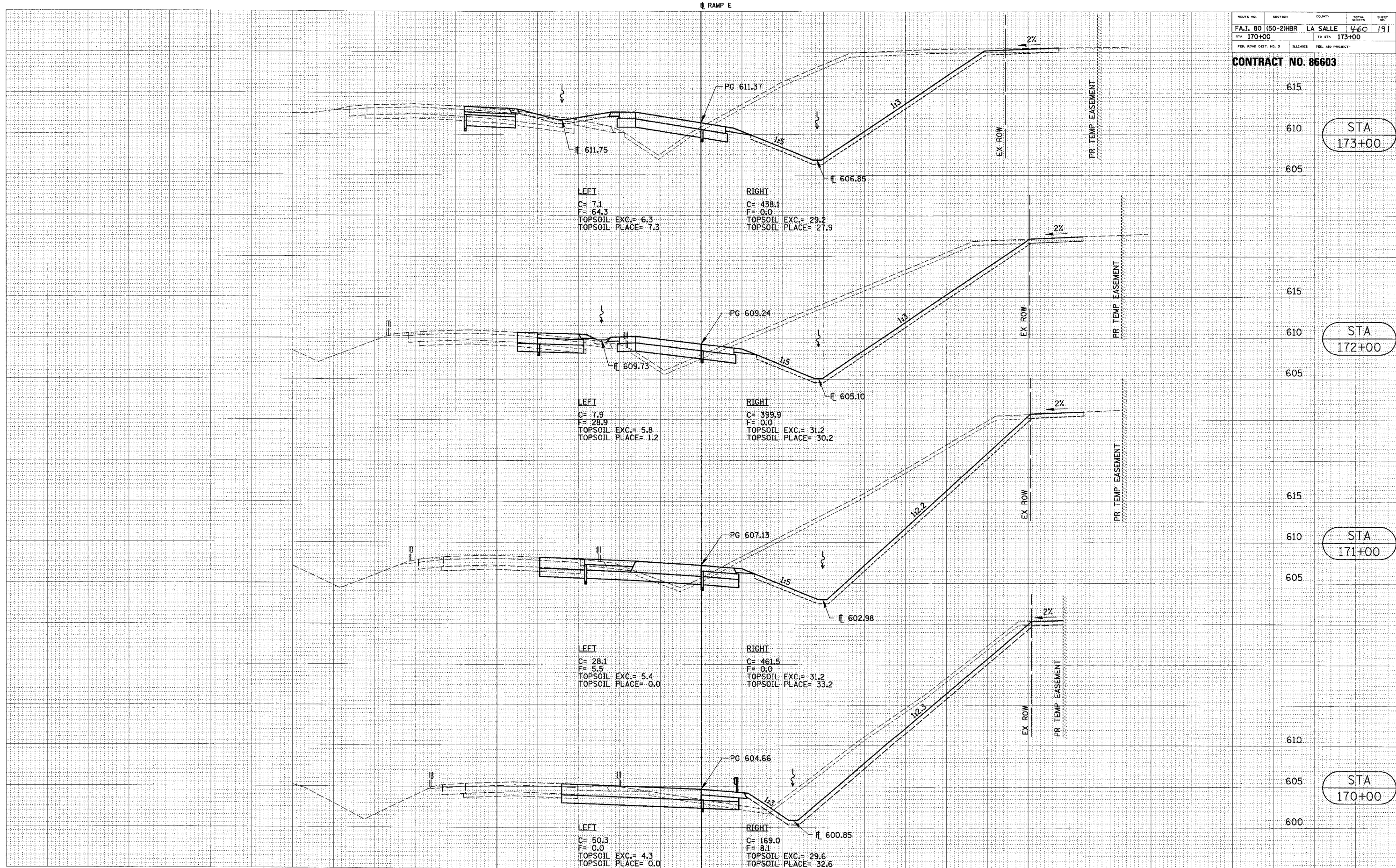

CROSS SECTIONS (RAMP E)