

ROUTE NO.	SECTION	COUNTY	TOTAL SHEETS	SHEET NO.
FA.I. 80 (50-2)HR		LA SALLE	460	192
STA 174+00			TO STA 177+00	
FED. ROAD DIST. NO. 3	ILLINOIS	FED. AID PROJECT		

CONTRACT NO. 86603

625

620
STA 177+00

615

625

620
STA 176+00

615

620

615
STA 175+00

610

620

615
STA 174+00

610

RAMP E

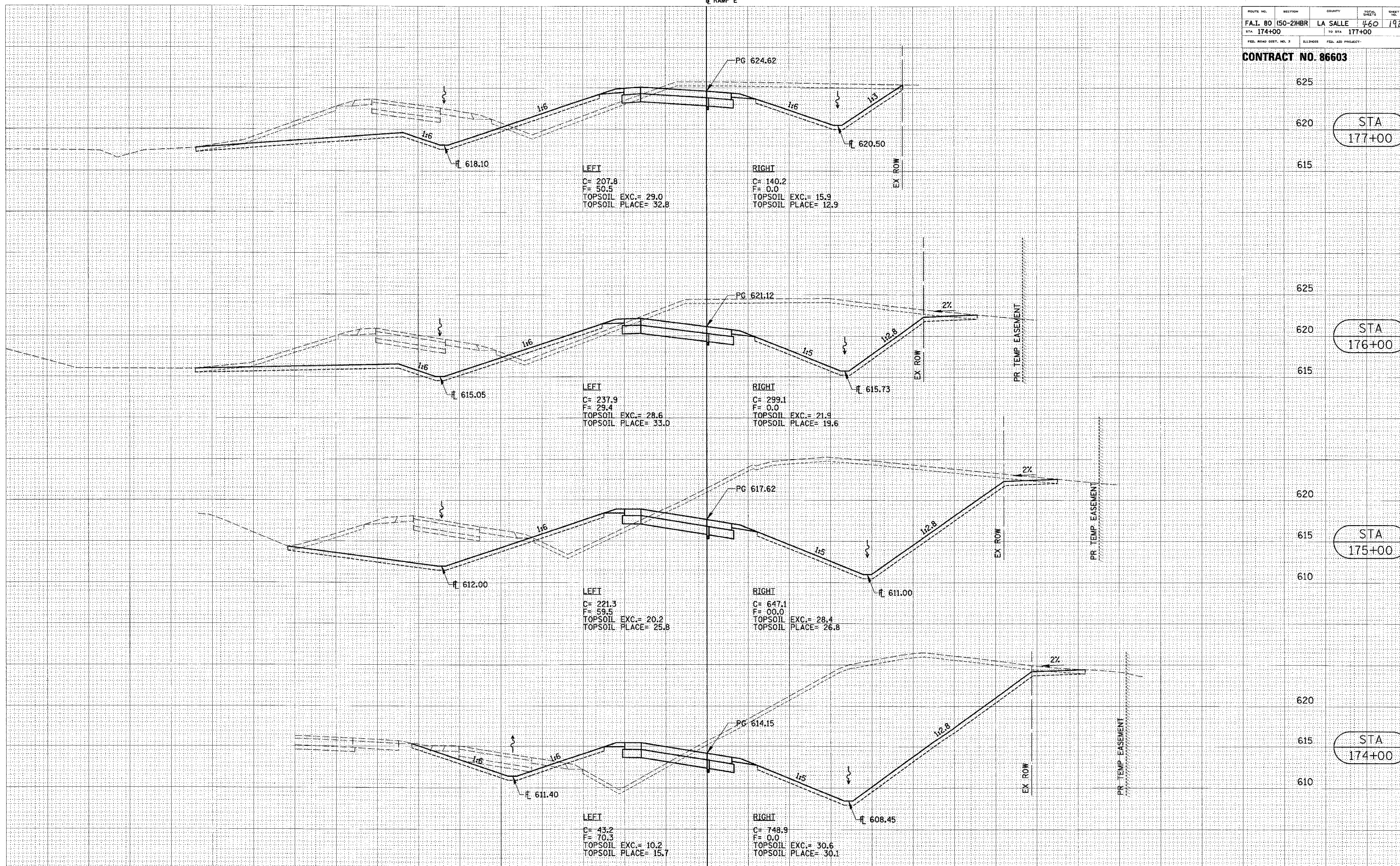

LEFT
C= 207.8
F= 50.5
TOPSOIL EXC.= 29.0
TOPSOIL PLACE= 32.8

RIGHT
C= 140.2
F= 0.0
TOPSOIL EXC.= 15.9
TOPSOIL PLACE= 12.9

LEFT
C= 237.9
F= 29.4
TOPSOIL EXC.= 28.6
TOPSOIL PLACE= 33.0

RIGHT
C= 299.1
F= 0.0
TOPSOIL EXC.= 21.9
TOPSOIL PLACE= 19.6

LEFT
C= 221.3
F= 59.5
TOPSOIL EXC.= 20.2
TOPSOIL PLACE= 25.8

RIGHT
C= 647.1
F= 00.0
TOPSOIL EXC.= 28.4
TOPSOIL PLACE= 26.8

LEFT
C= 45.2
F= 70.3
TOPSOIL EXC.= 10.2
TOPSOIL PLACE= 15.7

RIGHT
C= 748.9
F= 0.0
TOPSOIL EXC.= 30.6
TOPSOIL PLACE= 30.1

130 120 110 100 90 80 70 60 50 40 30 20 10 0 10 20 30 40 50 60 70 80 90 100 110 CROSS SECTIONS (RAMP E)

DATE	BY
REVISIONS	
NO.	DESCRIPTION

DATE	BY
REVISIONS	
NO.	DESCRIPTION