

RAMP G

ROUTE NO.	SECTION	COUNTY	SHEET NO.	TOTAL SHEETS
F.A.I. 80 (50-2)HBR	LA SALLE	460	205	
STA 246+00			TO STA 249+00	
FED. ROAD DIST. NO. 3	ILLINOIS	FED. AID PROJECT-		

CONTRACT NO. 86603

DATE	BY
DATE	BY
DATE	BY

DATE	BY
DATE	BY
DATE	BY

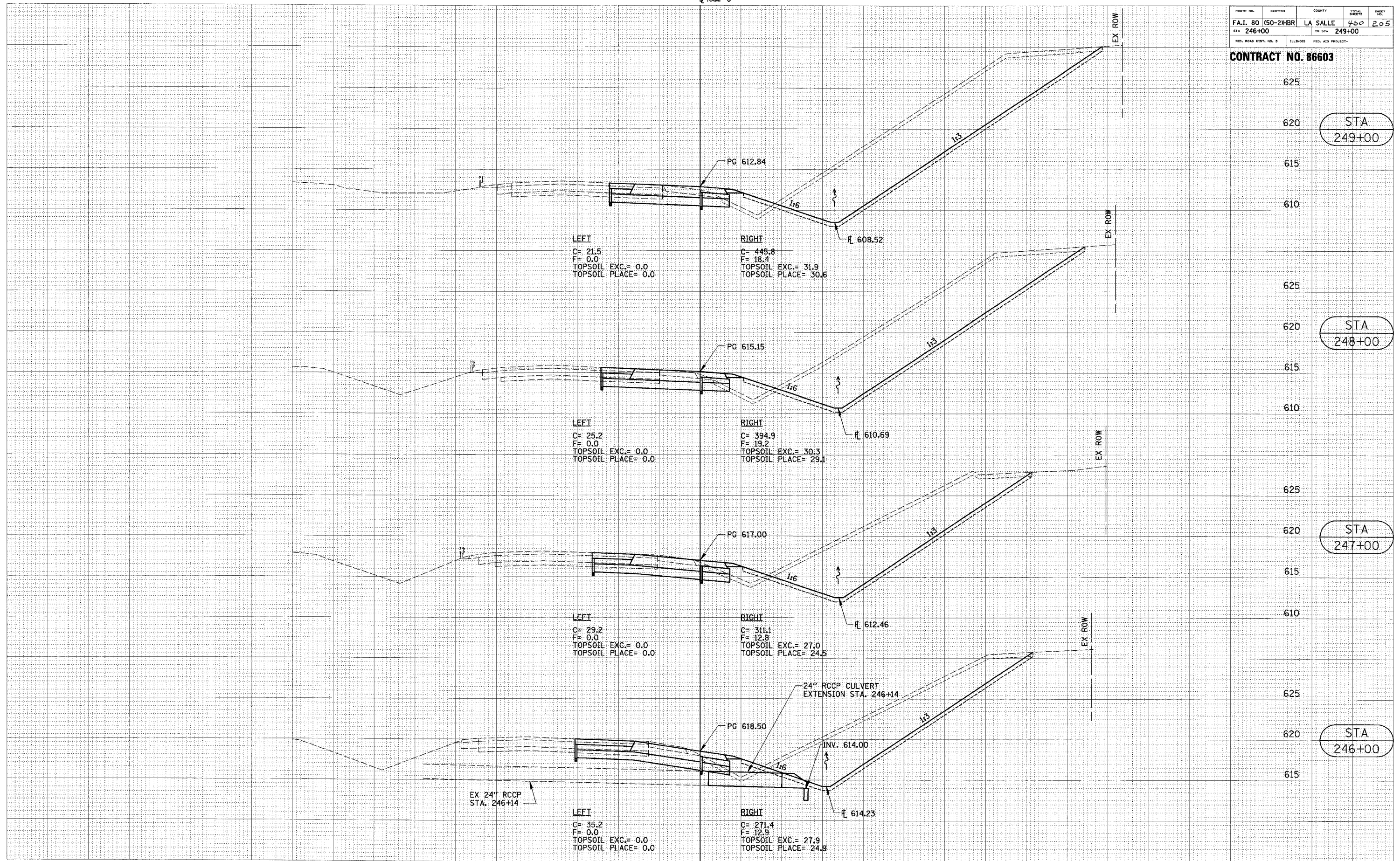

625

620

615

610

625

620

615

610

625

620

615

610

625

620

615

STA 249+00

STA 248+00

STA 247+00

STA 246+00

130 120 110 100 90 80 70 60 50 40 30 20 10 0 10 20 30 40 50 60 70 80 90 100 110

CROSS SECTIONS (RAMP G)