

F.A.U. RTE.	SECTION	COUNTY	TOTAL SHEETS	SHEET NO.
6108	(70XN & TS-1)	LA SALLE	460	311
STA. 53+00	TO STA. 58+00			
FED. ROAD DIST. NO.	ILLINOIS	FED. AID PROJECT		
CONTRACT NO. 86603				

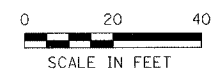

DESIGN	
INT. DATE	REASON

PLOTS & CHECKS	
INT. DATE NO.	REASON

FILE NAME = #PLOTTER\$
 PLOT SCALE = #PLOTTER\$
 PLOT TIME = #PLOTTER\$
 OPERATOR = #PLOTTER\$

CHECKS	
INT. DATE	REASON

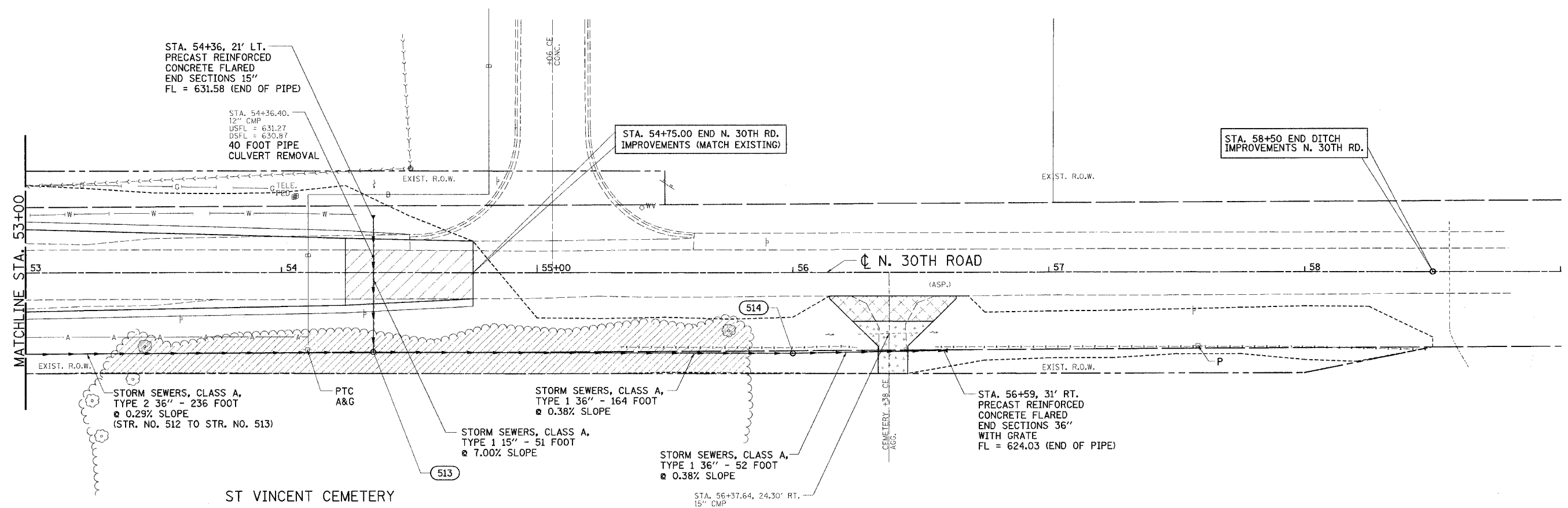

- (513)
 STA. 54+36, 31.5' RT.
 MANHOLES, TYPE A,
 5'-DIAMETER, TYPE 8 GRATE
 RIM = 633.50
 FL (E) = 624.85
 FL (W) = 624.85
 FL (N) = 628.01
- (514)
 STA. 56+00, 32' RT.
 MANHOLES, TYPE A,
 5'-DIAMETER, TYPE 1 FRAME,
 CLOSED LID
 RIM = 628.00
 FL = 624.23

REVISIONS	
NAME	DATE
MABUS	09/15/03

ILLINOIS DEPARTMENT OF TRANSPORTATION

DRAINAGE AND UTILITIES PLAN

FAU 6108 (IL. RTE. 351)
SECTION (70XN & TS-1)
LASALLE COUNTY

SCALE: VERT. _____
 HORIZ. _____
 DATE: 06/30/03

DRAWN BY: MABUS
 DESIGNED BY: BOTT
 CHECKED BY: COLBROOK

GREENE & BRADFORD, INC.
CONSULTING ENGINEERS
 1000 WEST 12TH STREET
 DECATUR, ILLINOIS 62521
 PHONE: 262-5000 FAX: 262-5001

COMPUTER FILE NO.
 SS351K-03
PROJECT: 01194.B.N
 04/27/04-RPB

Small text at the bottom left corner, likely a software or version identifier.