

DESIGN		
INT.	DATE	REASON

PLOTS & CHECKS			
INT.	DATE	NO.	REASON

FILE NAME = \$FILES  
 PLOT SCALE = \$PLOTSCALE  
 PLOT TIME = \$PLOTTIME  
 OPERATOR = \$USER\$

CHECKS		
INT.	DATE	REASON

F.A.U. RTE.	SECTION	COUNTY	TOTAL SHEETS	SHEET NO.
6108	(70XN & TS-1)	LASALLE	468	329
STA. 41+00		TO STA. 59+00		
FED. ROAD DIST. NO.	ILLINOIS	FED. AID PROJECT		
CONTRACT NO. 86603				

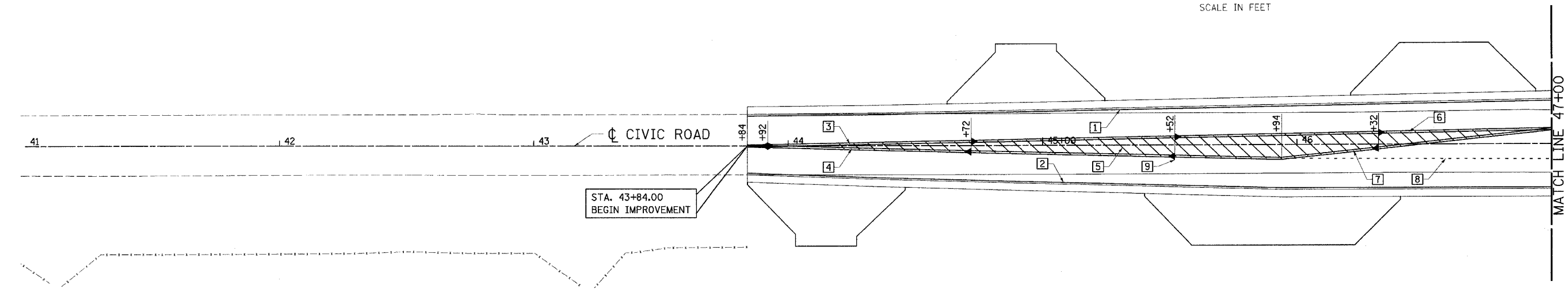
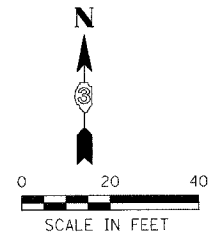

- 1 EPOXY PAVEMENT MARKING-LINE 4" (WHITE) 316 FOOT
- 2 EPOXY PAVEMENT MARKING-LINE 4" (WHITE) 316 FOOT
- 3 EPOXY PAVEMENT MARKING-LINE 4" (DOUBLE YELLOW) 420 FOOT
- 4 EPOXY PAVEMENT MARKING-LINE 4" (DOUBLE YELLOW) 420 FOOT
- 5 EPOXY PAVEMENT MARKING-LINE 12" (YELLOW-DIAGONAL) 713 FOOT
- 6 EPOXY PAVEMENT MARKING-LINE 4" (DOUBLE YELLOW) 212 FOOT
- 7 EPOXY PAVEMENT MARKING-LINE 4" (DOUBLE YELLOW) 213 FOOT
- 8 EPOXY PAVEMENT MARKING-LINE 8" (WHITE-SHORT DASH) 28 FOOT
- 9 RAISED REFLECTIVE PAVEMENT MARKERS 7 EACH (YELLOW)
- 10 THERMOPLASTIC PAVEMENT MARKING-LINE 4" (DOUBLE YELLOW) 350 FOOT
- 11 THERMOPLASTIC PAVEMENT MARKING-LINE 4" (DOUBLE YELLOW) 350 FOOT
- 12 THERMOPLASTIC PAVEMENT MARKING-LINE 4" (WHITE) 175 FOOT
- 13 THERMOPLASTIC PAVEMENT MARKING-LINE 12" (YELLOW-DIAGONAL) 342 FOOT
- 14 THERMOPLASTIC PAVEMENT MARKING-LINE 4" (WHITE) 150 FOOT
- 15 RAISED REFLECTIVE PAVEMENT MARKERS 3 EACH (YELLOW)

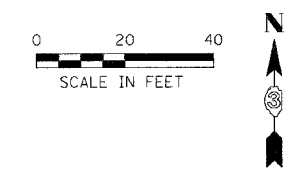
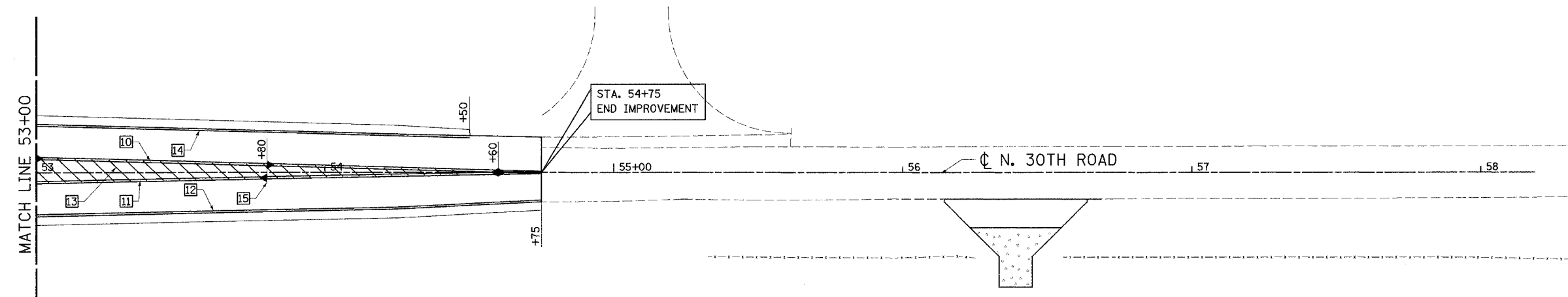

REVISIONS	
NAME	DATE

ILLINOIS DEPARTMENT OF TRANSPORTATION

### PAVEMENT STRIPING PLAN

FAU 6108 (IL. RTE. 351)  
SECTION (70XN & TS-1)  
LASALLE COUNTY

SCALE: VERT. \_\_\_\_\_  
HORIZ. \_\_\_\_\_  
DATE 07/13/03

DRAWN BY: MABUS  
DESIGNED BY: BOTT  
CHECKED BY: COLBROOK

COMPUTER FILE NO.  
PM351F\_02  
PROJECT 01194.B.N  
07/13/03-PAM

GREENE & BRADFORD, INC.  
CONSULTING ENGINEERS  
PROFESSIONAL ENGINEERS  
1100 W. MONROE ST. SUITE 200  
SPRINGFIELD, ILLINOIS 62761-3100  
(618) 266-3800 FAX (618) 266-3801  
WWW.GREENE-AND-BRADFORD.COM