

90920

TYPICAL APPLICATIONS OF PAVEMENT MARKINGS AND MARKERS

2 LANES TO 3 LANES OR 4 LANES TO 5 LANES

LEFT TURN LANE

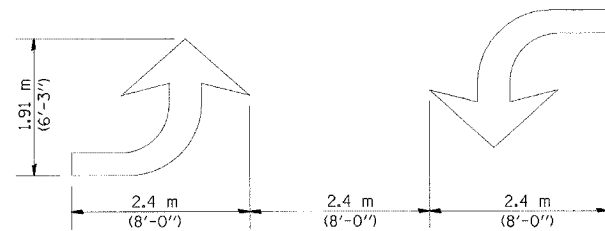
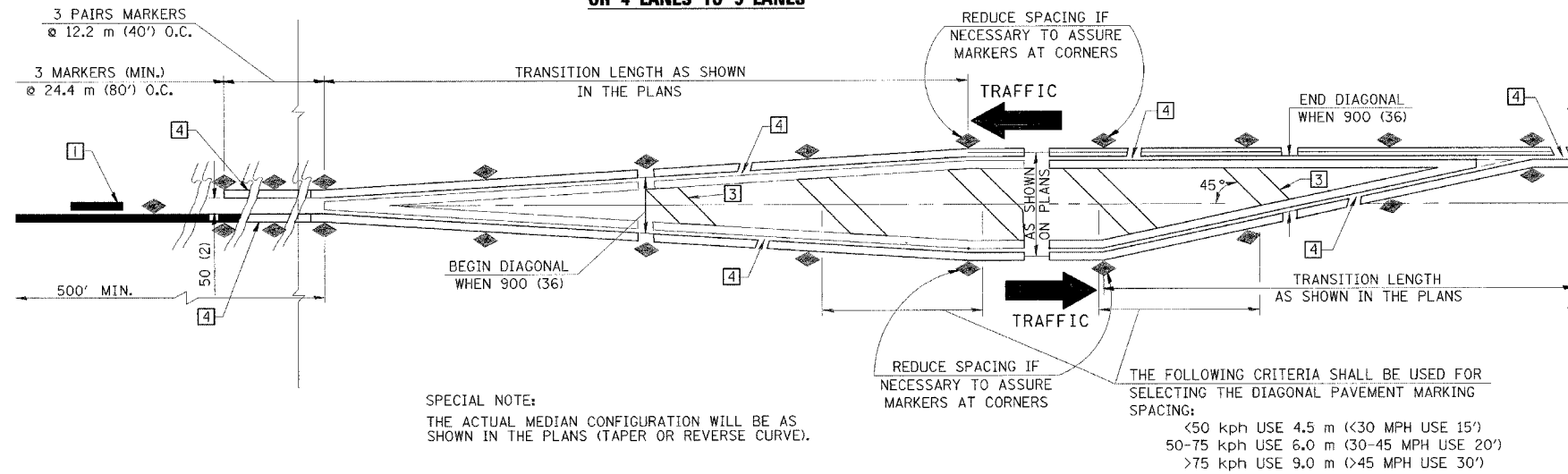

**TYPICAL DOUBLE
TURN ARROWS
(WHITE)**

TYPICAL MEDIAN TRANSITIONS

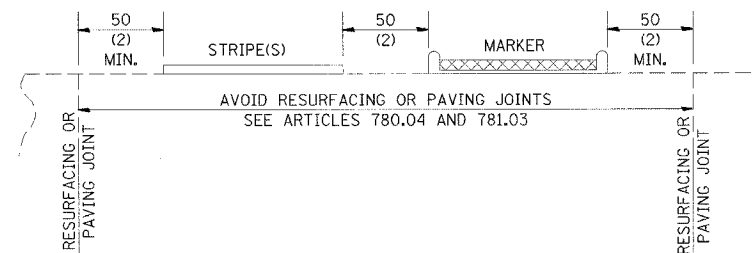

**RELATIONSHIP OF STRIPES,
MARKERS AND JOINTS**

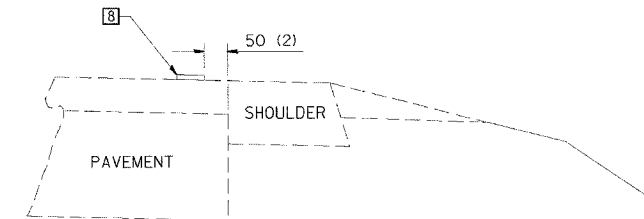

**RELATIONSHIP OF EDGE STRIPE TO
SAFETY SHOULDER OR PAVED SURFACE**

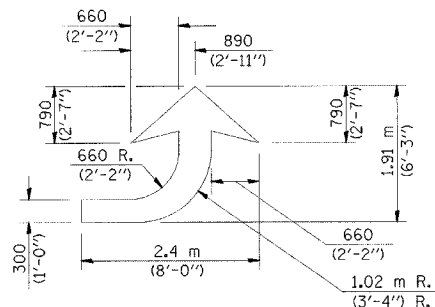

LEFT ARROW
REVERSE FOR
RIGHT ARROW
AREA= 1.47 m² (15.6 SQ. FT.)
(WHITE)

GENERAL NOTES

- WHEN MEDIANS ARE PRESENT PAVEMENT MARKINGS ARE TO BE PLACED ADJACENT TO MEDIANS.
- SCALE: NONE
- SOME OF THE INFORMATION INCLUDED WITH THIS DETAIL MAY NOT BE APPLICABLE TO THIS IMPROVEMENT.
- PAVEMENT MARKINGS ARE TO BE EXTENDED THROUGH OMISSIONS WHEN APPLICABLE.
- A STRIPING KEY IS AVAILABLE ELSEWHERE AND SHALL BE SHOWN WHERE THE QUANTITIES ARE LISTED.
- FINAL PAVEMENT MARKINGS SHALL BE IN PLACE PRIOR TO PLACING ANY RAISED REFLECTIVE PAVEMENT MARKERS.
- THE FOLLOWING CRITERIA SHALL BE USED FOR SELECTING THE DIAGONAL PAVEMENT MARKING SPACING:
< 50 kph USE 4.5 m (< 30 MPH USE 15')
50-75 kph USE 6.0 m (30-45 MPH USE 20')
> 75 kph USE 9.0 m (> 45 MPH USE 30')

REVISIONS	
NAME	DATE

ILLINOIS DEPARTMENT OF TRANSPORTATION
**PAVEMENT MARKING
DETAILS**
FAP 828 (MONTROSE RD.)
CUMBERLAND COUNTY
STATION 11+724.930

DATE
DRAWN BY BANDY
CHECKED BY STEUART

All dimensions are in millimeters (inches) unless otherwise shown.

	NAME	DATE
DESIGNED	J.M.H.	6/88
CHECKED	C.T.D.	6/88
CADD NO.	F-5.25	

REVISIONS	
NAME	DATE
G.A.M.	11/95
CHECKED D.L.P.	12/95

REVISIONS	
NAME	DATE
D.L.P.	8/97
GEOMETRICS	6/01

SHEET 3 OF 3