

F.A.P. RTE.	SECTION	COUNTY	TOTAL SHEETS	SHEET NO.
828	12BR-2	CUMBERLAND	32	28
STA.	TO STA.			
FED. ROAD DIST. NO.	ILLINOIS FED. AID PROJECT			
	90920			

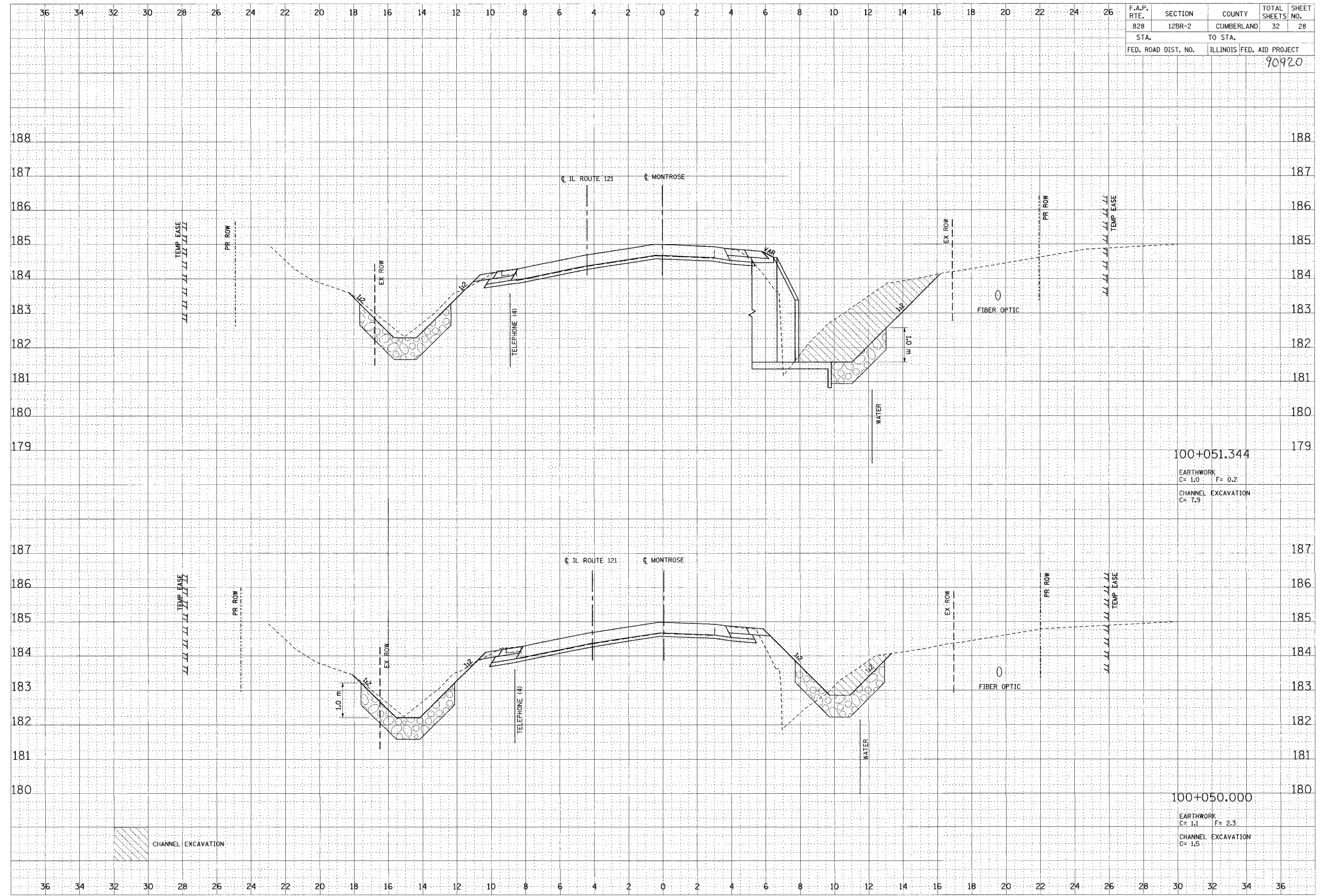

FINAL SURVEY	DATE
BY	
REVISIONS	
NO.	
PLOTTED	
REPLATE	
NOTE BOOK	
AREAS CHECKED	

ORIGINAL SURVEY	DATE
BY	
REVISIONS	
NO.	
PLOTTED	
REPLATE	
NOTE BOOK	
AREAS CHECKED	

CROSS SECTIONS, MONTROSE ROAD, STA. 100+050.000 TO 100+051.344

11/17/03 10:03:11 AM C:\PROJECTS\12BR-2\12BR-2-28.DWG