

F.A.P. RTE.	SECTION	COUNTY	TOTAL SHEETS	SHEET NO.
828	12BR-2	CUMBERLAND	32	30
STA.	TO STA.			
FED. ROAD DIST. NO.	ILLINOIS	FED. AID PROJECT	90920	

DATE	BY
DATE	BY
DATE	BY

DATE	BY
DATE	BY
DATE	BY

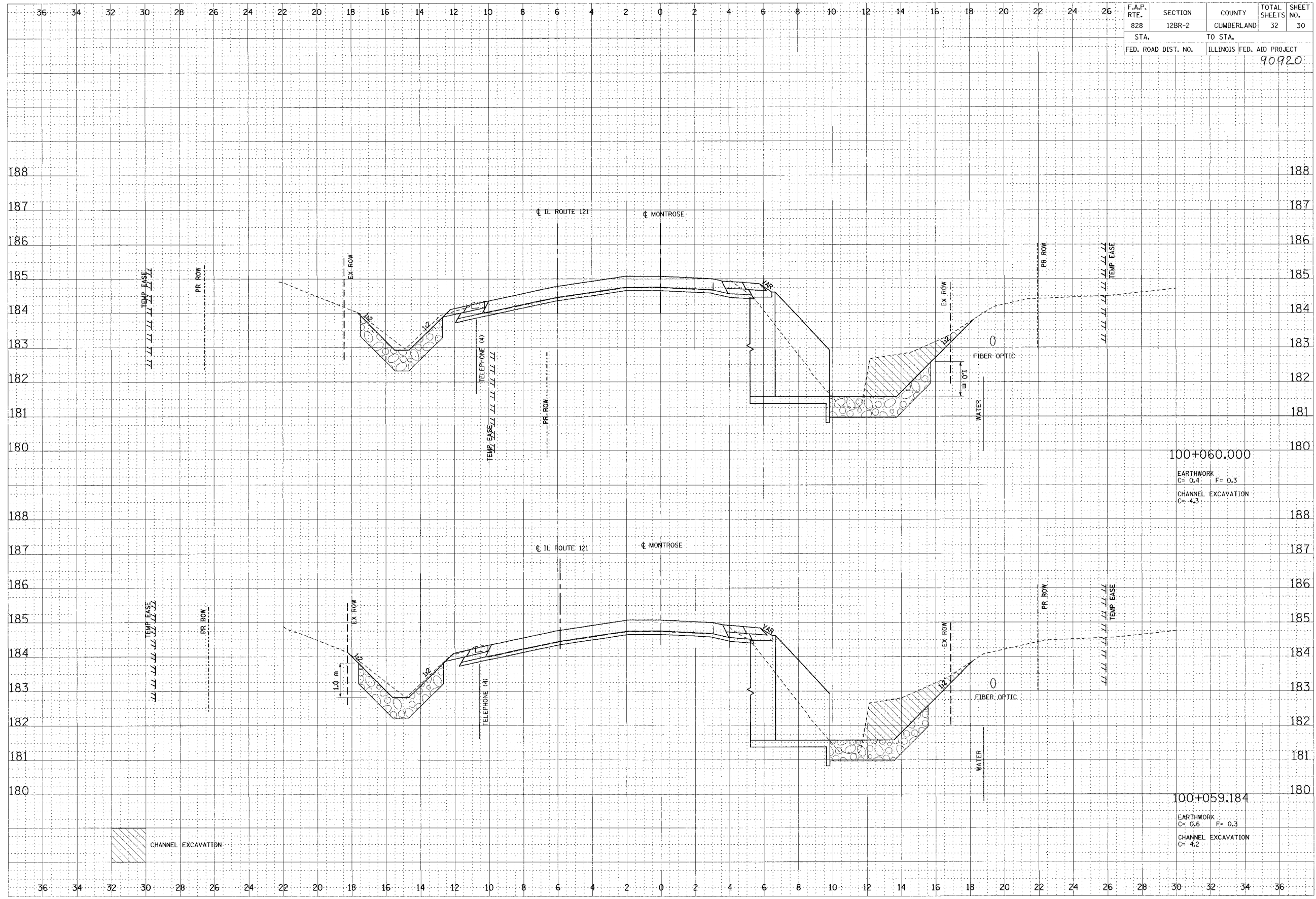

CROSS SECTIONS, MONTROSE ROAD, STA. 100+059.184 TO 100+060.000

...\\p01\68157\68157.dwg: 12/29/2008 12:01:10 PM