

RTE.	SECTION	COUNTY	TOTAL SHEETS	SHEET NO.
C.H. 11	*	MENARD	44	35
PROJECT 98-565(110)				
98-00047-00-RS				

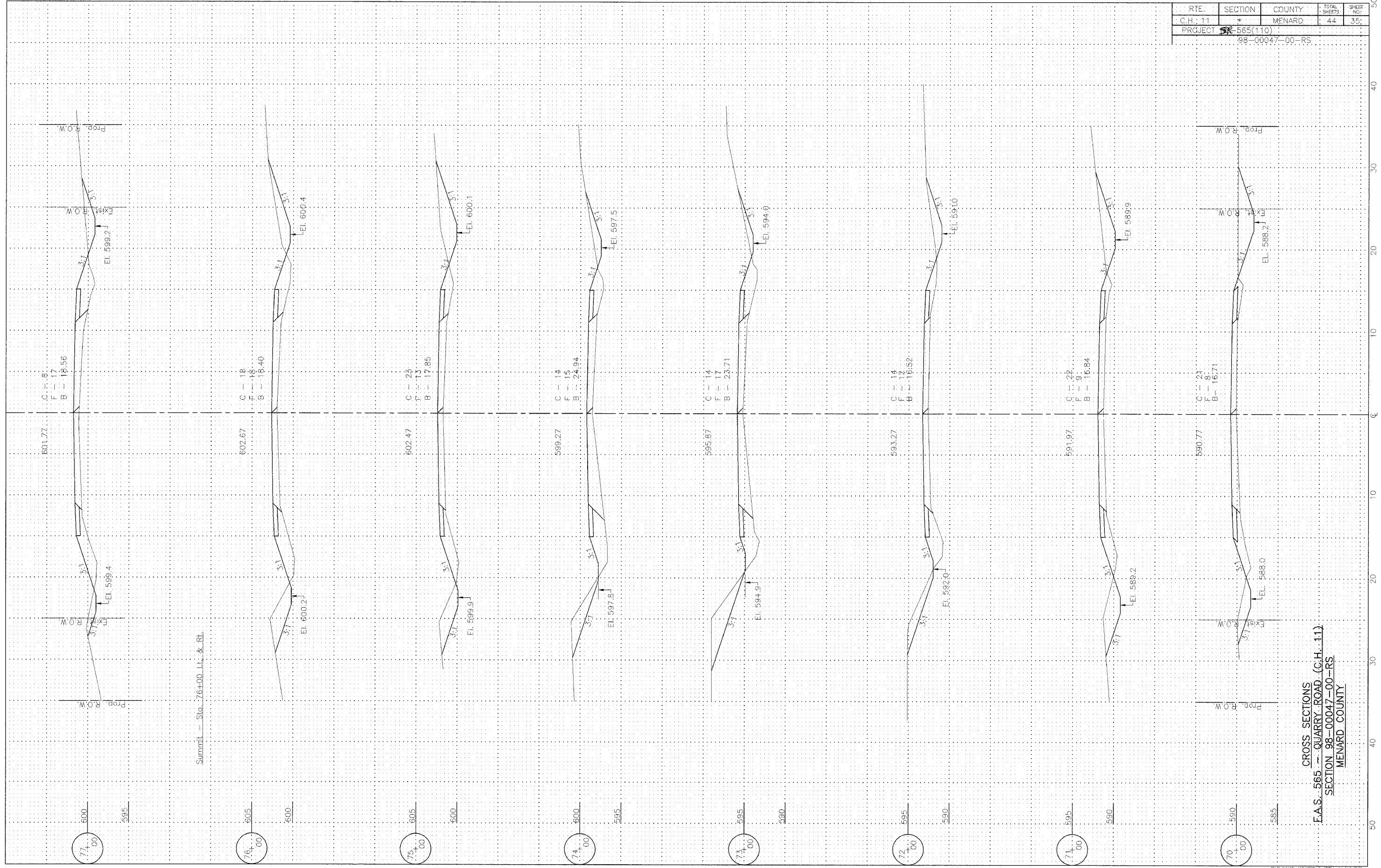

Summit - Sta. 76+00 Lt. & Rt.

CROSS SECTIONS  
 F.A.S. 565 - QUARRY ROAD (C.H. 11)  
 SECTION 98-00047-00-RS  
 MENARD COUNTY