

F.A.S. RTE.	SECTION	COUNTY	TOTAL SHEETS	SHEET NO.
601	(*)	PIKE	51	1
STA.		TO STA.		
FED. ROAD DIST. NO.		ILLINOIS FED. AID PROJECT		
(*) 02-00077-00-RS				

INDEX OF SHEETS	
SHEET NO.	DESCRIPTION
1	COVER SHEET
2	GENERAL NOTES
3-4	SUMMARY OF QUANTITIES
5-8	SCHEDULE OF QUANTITIES
9-11	TYPICAL SECTIONS
12	CONTROL POINTS AND TIES
13	ALIGNMENTS AND BENCHMARKS
14-32	PLAN AND PROFILES
33	INTERSECTION DETAIL
34	SUPERELEVATION TRANSITION DETAILS
35	BUTT-JOINT DETAIL
36-37	ENTRANCE DETAILS
38	MAILBOX TURNOUT DETAILS
39-51	CROSS SECTIONS

IDOT HIGHWAY STANDARDS				
000001-04	630001-05	635001	701201-02	701326-02
442201-01	630301-03	635006-02	701301-02	720001
606001-02	631011-02	701006-02	701306-01	720006
606101-01	631026-02	701011-01	701311-02	780001-01
				781001-02

UTILITY CONTACTS	
AMEREN CIPS JON REICK 217-221-0806 700 JERSEY STREET P.O. BOX 331 QUINCY, IL 62306	NICOR SCOTT STOGSDILL 630-983-8676 1844 FERRY RD. NAPERVILLE, IL 60563
VERIZON JASON MCEVERS 217-243-0299 300 WEST BEECHER ST. JACKSONVILLE, IL 62650	SOYLAND POWER COOPERATIVE DON FANSHIER 217-245-6161 P.O. BOX 610 JACKSONVILLE, IL 62651
PIKE COUNTY WATER DIST. TO WHOM IT MAY CONCERN P.O. BOX 336 ROCKPORT, IL 62370	ILLINOIS RURAL ELECTRIC COOP. TIM MASON 217-742-3128 2 SOUTH MAIN STREET WINCHESTER, IL 62694

INTERNATIONAL ENGINEERING CONSULTANTS, INC.

ie consultants

6420 SOUTH SIXTH STREET
 SPRINGFIELD, ILLINOIS 62707
 TEL. (217) 529-8027
 FAX (217) 529-4543
 IESPRINGFIELD@IE-CONSULTANTS.COM
 WWW.IE-CONSULTANTS.COM

CALL **J.U.L.I.E.** (JOINT UTILITY LOCATION INFORMATION FOR EXCAVATORS)
 48 Hours (2 working days) Before You Dig.
 TOLL FREE: 1 (800) 892-0123

STATE OF ILLINOIS
 DEPARTMENT OF TRANSPORTATION
 DIVISION OF HIGHWAYS
**PROPOSED
 HIGHWAY PLANS**
 SURFACE TRANSPORTATION / RURAL PROGRAM
 F.A.S. ROUTE 601 (C.H. 3)
 SECTION 02-00077-00-RS
 PROJECT NO. SR-601 (109)
PIKE COUNTY
 JOB NUMBER C-96-230-03

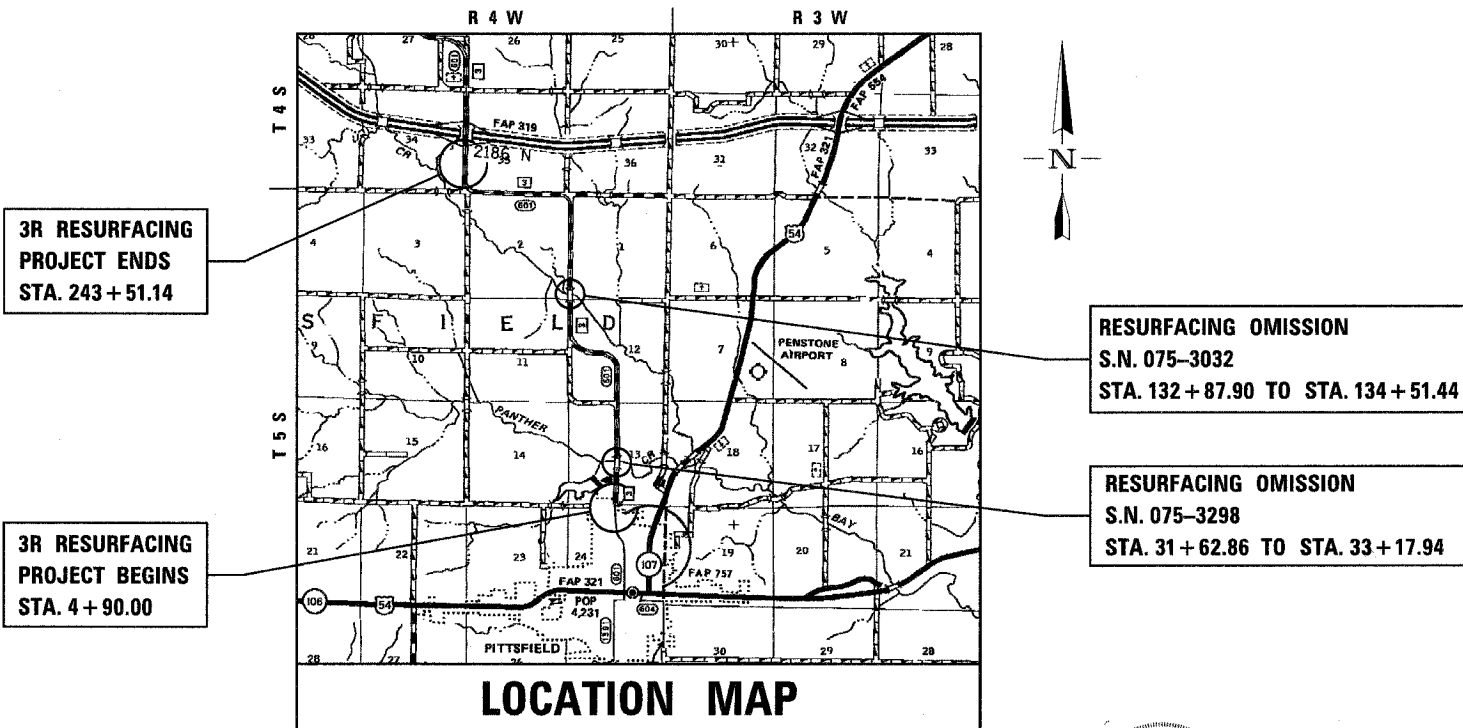

LOCATION MAP

APPROXIMATE SCALE: 0 1 2 MILES

LENGTH OF PROJECT = 23,861.14 FEET 4.519 MILES

NET LENGTH OF IMPROVEMENT = 23,542.52 FEET 4.459 MILES

HIGHWAY CLASSIFICATION = MAJOR COLLECTOR

ADT: 2,250 (2004) 3.0% SU; 1.0% MU
 2,500 (2014) 3.0% SU; 1.0% MU

CONTRACT No. 93386 3R DESIGN (50 MPH)

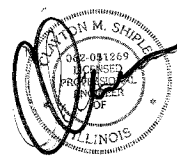

CLAYTON M. SHIPLEY ILLINOIS P.E. 062-051269
 EXPIRES 11/30/2006 DATE 8/23/04



SCALES

PLAN	0 50 100
PROFILE HORIZ.	0 50 100
PROFILE VERT.	0 5 10
CROSS SECTIONS HORIZ.	0 10 20
CROSS SECTIONS VERT.	0 5 10

FULL SIZE PLANS HAVE BEEN PREPARED USING STANDARD ENGINEERING SCALES, REDUCED SIZED PLANS WILL NOT CONFORM TO STANDARD SCALES. WHEN MAKING MEASUREMENTS ON REDUCED PLANS, THE ABOVE SCALES MAY BE USED.

SUBMITTED	10-13-04	2004	Clayton M. Shipley
PIKE COUNTY ENGINEER			
PASSED	10-14-04	2004	William F. Martens
DISTRICT ENGINEER - LOCAL ROADS			
PASSED	Oct 14	2004	W. R. Fry
DISTRICT ENGINEER OF CONSTRUCTION			
APPROVED	Oct 18	2004	Clayton M. Shipley
DISTRICT ENGINEER			

PRINTED BY THE AUTHORITY OF THE STATE OF ILLINOIS