

F.A.S. RTE.	SECTION	COUNTY	TOTAL SHEETS	SHEET NO.
601	(*)	PIKE	51	14
STA. 4+90	TO STA. 18+50			
FED. ROAD DIST. NO.	ILLINOIS FED. AID PROJECT			

(\*) 02-00077-00-RS

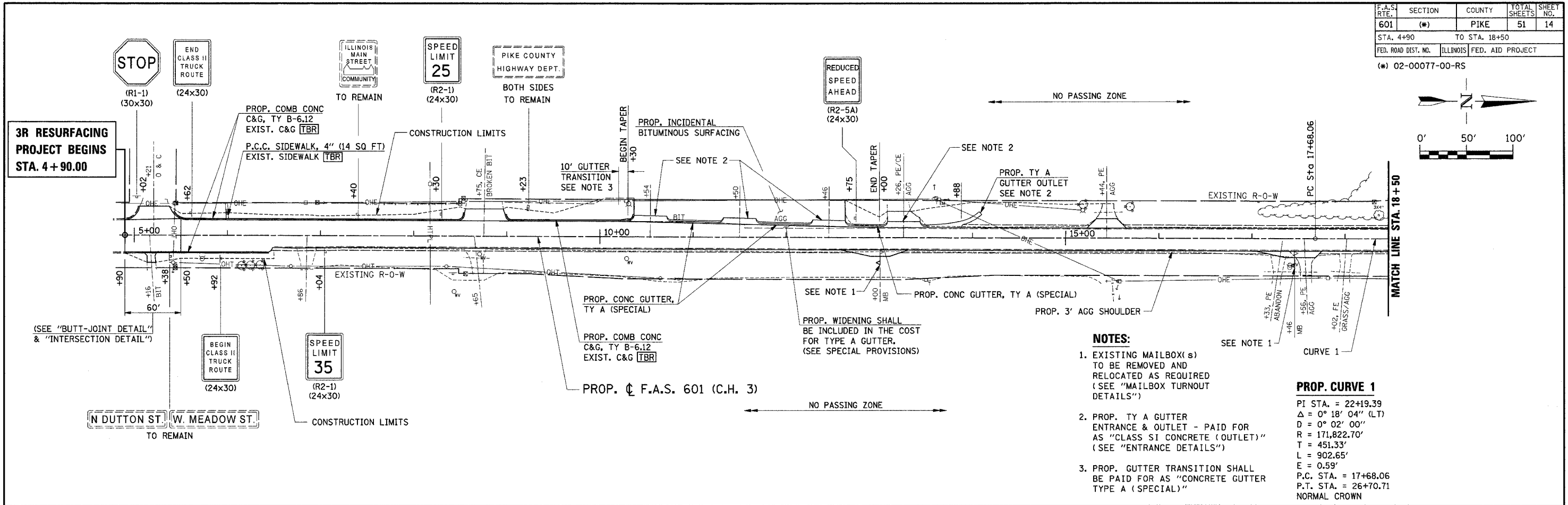

- NOTES:**
- EXISTING MAILBOX( s) TO BE REMOVED AND RELOCATED AS REQUIRED (SEE "MAILBOX TURNOUT DETAILS")
  - PROP. TY A GUTTER ENTRANCE & OUTLET - PAID FOR AS "CLASS SI CONCRETE (OUTLET)" (SEE "ENTRANCE DETAILS")
  - PROP. GUTTER TRANSITION SHALL BE PAID FOR AS "CONCRETE GUTTER TYPE A (SPECIAL)"
- PROP. CURVE 1**  
 PI STA. = 22+19.39  
 $\Delta = 0^\circ 18' 04''$  (LT)  
 $D = 0^\circ 02' 00''$   
 $R = 171,822.70'$   
 $T = 451.33'$   
 $L = 902.65'$   
 $E = 0.59'$   
 P.C. STA. = 17+68.06  
 P.T. STA. = 26+70.71  
 NORMAL CROWN

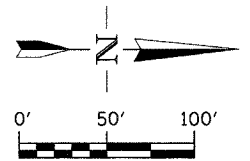
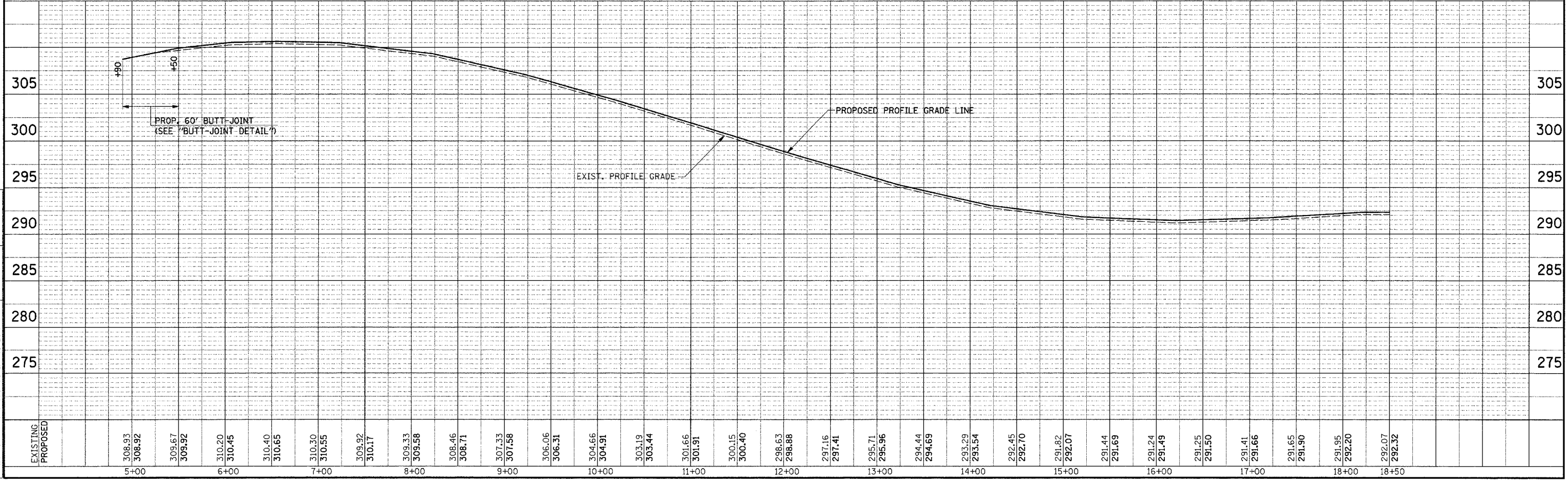

PLAN AND PROFILE - STA. 4+90 TO STA. 18+50

FILE: G:\NS03012\CAD\3012P01.DGN 08/24/04 06:39:05 AM