

F.A.S. RTE.	SECTION	COUNTY	TOTAL SHEETS	SHEET NO.
601	(*)	PIKE	51	16
STA. 32+00		TO STA. 46+00		
FED. ROAD DIST. NO.	ILLINOIS	FED. AID PROJECT		

(*) 02-00077-00-RS

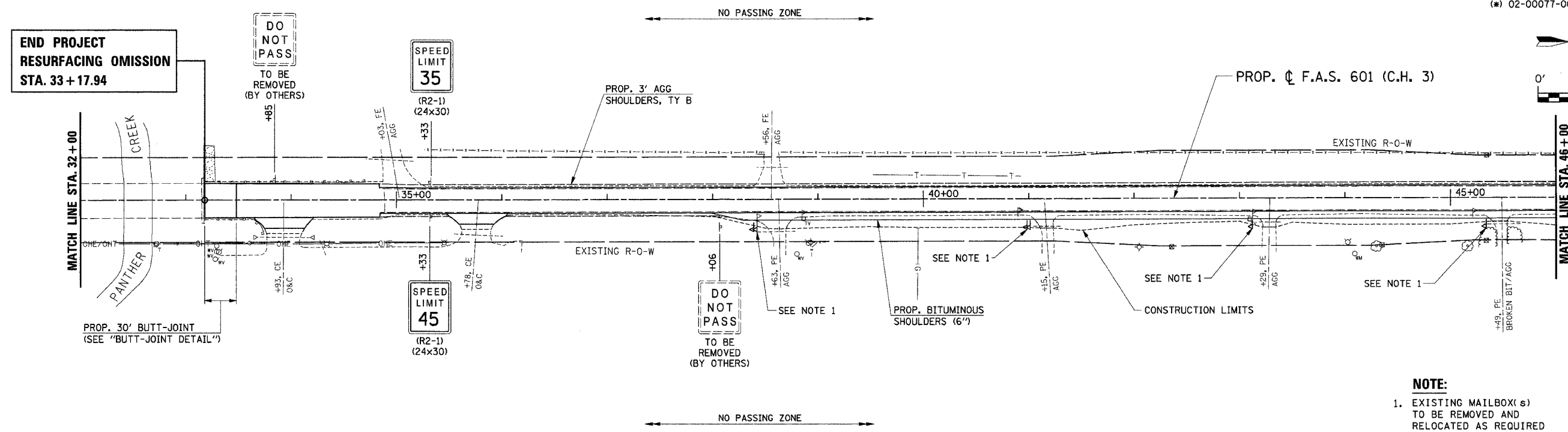

NOTE:
 1. EXISTING MAILBOX(S) TO BE REMOVED AND RELOCATED AS REQUIRED (SEE "MAILBOX TURNOUT DETAILS")

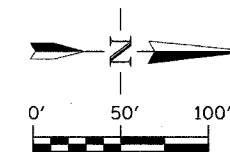
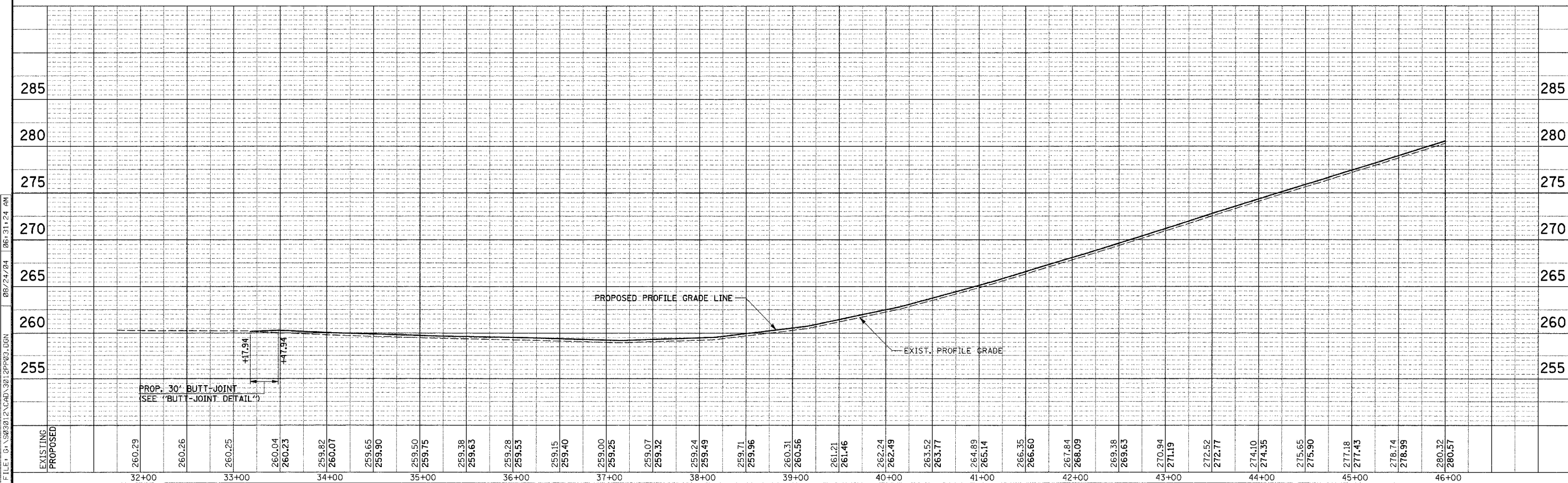

PLAN AND PROFILE - STA. 32+00 TO STA. 46+00

FILE: G:\S03012\CAD\3012P203.DGN 08/24/04 06:31:24 AM