

F.A.P. RTE.	SECTION	COUNTY	TOTAL SHEETS	SHEET NO.
774		EFFINGHAM	344	69
STA. 922+00.00		TO STA. 934+00.00		
FED. ROAD DIST. NO. 7		ILLINOIS FED. AID PROJECT		
		• 107WRS-1, 107BY, 107BY-1 & 107B-2		
CONTRACT NO. 94827				

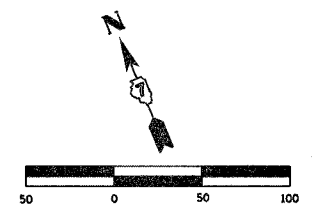

PERMANENT SURVEY MARKERS, TYPE 1
STA 928+00.00 1 EACH

PLAN	SURVEYED	BY	DATE
	PLOTTED		
	CHECKED		
	RT. OF WAY CHECKED		
	CADD FILE NAME		
	NO.		

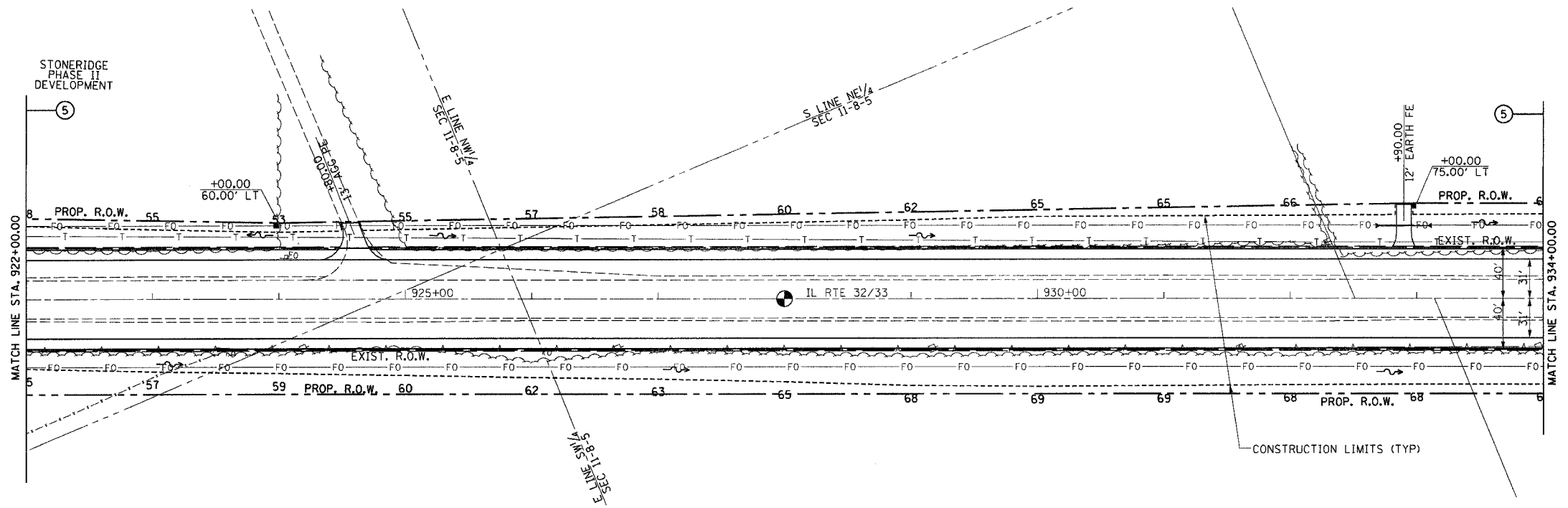

PROFILE	SURVEYED	BY	DATE
	PLOTTED		
	CHECKED		
	RT. OF WAY CHECKED		
	STRUCTURE NOTATIONS CHKD		
	NO.		

