

BITUMINOUS SURFACE REMOVAL - BUTT JOINT  
 STA. 49+90.00 - STA. 50+30.00 107 SQ YD

REMOVE PAVEMENT, SUBGRADE AND SHOULDERS AS SCHEDULED.  
 GRADE TO DRAIN PER CROSS SECTIONS AND/OR ENGINEER.

F.A.P. RTE.	SECTION	COUNTY	TOTAL SHEETS	SHEET NO.
774		EFFINGHAM	344	83
FED. ROAD DIST. NO. 7 ILLINOIS FED. AID PROJECT				
• 107WRS-1, 107BY, 107BY-1 & 107B-2				
CONTRACT NO. 94827				

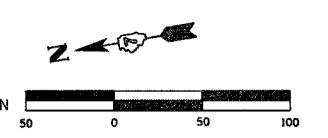

PLAN	SURVEYED	DATE
	BY	
	NOTED	
	BY	
	DATE	

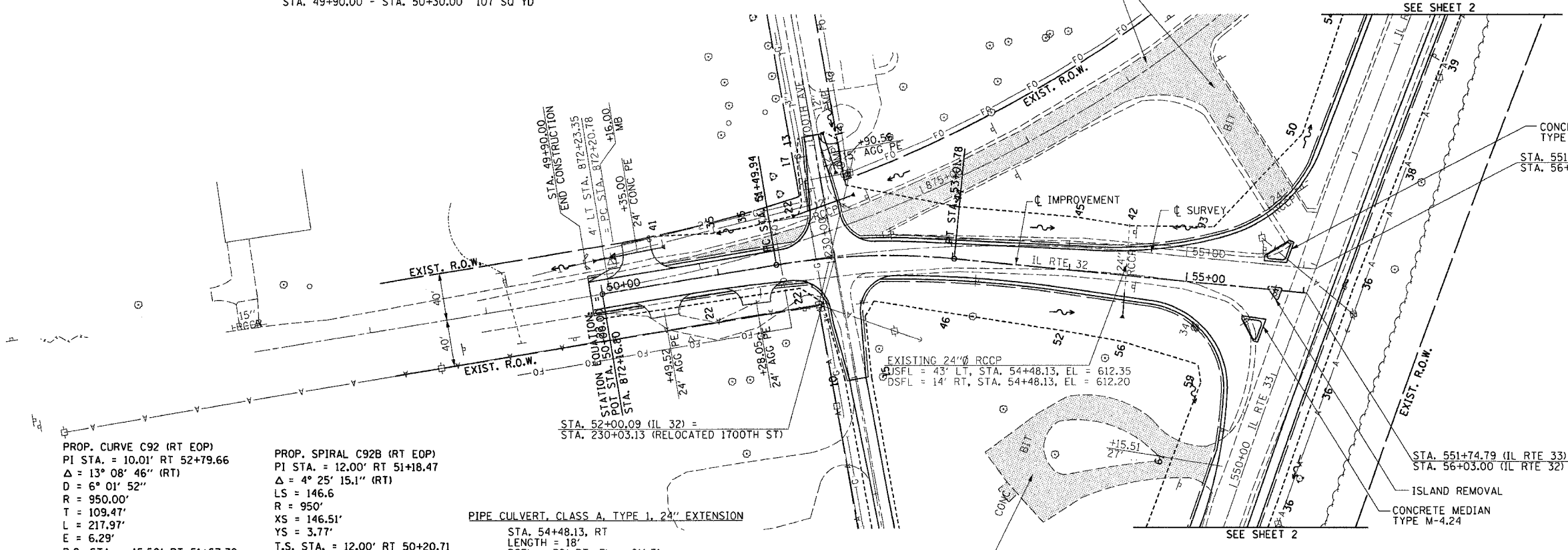

PROP. CURVE C92 (RT EOP)  
 PI STA. = 10.01' RT 52+79.66  
 $\Delta = 13^\circ 08' 46''$  (RT)  
 $D = 6^\circ 01' 52''$   
 $R = 950.00'$   
 $T = 109.47'$   
 $L = 217.97'$   
 $E = 6.29'$   
 P.C. STA. = 15.50' RT 51+67.70  
 P.T. STA. = 15.33' RT 53+89.40

PROP. SPIRAL C92B (RT EOP)  
 PI STA. = 12.00' RT 51+18.47  
 $\Delta = 4^\circ 25' 15.1''$  (RT)  
 $LS = 146.6'$   
 $R = 950'$   
 $XS = 146.51'$   
 $YS = 3.77'$   
 T.S. STA. = 12.00' RT 50+20.71  
 S.C. STA. = 15.50' RT 51+67.70

PIPE CULVERT, CLASS A, TYPE 1, 24" EXTENSION  
 STA. 54+48.13, RT  
 LENGTH = 18'  
 DSFL = 32' RT, EL. = 611.71  
 1 EACH, PRC FLARED END SECTION, 24"  
 (SEE SHEET 139 FOR CONCRETE COLLAR DETAILS)

PROP. CURVE C98  
 PI STA. = 52+26.30  
 $\Delta = 14^\circ 59' 59''$  (RT)  
 $D = 9^\circ 52' 43''$   
 $R = 580.01'$   
 $T = 76.36'$   
 $L = 151.84'$   
 $E = 5.00'$   
 $e = 4.00\%$   
 P.C. STA. = 51+49.94  
 P.T. STA. = 53+01.78  
 SE ATTAINED STA. 50+20.00 TO STA. 51+90.00  
 SE REMOVED STA. 52+60.00 TO STA. 54+30.00

FOR IL RTE 32 PROPOSED  
 EDGE OF PAVEMENT GEOMETRICS  
 SEE SHEET NO 94 & 95

PROFILE	SURVEYED	DATE
	BY	
	NOTED	
	BY	
	DATE	

