

F.A.P. RTE. 774	SECTION •	COUNTY EFFINGHAM	TOTAL SHEETS 344	SHEET NO. 103
FED. ROAD DIST. NO. 7		ILLINOIS	FED. AID PROJECT	
*107WRS-1, 107BY, 107BY-1 & 107B-2				
CONTRACT NO. 94827				

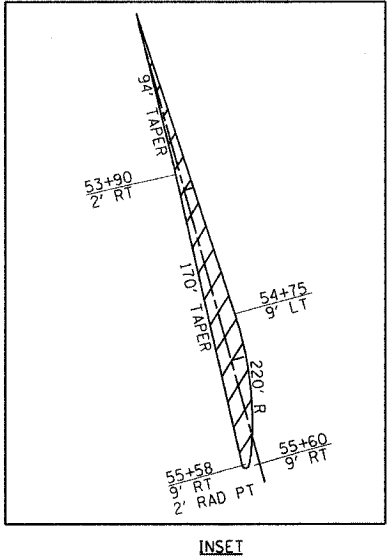
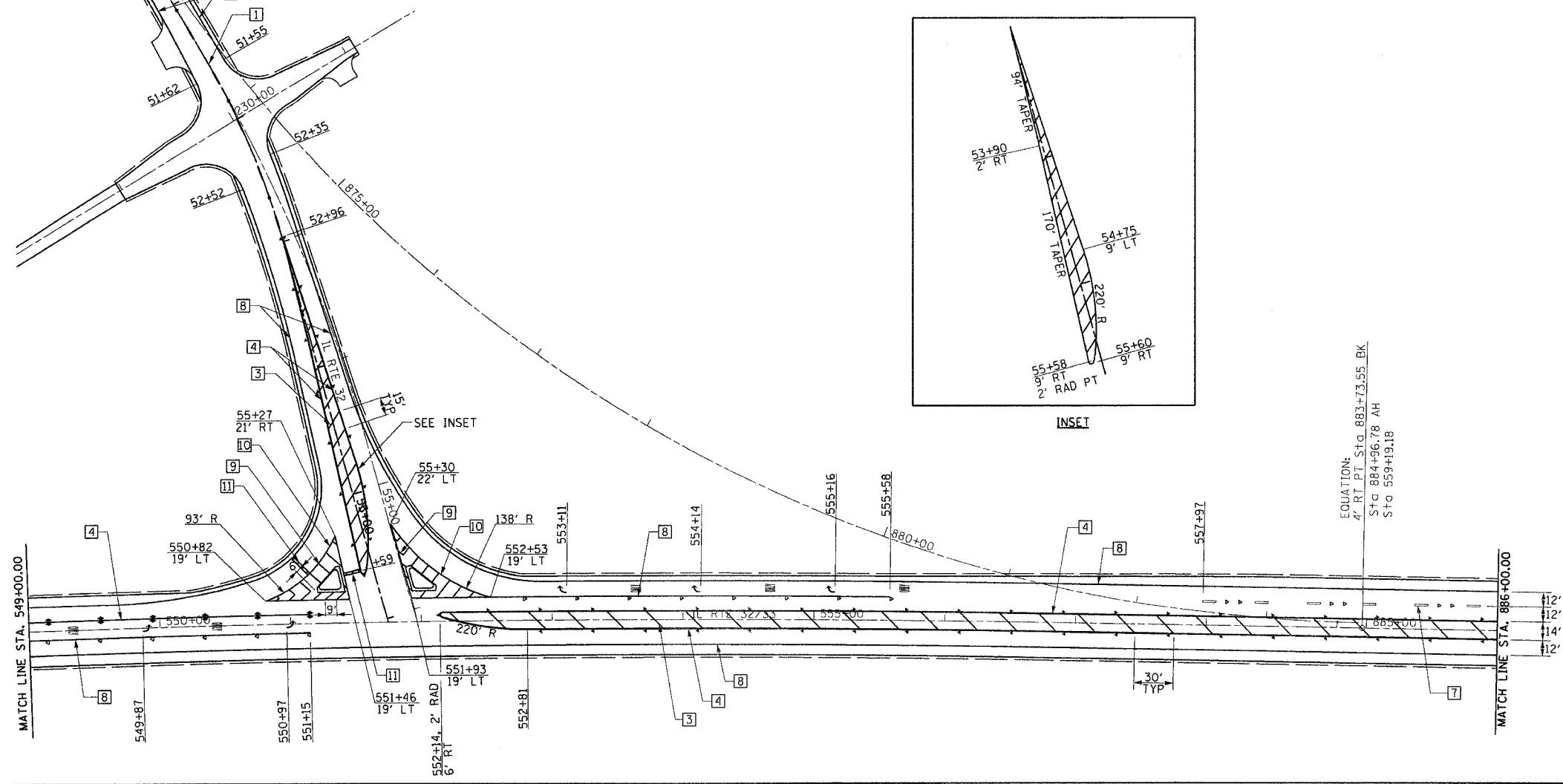
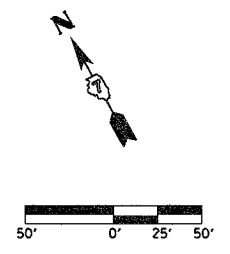
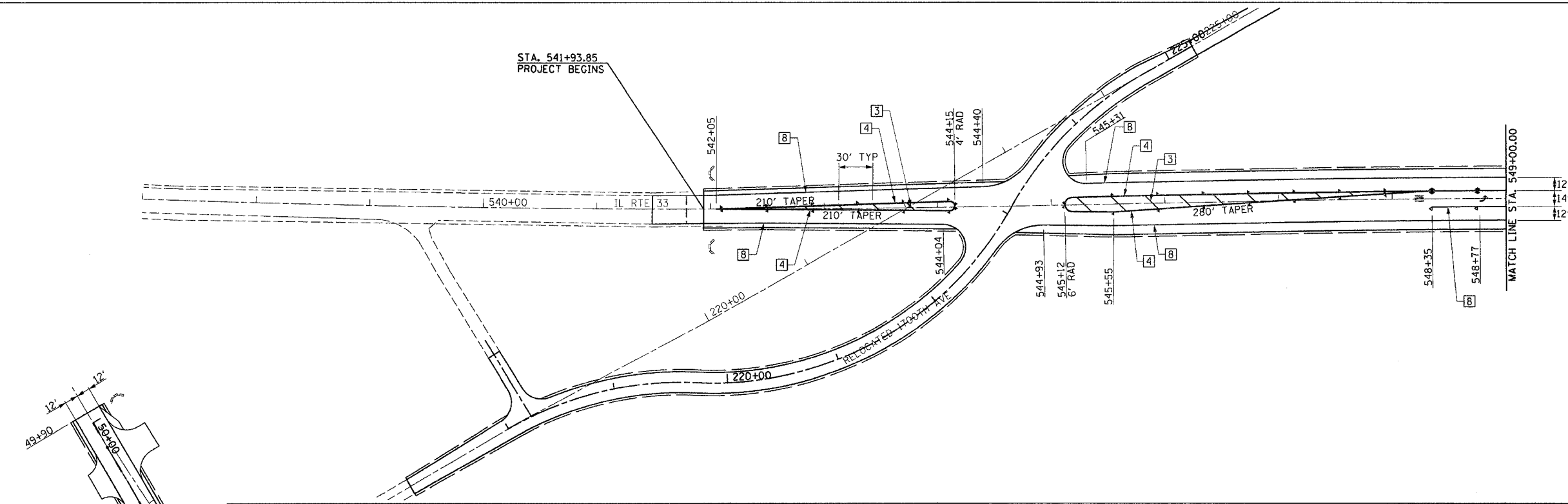

EQUATION:
4' RT PT STG 883+73.55 BK
S+G 884+96.78 AH
S+G 559+19.18

LEGEND

- RAISED REFL PAVT MKR AMBER BIDIRECTIONAL
- RAISED REFL PAVT MKR AMBER MONODIRECTIONAL
- RAISED REFL PAVT MKR CRYSTAL BIDIRECTIONAL
- RAISED REFL PAVT MKR CRYSTAL MONODIRECTIONAL
- ITEM [4] DOUBLE YELLOW (NARROW)
- ITEM [5] DOUBLE YELLOW (WIDE)

TYPICAL PAVEMENT MARKING LEGEND

- [1] 4" SKIP-DASH YELLOW
- [2] 4" SOLID YELLOW
- [3] 12" DIAGONAL YELLOW
- [4] 4" DOUBLE YELLOW NARROW
- [5] 4" DOUBLE YELLOW WIDE
- [7] 6" SKIP-DASH WHITE
- [8] 4" SOLID WHITE
- [9] 12" DIAGONAL WHITE
- [10] 6" SOLID WHITE
- [11] 24" STOP BAR WHITE

SEE STANDARDS 780001 & 781001 AND DISTRICT PAVEMENT MARKING DETAILS FOR ADDITIONAL DETAILS FOR PAVEMENT MARKING AND RAISED REFLECTIVE PAVEMENT MARKERS.

REVISIONS	
NAME	DATE

ILLINOIS DEPARTMENT OF TRANSPORTATION

**PAVEMENT MARKING PLAN
SHEET 2 OF 9**

DATE 8/02
DRAWN BY ASB
CHECKED BY SJK