

| | | | | |
|------------------------------------|---------|-----------|------------------|-----------|
| F.A.P. RTE. | SECTION | COUNTY | TOTAL SHEETS | SHEET NO. |
| 774 | * | EFFINGHAM | 344 | 104 |
| FED. ROAD DIST. NO. 7 | | ILLINOIS | FED. AID PROJECT | |
| *107WRS-1, 107BY, 107BY-1 & 107B-2 | | | | |
| CONTRACT NO. 94827 | | | | |

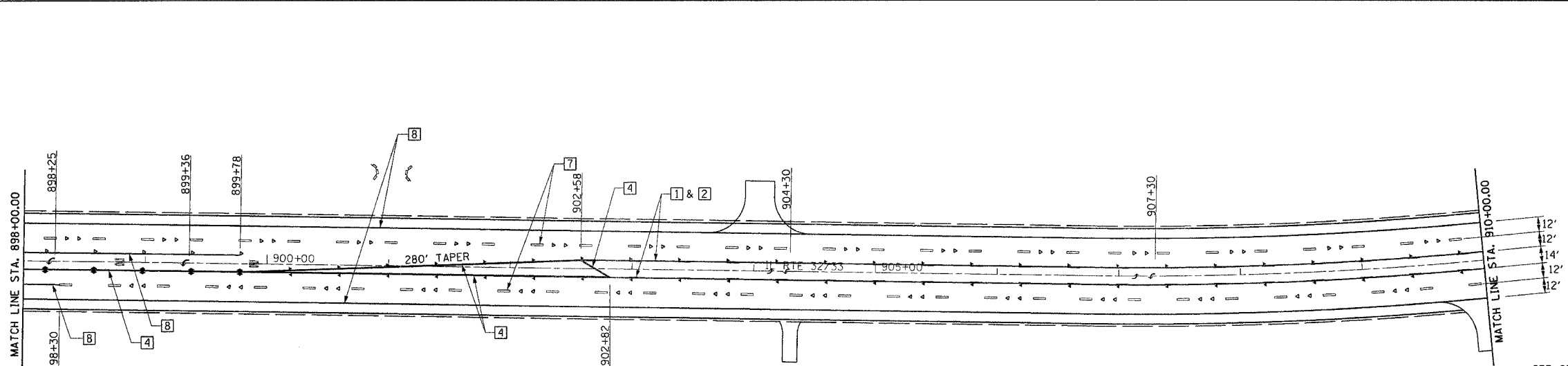
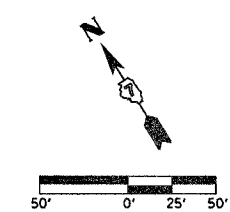
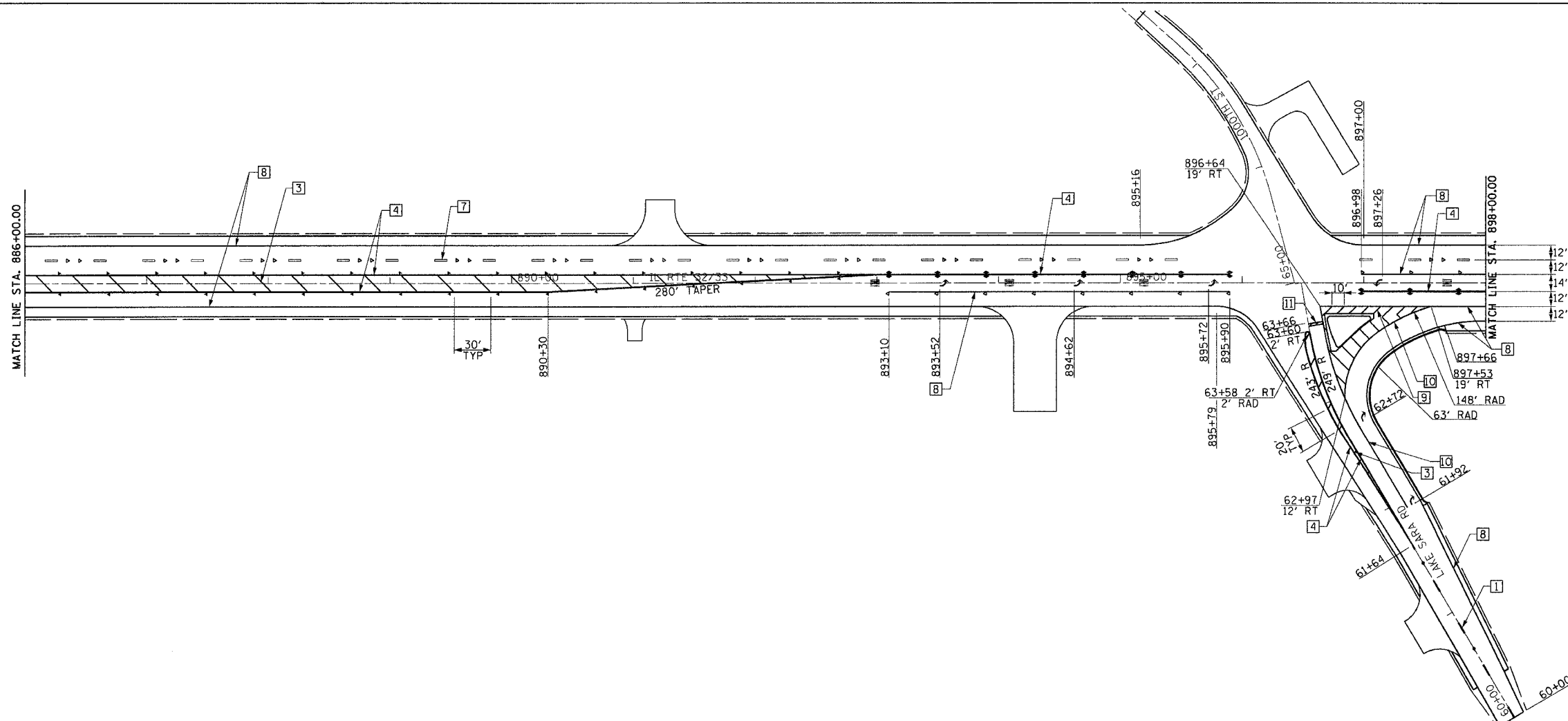

LEGEND

- RAISED REFL PAVT MKR AMBER BIDIRECTIONAL
- RAISED REFL PAVT MKR AMBER MONODIRECTIONAL
- RAISED REFL PAVT MKR CRYSTAL BIDIRECTIONAL
- RAISED REFL PAVT MKR CRYSTAL MONODIRECTIONAL
- ITEM [4] DOUBLE YELLOW (NARROW)
- ITEM [5] DOUBLE YELLOW (WIDE)

TYPICAL PAVEMENT MARKING LEGEND

| | |
|-----------------------------|-------------------------|
| [1] 4" SKIP-DASH YELLOW | [7] 6" SKIP-DASH WHITE |
| [2] 4" SOLID YELLOW | [8] 4" SOLID WHITE |
| [3] 12" DIAGONAL YELLOW | [9] 12" DIAGONAL WHITE |
| [4] 4" DOUBLE YELLOW NARROW | [10] 6" SOLID WHITE |
| [5] 4" DOUBLE YELLOW WIDE | [11] 24" STOP BAR WHITE |

| REVISIONS | |
|-----------|------|
| NAME | DATE |
| | |
| | |
| | |
| | |
| | |
| | |
| | |
| | |
| | |
| | |

SEE STANDARDS 780001 & 781001 AND DISTRICT PAVEMENT MARKING DETAILS FOR ADDITIONAL DETAILS FOR PAVEMENT MARKING AND RAISED REFLECTIVE PAVEMENT MARKERS.

ILLINOIS DEPARTMENT OF TRANSPORTATION

PAVEMENT MARKING PLAN
SHEET 3 OF 9

DATE 8/02
DRAWN BY ASB
CHECKED BY SJK