

130 120 110 100 90 80 70 60 50 40 30 20 10 0 10 20 30 40 50 60 70 80 90 100 110 120 130

F.A.P. RTE.	SECTION	COUNTY	TOTAL SHEETS	SHEET NO.
774	*	EFFINGHAM	344	224
STA. TO STA.				
FED. ROAD DIST. NO. 7 ILLINOIS FED. AID PROJECT				
107WRS-1, 107BY, 107BY-1 & 107B-2				
CONTRACT NO. 94827				
STAGE II (L.T.)			STAGE I (R.T.)	

FINAL SURVEY	SURVEYED	DATE
NOTE BOOK NO.	PLOTTED	
	TEMPLATE	
	AREAS CHECKED	

ORIGINAL SURVEY	SURVEYED	DATE
NOTE BOOK NO.	PLOTTED	
	TEMPLATE	
	AREAS CHECKED	

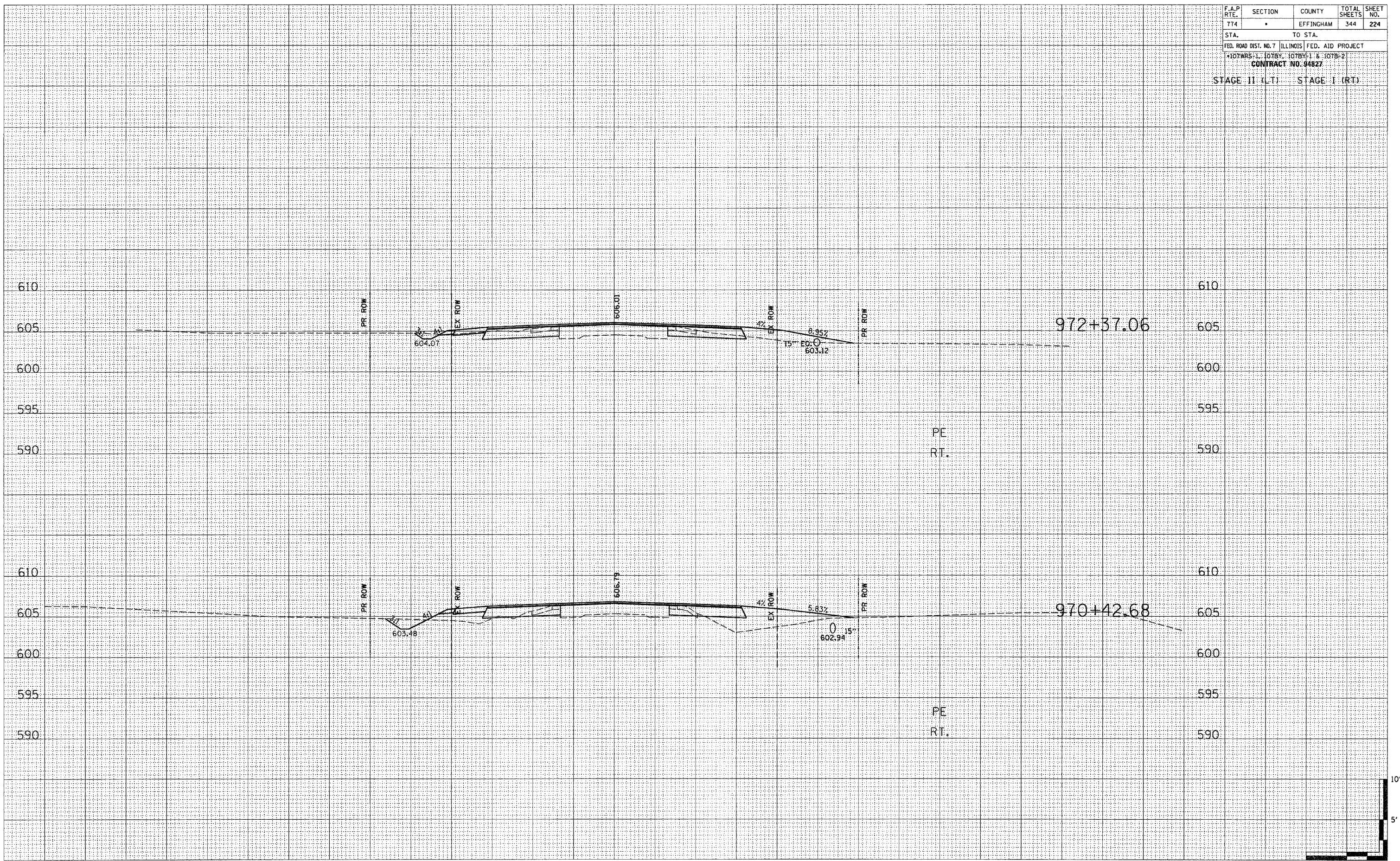

PE
RT.

PE
RT.

130 120 110 100 90 80 70 60 50 40 30 20 10 0 10 20 30 40 50 60 70 80 90 100 110 120 130

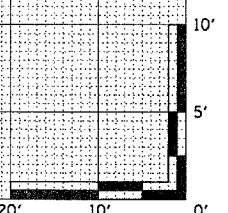

Vacuum Washed 2/24/2004 10:02:23 AM