

STATE OF ILLINOIS DEPARTMENT OF TRANSPORTATION DIVISION OF HIGHWAYS PLANS FOR PROPOSED BRIDGE REPLACEMENT AND REHABILITATION PROGRAM

ROUTE NO.	SECTION	COUNTY	TOTAL SHEETS	SHEET
F.A.S. 1870	03-00136-00-BR	JACKSON	20	1
FED. ROAD DIST. NO.		ILLINOIS	FED. AID PROJECT	

CONTRACT NO. 99203

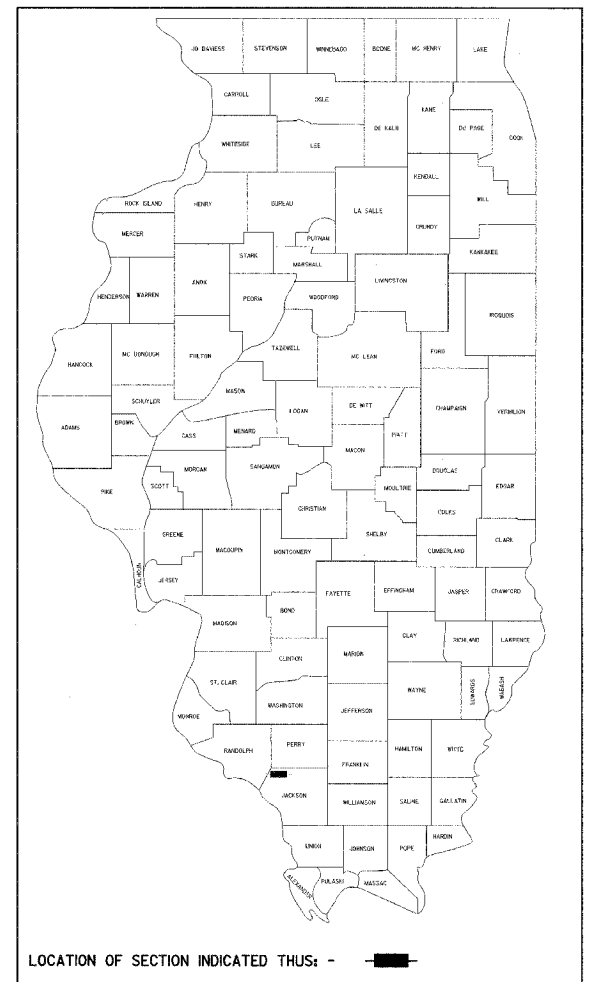

- INDEX OF SHEETS**
- COVER SHEET
 - SUMMARY OF QUANTITIES AND GENERAL NOTES
 - TYPICAL CROSS SECTIONS
 - PLAN AND PROFILE
 - 10. STATION CROSS SECTIONS
 - 19. BRIDGE PLANS
 20. BORINGS

- HIGHWAY STANDARDS:**
- 515001-02 NAME PLATE FOR BRIDGES
 - 630001-05 STEEL PLATE BEAM GUARDRAIL
 - 630301-03 SHOULDER WIDENING FOR TYPE 1 (SPECIAL) GUARDRAIL TERMINALS
 - 631026-02 TRAFFIC BARRIER TERMINAL, TYPE 5 AND 5A
 - 702001-05 TRAFFIC CONTROL DEVICES
 - BLR 21-6 TYPICAL APPLICATION OF TRAFFIC CONTROL DEVICES FOR CONSTRUCTION ON RURAL LOCAL HIGHWAYS

UTILITIES
EGYPTIAN ELECTRIC COOPERATIVE ASSOCIATION
10169 OLD HIGHWAY 13
MURPHYSBORO, ILLINOIS 62966
(618) 684-2143

DESIGN FUNCTIONAL CLASSIFICATION:
MAJOR COLLECTOR (NON URBAN)
DESIGN TRAFFIC ADT: 1150 (2004)
DESIGN SPEED: 50 M.P.H.

PLAN 0' = 50'
PROFILE HORIZ. 0' = 50'
PROFILE VERT. 0' = 5'
CROSS SECTIONS 0' = 5'

SECTION 03-00136-00-BR F.A.S. 1870 / C.H. 7 JACKSON COUNTY PROJECT BRS-1870(105) C-99-526-04

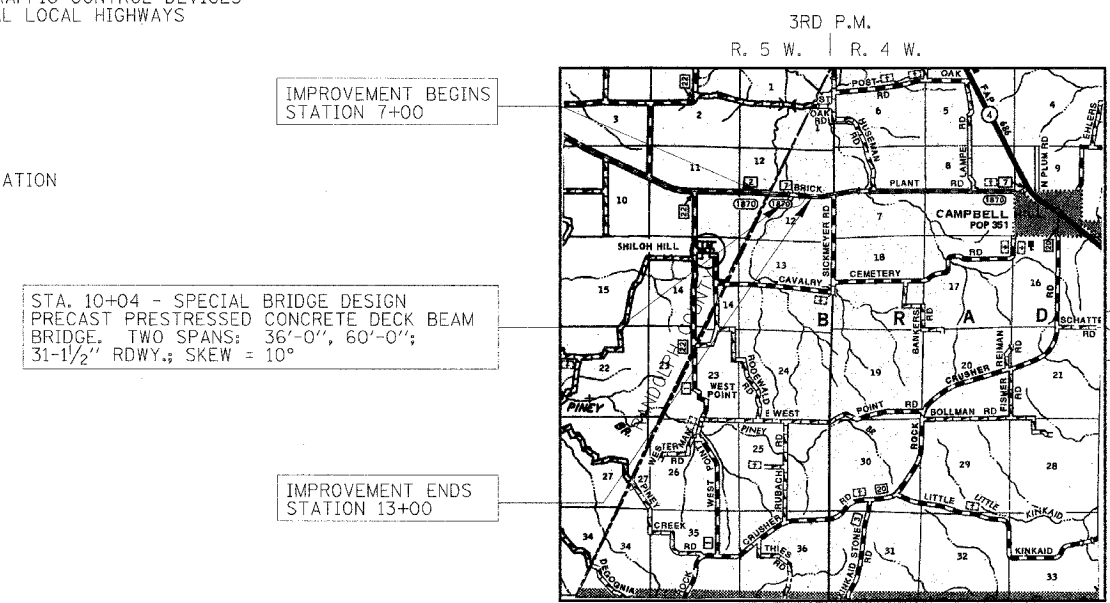

LAYOUT
APPROXIMATE SCALE: 0 = 1 MILE
NET LENGTH OF SECTION = 600 FEET = 0.114 MILES

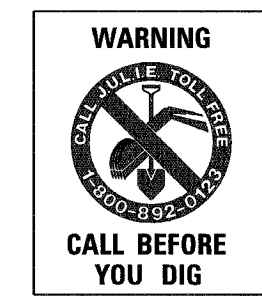

APPROVED	<i>[Signature]</i> 11-8 20.04
	COUNTY ENGINEER
PASSED	<i>[Signature]</i> 11-8 20.04
	DISTRICT ENGINEER OF LOCAL ROADS & STREETS
APPROVED	<i>[Signature]</i> November 8, 20.04
	DISTRICT ENGINEER
	STATE OF ILLINOIS DEPARTMENT OF TRANSPORTATION

DATE: *October 29, 2004*
BY: *[Signature]*
LICENSE EXPIRES: NOVEMBER 30, 2005

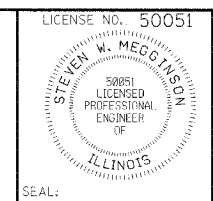

RLR
Rice, Berry and Associates
A Division of Hampton, Lenzini and Renwick, Inc.
Civil & Structural Engineers
801 S. Durkin Drive
Springfield, Illinois 62704
217-546-3400
P.O. Box 1036
DuQuoin, Illinois 62832
618-790-4637
Account Number 12-47-0016-1

...VP12470916\plans\47016\dw.dwg 10/28/2004 03:42:50 PM