

DATE	
BY	
REVIEWED	
PLOTTED	
ALLOWED	
FILE NAME	
NO.	

DATE	
BY	
REVIEWED	
PLOTTED	
ALLOWED	
FILE NAME	
NO.	

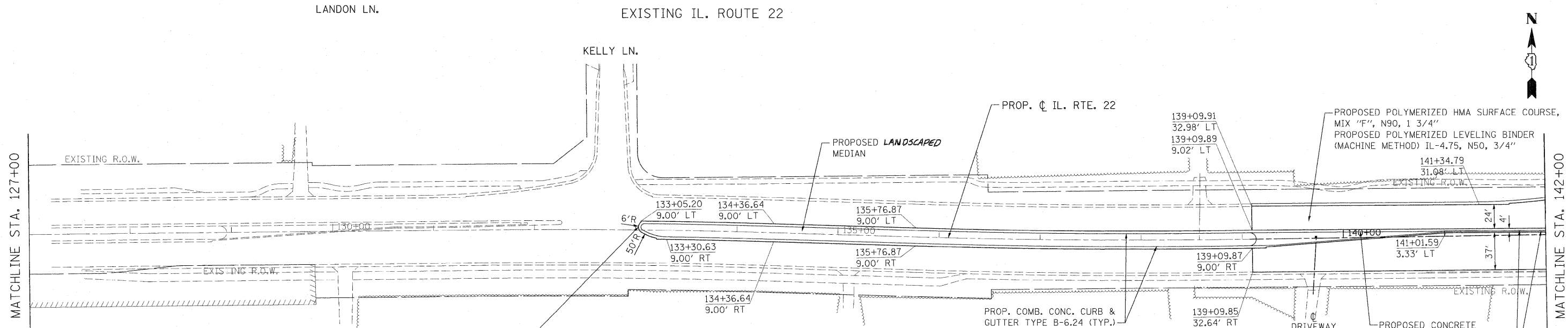
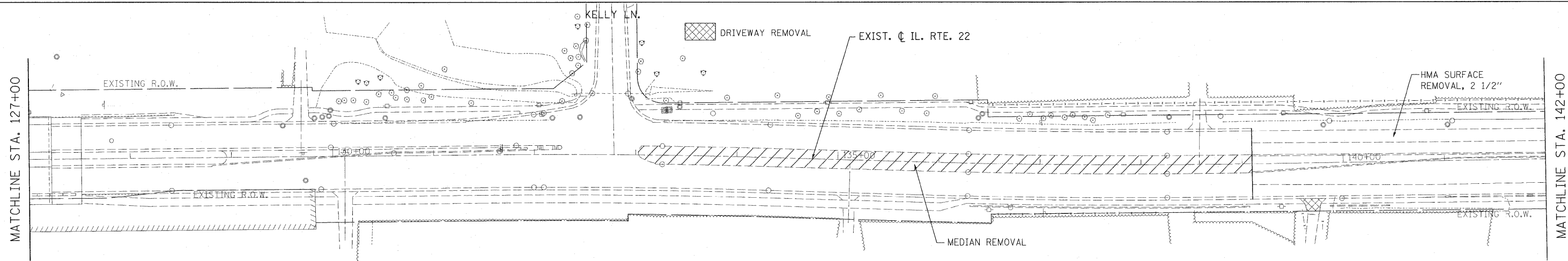

ROADWAY IMPROVEMENT BEGINS STA. 139+09.85  
PROJECT OMISSION ENDS STA. 133+02.52

DETECTABLE WARNINGS

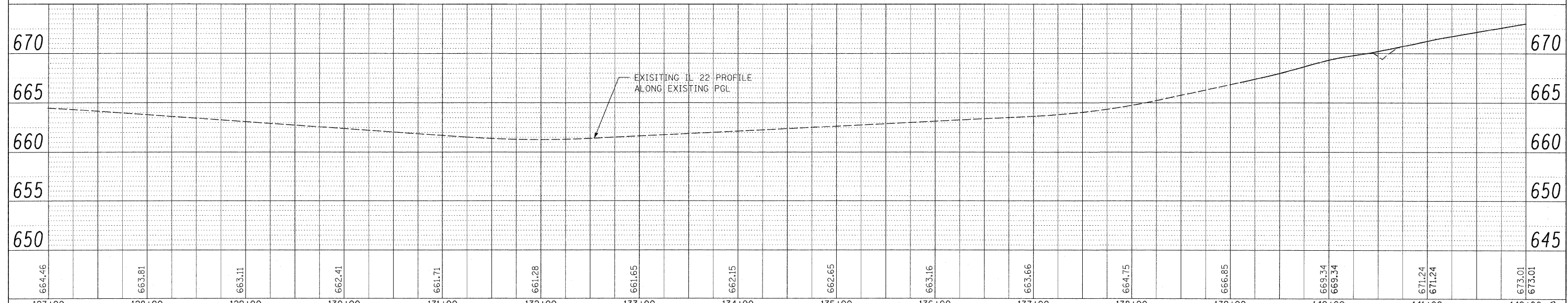

FILE NAME = W:\ILRTE22\2009 REVISIONS\CADD Sheets\0100860-sht-plnprf.dgn	USER NAME = #USER#	DESIGNED - LP	REVISOR -	<b>STATE OF ILLINOIS</b> <b>DEPARTMENT OF TRANSPORTATION</b>	<b>IL. ROUTE 22</b> <b>ROADWAY PLAN AND PROFILE</b>	F.A.P. RTE. 337	SECTION 20R-4	COUNTY LAKE	TOTAL SHEETS 232	SHEET NO. 27
PLOT SCALE = #SCALE#	DATE = 05/14/2010	CHECKED - JP	REVISOR -			CONTRACT NO. 60860				
PLOT DATE = 5/15/2010		DATE = 05/14/2010	REVISOR -			ILLINOIS FED. AID PROJECT				
						SCALE: 1"=50' SHEET NO. 27 OF 232 SHEETS STA. 127+00.00 TO STA. 142+00.00				