

DATE	
BY	
REVISION	
PLANNED	
FLOW	
ALIGNED	
CHECKED	
NO.	

DATE	
BY	
REVISION	
PROF	
GRADES	
CHECKED	
NO.	

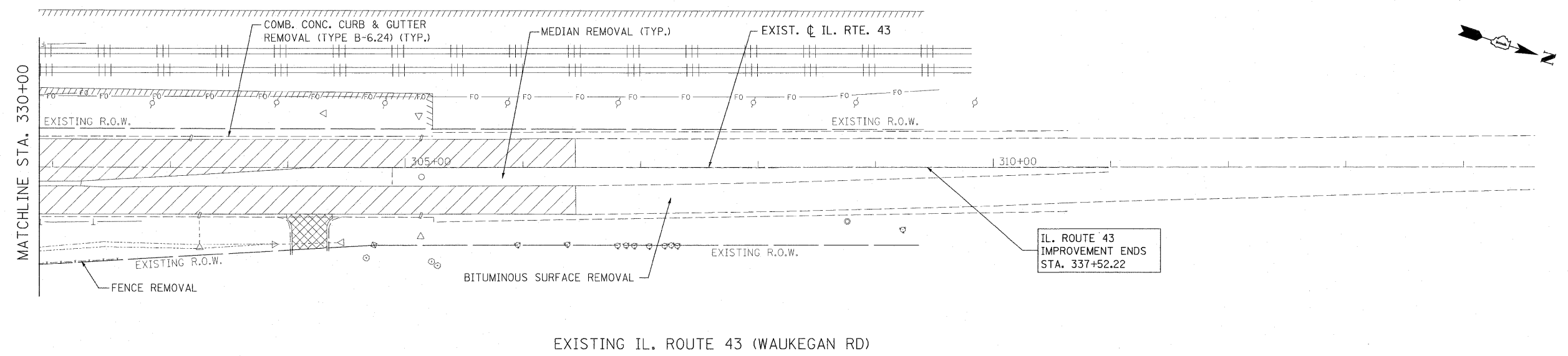

- PAVEMENT REMOVAL
- DRIVEWAY REMOVAL

EXISTING IL. ROUTE 43 (WAUKEGAN RD)

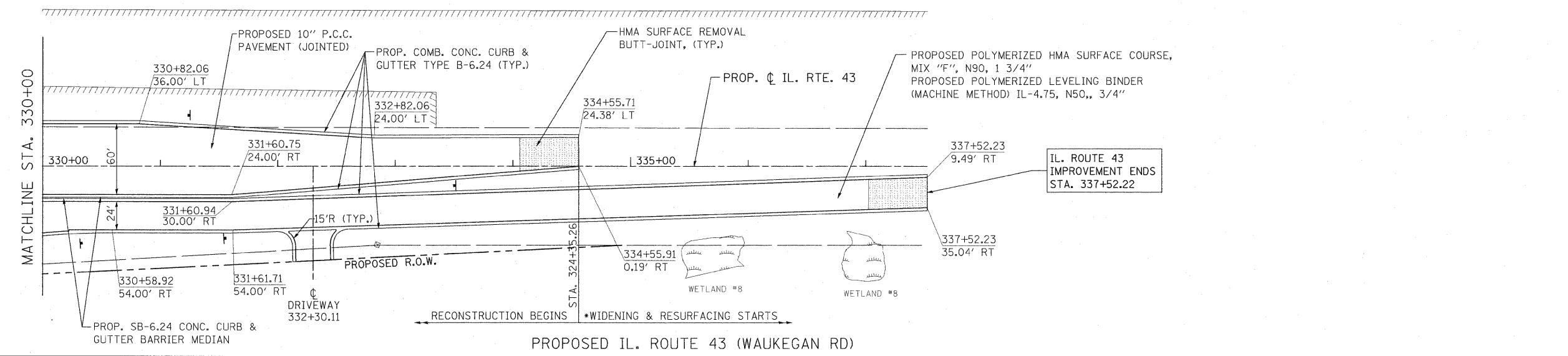

- DETECTABLE WARNINGS

PROPOSED IL. ROUTE 43 (WAUKEGAN RD)

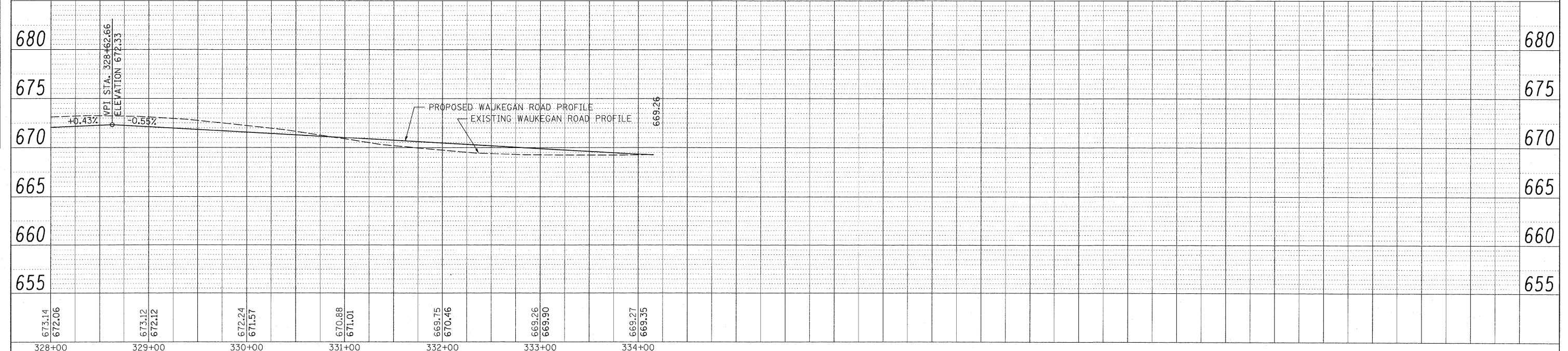

FILE NAME =	USER NAME = #USER*	DESIGNED - LP	REVISED -	<b>STATE OF ILLINOIS DEPARTMENT OF TRANSPORTATION</b>	<b>WAUKEGAN ROAD ROADWAY PLAN AND PROFILE</b>	F.A.P. RTE.	SECTION	COUNTY	TOTAL SHEETS	SHEET NO.	
W:\ILRTE22\2009 REVISIONS\CADD Sheets\DI	20860-sht-plnprf-wauk.dgn	DRAWN - DC	REVISED -			337	20R-4	LAKE	232	32	
	PLOT SCALE = #SCALE#	CHECKED - JP	REVISED -			CONTRACT NO. 60860					
	PLOT DATE = 5/15/2010	DATE - 05/14/2010	REVISED -			ILLINOIS FED. AID PROJECT					