

DATE	
BY	
REVISIONS	
NO.	
DESCRIPTION	
DATE	
BY	
NO.	
DESCRIPTION	
DATE	
BY	
NO.	
DESCRIPTION	

DATE	
BY	
REVISIONS	
NO.	
DESCRIPTION	
DATE	
BY	
NO.	
DESCRIPTION	
DATE	
BY	
NO.	
DESCRIPTION	

**LEGEND**

☒ = TREE REMOVAL

STA 116+00 TO STA 121+00  
 REMOVE EXISTING PAVEMENT  
 REGRADE AND RECONSTRUCT  
 PR HMA PAVEMENT (FULL DEPTH)  
 INCLUDING:  
 PR POLYMERIZED HMA SURFACE COURSE,  
 MIX F, N90, (IL-9.5) 2"  
 PR POLYMERIZED HMA BINDER COURSE,  
 IL-19.0, N90, 10 1/4" (IN 3 LIFTS)

REMOVE EX CURB & GUTTER  
 STA 113+57 TO STA 119+24 LT & RT  
 PR COMBINATION CONCRETE  
 CURB & GUTTER, TYPE B-6.24

REMOVE EX CURB & GUTTER  
 STA 119+64 TO STA 123+00 LT & RT  
 PR COMBINATION CONCRETE  
 CURB & GUTTER, TYPE B-6.24

REMOVE EX PARKING BLOCKS  
 PR PARKING BLOCKS  
 STA 121+00 TO STA 122+00

STA 121+00 TO STA 123+00  
 PR HOT-MIX ASPHALT SURFACE REMOVAL, 2"  
 PR POLYMERIZED HOT-MIX ASPHALT SURFACE  
 COURSE, MIX F, N90, 2"

STA 121+00 TO STA 121+50 LT & RT  
 PR 5' WIDENING INCLUDING  
 PR POROUS GRANULAR EMBANKMENT,  
 SUBGRADE 6"  
 PR AGGREGATE SUBGRADE, 12"  
 PR POLYMERIZED HMA BINDER COURSE,  
 IL-19, N90, 10 1/4" (IN 3 LIFTS)  
 PR POLYMERIZED HMA SURFACE COURSE,  
 MIX F, N90, IL 9.5, 2"

EX DRIVEWAY PAVEMENT REMOVAL  
 PR PCC PAVEMENT 8"  
 CE STA 120+37, 30' LT  
 CE STA 120+91, 30' LT  
 CE STA 122+25, 29.25' LT

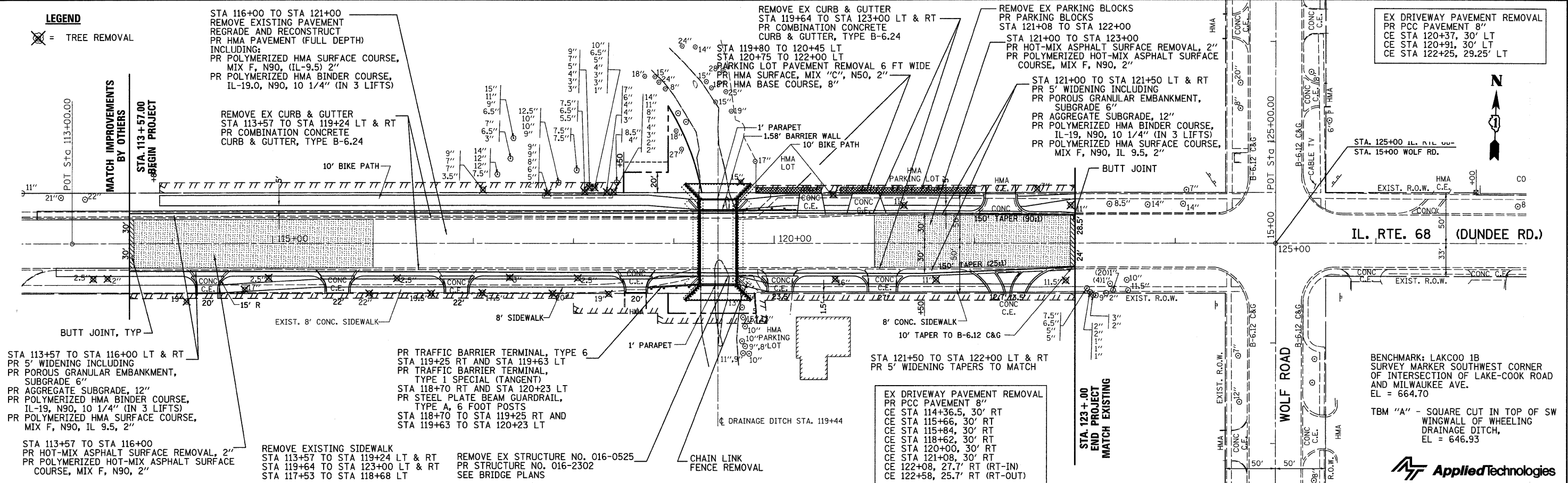

STA 113+57 TO STA 116+00 LT & RT  
 PR 5' WIDENING INCLUDING  
 PR POROUS GRANULAR EMBANKMENT,  
 SUBGRADE 6"  
 PR AGGREGATE SUBGRADE, 12"  
 PR POLYMERIZED HMA BINDER COURSE,  
 IL-19, N90, 10 1/4" (IN 3 LIFTS)  
 PR POLYMERIZED HMA SURFACE COURSE,  
 MIX F, N90, IL 9.5, 2"

REMOVE EXISTING SIDEWALK  
 STA 113+57 TO STA 119+24 LT & RT  
 STA 119+64 TO STA 123+00 LT & RT  
 STA 117+53 TO STA 118+68 LT

REMOVE EX STRUCTURE NO. 016-0525  
 PR STRUCTURE NO. 016-2302  
 SEE BRIDGE PLANS

EX DRIVEWAY PAVEMENT REMOVAL  
 PR PCC PAVEMENT 8"  
 CE STA 114+36.5, 30' RT  
 CE STA 115+66, 30' RT  
 CE STA 115+84, 30' RT  
 CE STA 118+62, 30' RT  
 CE STA 120+00, 30' RT  
 CE STA 121+08, 30' RT  
 CE 122+08, 27.7' RT (RT-IN)  
 CE 122+58, 25.7' RT (RT-OUT)

BENCHMARK: LAKCOO 1B  
 SURVEY MARKER SOUTHWEST CORNER  
 OF INTERSECTION OF LAKE-COOK ROAD  
 AND MILWAUKEE AVE.  
 EL = 664.70  
  
 TBM "A" - SQUARE CUT IN TOP OF SW  
 WINGWALL OF WHEELING  
 DRAINAGE DITCH,  
 EL = 646.93

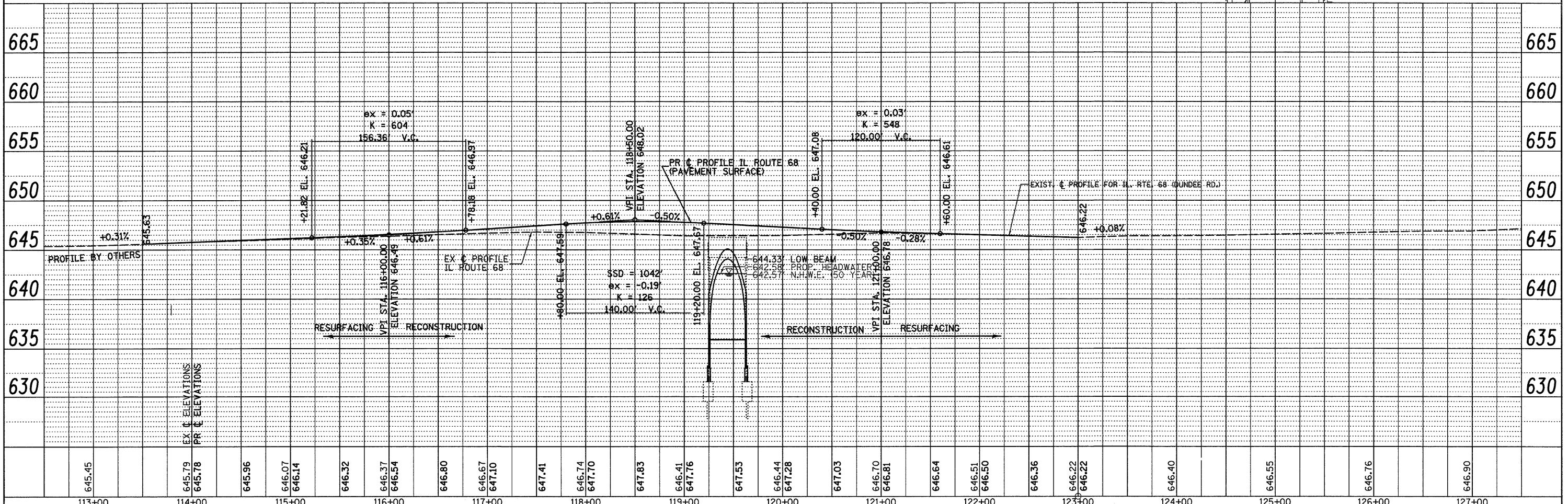

FILE NAME =	USER NAME = RDS	DESIGNED - JDD	REVISED -	<b>STATE OF ILLINOIS</b> <b>DEPARTMENT OF TRANSPORTATION</b>	<b>EXISTING AND PROPOSED PLAN AND PROFILE</b> <b>IL ROUTE 68 (DUNDEE ROAD) OVER WHEELING DRAINAGE DITCH</b>	F.A.P. RTE. 343	SECTION 98-B	COUNTY COOK	TOTAL SHEETS 65	SHEET NO. 15		
#FILE#	PLOT SCALE = 1"=50'	DRAWN - RDS	REVISED -			SCALE: 1"=50H.S.V	SHEET NO. OF SHEETS	STA. 113+57.00 TO STA. 123+00.00	FED. ROAD DIST. NO. (ILLINOIS) FED. AID PROJECT			
	PLOT DATE = 11-12-10	CHECKED -	REVISED -									
		DATE - 11-12-10	REVISED -									