

CURVE DATA FRANCIS ROAD

CURVE E.FRANC-1 PI STA. = 46+67.67 Δ = 9° 07' 28" (RT) D = 0° 58' 39" R = 5,861.01' T = 467.67' L = 933.37' E = 18.63' P.C. STA = 42+00.00 P.C.C. STA = 51+33.37	CURVE E.FRANC-2 PI STA. = 54+09.20 Δ = 7° 56' 37" (RT) D = 1° 26' 32" R = 3,972.62' T = 275.83' L = 550.78' E = 9.56' P.C.C. STA = 51+33.37 P.T. STA = 56+84.14	CURVE E.FRANC-3 PI STA. = 62+93.99 Δ = 4° 13' 59" (RT) D = 0° 43' 52" R = 7,836.13' T = 289.61' L = 578.95' E = 5.35' P.C. STA = 60+04.38 P.T. STA = 65+83.33
---	--	--

CURVE DATA F.A.I. ROUTE 80

CURVE E.180-2 PI STA. = 743+64.24 Δ = 60° 40' 37" (RT) D = 1° 15' 59" R = 4,524.31' T = 2,647.87' L = 4,791.31' E = 717.89' P.C. STA = 717+16.37 P.T. STA = 765+07.68
--

PROJECT COORDINATES

NUMBER	LOCATION	DESCRIPTION	STATION	NORTHING	EASTING
3	E.FRANC	P.C. STA 42+00.00	42+00.00	1771781.374	1078275.839
4	E.FRANC	P.C.C. STA 51+33.37	51+33.37	1771916.005	1079198.448
5	E.FRANC	P.T. STA 56+84.14	56+84.14	1771909.528	1079748.746
6	E.FRANC	P.C. STA 60+04.38	60+04.38	1771887.625	1080068.235
7	E.FRANC	P.T. STA 65+83.33	65+83.33	1771822.100	1080643.334

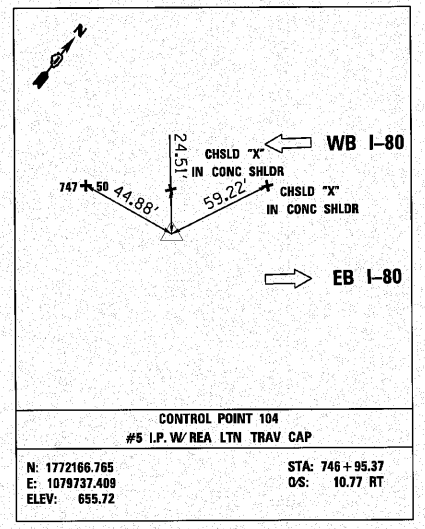
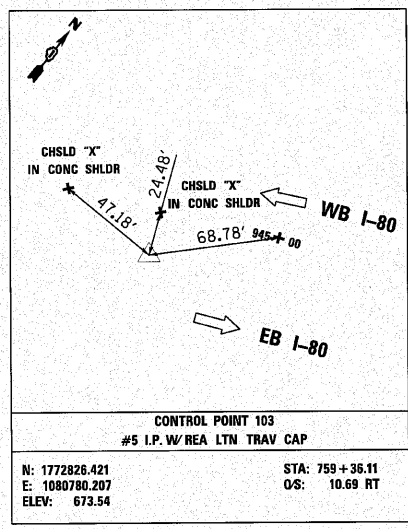
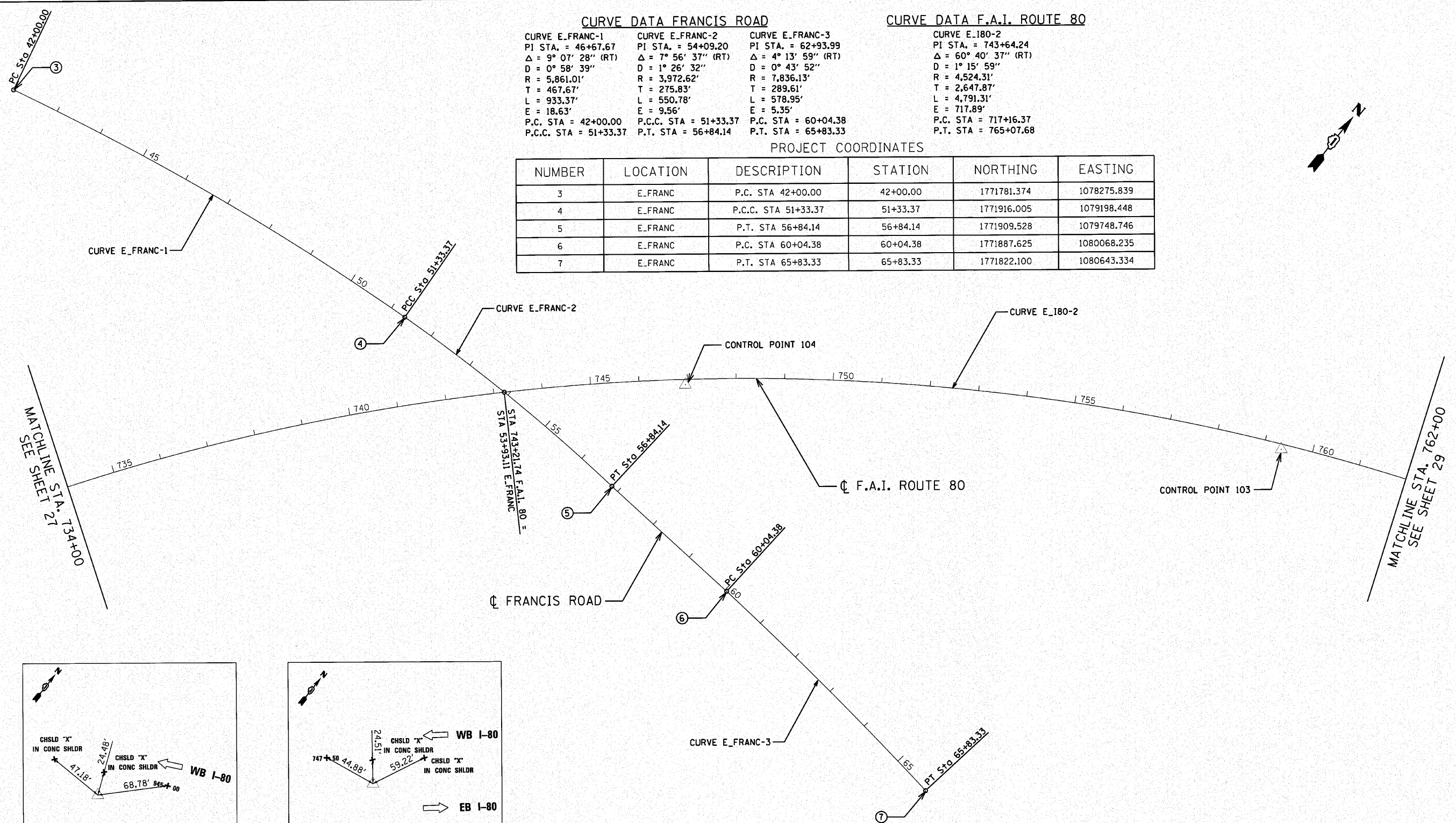
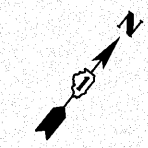

BM#	DESCRIPTION	ELEVATION
BM3	CHISELED "X" TOP OF NORTHERN MOST BOLT OF SIGN FOUNDATION. SIGN READS EXIT 140 355 NORTH TOLLWAY 1 MILE. 120' WEST OF FRANCIS ROAD OVERPASS.	652.92
BM4	CHISELED SQUARE NORTHERN MOST SIGN POST FOUNDATION. SIGN READS SW HWY USE 355 NORTH. 50' EAST OF STAMPED STATION 755+00.	667.14

n:\proj\3384\2-west\dmu\m\sheet\3384\11\align11esb2.dgn