

- LEGEND**
- PERIMETER EROSION BARRIER
 - OUTLET FLOW
 - ⊗ INLET PROTECTION
 - ◇ TEMPORARY DITCH CHECK
 - ▨ TEMPORARY EROSION CONTROL SEEDING
 - ▩ TEMPORARY MULCH
 - ▧ STONE RIP RAP WITH FILTER FABRIC

NOTE:
CONTRACTOR SHALL PROVIDE INLET PROTECTION TO ALL PROPOSED INLETS LOCATED WITHIN THE PROJECT LIMITS.

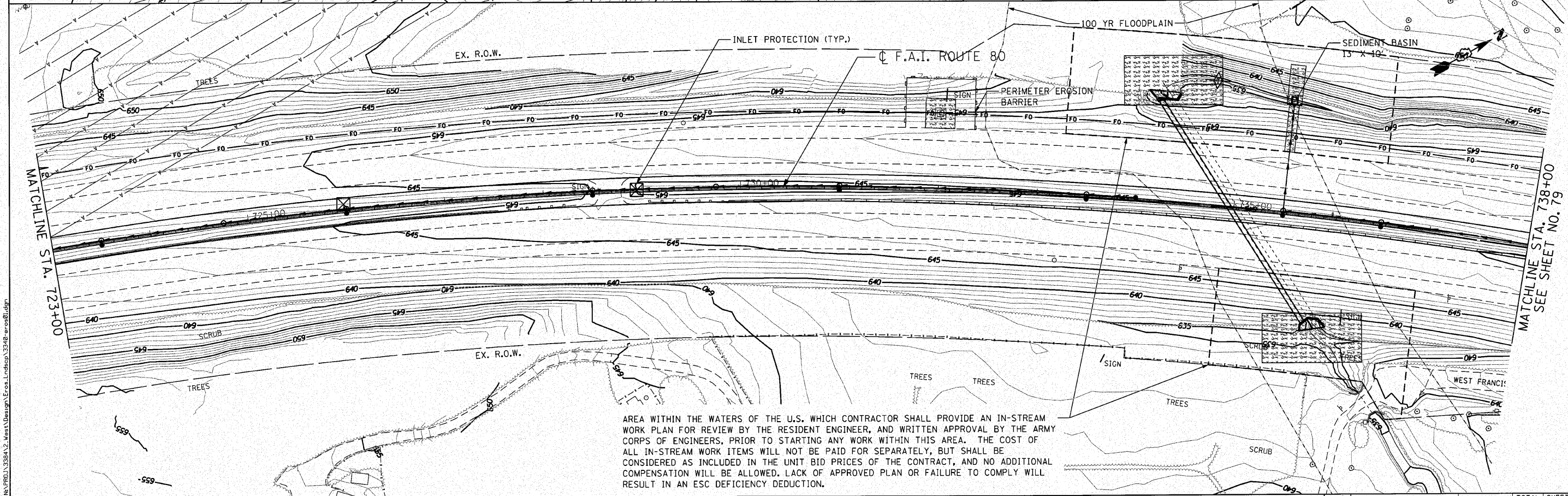

AREA WITHIN THE WATERS OF THE U.S. WHICH CONTRACTOR SHALL PROVIDE AN IN-STREAM WORK PLAN FOR REVIEW BY THE RESIDENT ENGINEER, AND WRITTEN APPROVAL BY THE ARMY CORPS OF ENGINEERS, PRIOR TO STARTING ANY WORK WITHIN THIS AREA. THE COST OF ALL IN-STREAM WORK ITEMS WILL NOT BE PAID FOR SEPARATELY, BUT SHALL BE CONSIDERED AS INCLUDED IN THE UNIT BID PRICES OF THE CONTRACT, AND NO ADDITIONAL COMPENSATION WILL BE ALLOWED. LACK OF APPROVED PLAN OR FAILURE TO COMPLY WILL RESULT IN AN ESC DEFICIENCY DEDUCTION.

ENGINEERING CONSULTANT
Clorba Group, Inc.
 CONSULTING ENGINEERS
 6507 North Commercial Avenue, Suite 402
 Chicago, Illinois 60630
 Tel: 773 775 4000 Fax: 773 775 4014
 Email: gclorba@clorba.com

USER NAME = dmorr1s	DESIGNED - CRC	REVISED -
PLOT SCALE = 50.0000' / IN.	DRAWN - JMK	REVISED -
PLOT DATE = 12/6/2010	CHECKED - MRJ	REVISED -
	DATE - 10/27/2010	REVISED -

STATE OF ILLINOIS
DEPARTMENT OF TRANSPORTATION

F.A.I. 80 FROM US 30 TO NS RAILROAD
EROSION AND SEDIMENT CONTROL PLAN
 SCALE: 1" = 50' SHEET NO. OF SHEETS STA. 710+60 TO STA. 738+00

F.A.I. RTE. 80	SECTION 99-5-Y	COUNTY WILL	TOTAL SHEETS 276	SHEET NO. 78
			CONTRACT NO. 60147	
ILLINOIS FED. AID PROJECT				

M:\PROJ\328A\2-West\Design\Eros_Landslp_332.dwg - 10/27/10