

CONSTRUCTION NOTES:

- ① INSTALL UNINTERRUPTIBLE POWER SUPPLY UNIT ON LEFT SIDE OF EXISTING CONTROLLER.
- ② ALL CABINET MODIFICATION AND/OR LOAD SWITCH REPLACEMENTS REQUIRED FOR PROPER OPERATION OF THE LED SIGNAL INDICATORS TO THE SATISFACTION OF THE ENGINEER SHALL BE INCIDENTAL TO THE PAY ITEM: UNINTERRUPTIBLE POWER SUPPLY.
- ③ INSTALL NEW SERVICE INSTALLATION - POLE MOUNT

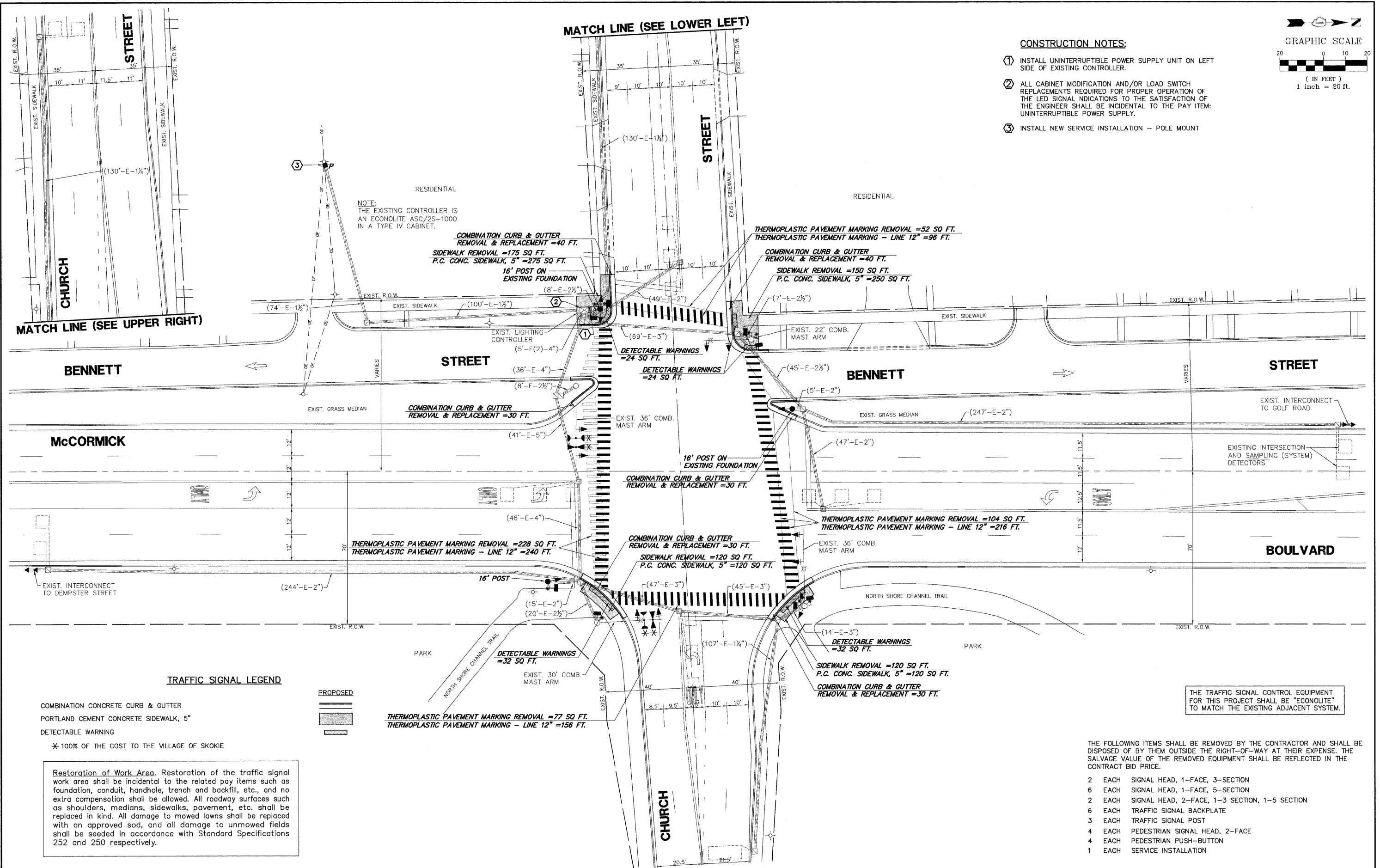

FILE NAME = McCORMICK@CHURCH.dwg

USER NAME = ZACH WALLSTEN
 DESIGNED - JRD
 DRAWN - ZCW
 CHECKED - KLB
 DATE - 10/29/2010

REVISD -
 REVISD -
 REVISD -
 REVISD -

**STATE OF ILLINOIS
 DEPARTMENT OF TRANSPORTATION**

**TRAFFIC SIGNAL MODERNIZATION PLAN
 McCORMICK BOULEVARD AT CHURCH STREET**

SCALE: 1"=20' SHEET NO. OF SHEETS STA. TO STA.

FAP RTE.	SECTION	COUNTY	TOTAL SHEETS	SHEET NO.
VARIES	2010-006TS	COOK	58	24
CONTRACT #:			60K24	
ILLINOIS FED. AID PROJECT				

GHA #4085.867