

- ① EXIST. TERMINAL SECTION TO BE REPLACED WITH NEW TYPE 1 (SPECIAL) - TANGENT 50 FT LONG. SEE STANDARD 630301 & DISTRICT DETAIL (RD-34).
- OTHER PAY ITEMS WITH QUANTITIES ESTIMATED FOR THIS AREA INCLUDE:
- REMOVAL & DISPOSAL OF UNSUITABLE MATERIAL
 - FURNISHED EXCAVATION
 - TOP SOIL FURNISH AND PLACE, 4"
 - SEEDING, CLASS 2A
 - NITROGEN FERTILIZER NUTRIENT
 - PHOSPHORUS FERTILIZER NUTRIENT
 - POTASSIUM FERTILIZER NUTRIENT
 - EROSION CONTROL BLANKET
 - AGGREGATE SHOULDER, TYPE B - 10"
 - GUARDRAIL REMOVAL

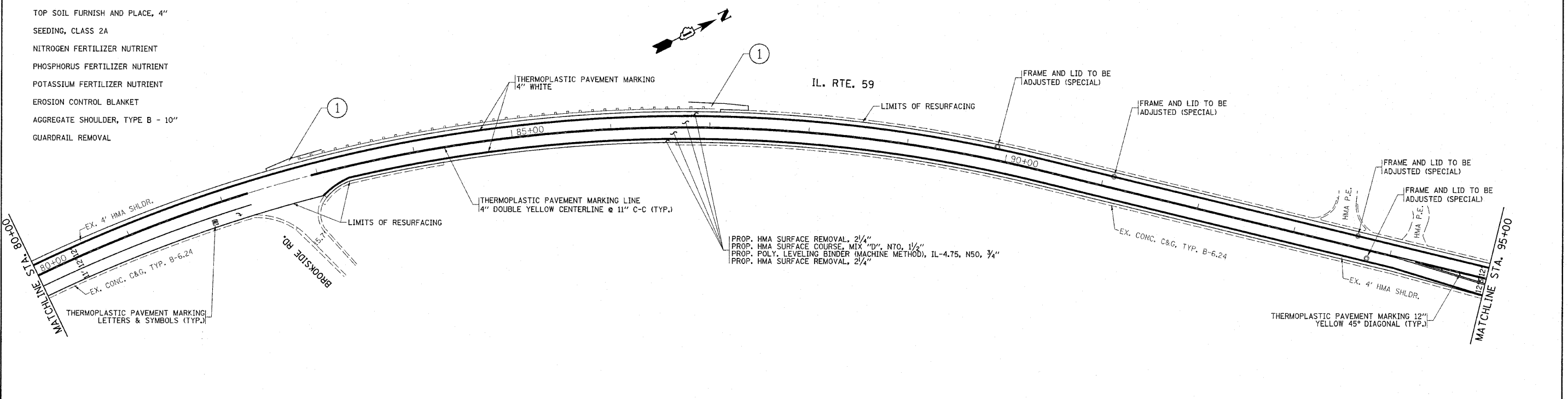

FILE NAME =	USER NAME = hamdanah	DESIGNED -	REVISED -	STATE OF ILLINOIS DEPARTMENT OF TRANSPORTATION	ROADWAY AND PAVEMENT MARKING PLAN IL. RTE. 59 FROM IL. RTE. 22 TO U.S. RTE 12 (RAND RD.)	F.A.P. RTE.	SECTION	COUNTY	TOTAL SHEETS	SHEET NO.	
c:\pw_work\pwsdot\hamdanah\0223594\011	111-sht-plan06	DRAWN -	REVISED -			338	107-RS-3	LAKE	30	7	
PLOT SCALE = 50.0000' / IN.		CHECKED -	REVISED -			CONTRACT NO. 60M58					
PLOT DATE = 12/11/2010		DATE -	REVISED -			ILLINOIS FED. AID PROJECT					

Rev. Sheet 1-3-11