

SUMMARY OF QUANTITIES					CONSTRUCTION TYPE CODE					SUMMARY OF QUANTITIES					CONSTRUCTION TYPE CODE				
CODE NO	ITEM	UNIT	URBAN TOTAL QUANTITIES	STATE 100% 0005						CODE NO	ITEM	UNIT	URBAN TOTAL QUANTITIES	STATE 100% 0005					
20201200	REMOVAL AND DISPOSAL OF UNSUITABLE MATERIAL	CU YD	867	867						70300210	TEMPORARY PAVEMENT MARKING - LETTERS AND SYMBOLS	SO FT	2012	2012					
20400800	FURNISHED EXCAVATION	CU YD	1020	1020						70300220	TEMPORARY PAVEMENT MARKING - LINE 4"	FOOT	99105	99105					
21101615	TOPSOIL FURNISH AND PLACE, 4"	SO YD	1734	1734						70300240	TEMPORARY PAVEMENT MARKING - LINE 6"	FOOT	4033	4033					
25000210	SEEDING, CLASS 2A	ACRE	0.37	0.37						70300260	TEMPORARY PAVEMENT MARKING - LINE 12"	FOOT	1474	1474					
25000400	NITROGEN FERTILIZER NUTRIENT	POUND	33	33						70300280	TEMPORARY PAVEMENT MARKING - LINE 24"	FOOT	224	224					
25000500	PHOSPHORUS FERTILIZER NUTRIENT	POUND	33	33						* 78000100	THERMOPLASTIC PAVEMENT MARKING - LETTERS AND SYMBOLS	SO FT	2010	2010					
25000600	POTASSIUM FERTILIZER NUTRIENT	POUND	33	33						* 78000200	THERMOPLASTIC PAVEMENT MARKING - LINE 4"	FOOT	99105	99105					
25100630	EROSION CONTROL BLANKET	SO YD	2074	2074						* 78000400	THERMOPLASTIC PAVEMENT MARKING - LINE 6"	FOOT	4033	4033					
40600200	BITUMINOUS MATERIALS (PRIME COAT)	TON	44	44						* 78000500	THERMOPLASTIC PAVEMENT MARKING - LINE 8"	FOOT	130	130					
40600300	AGGREGATE (PRIME COAT)	TON	198	198						* 78000600	THERMOPLASTIC PAVEMENT MARKING - LINE 12"	FOOT	1474	1474					
40600400	MIXTURE FOR CRACKS, JOINTS, AND FLANGEWAYS	TON	30	30						* 78000650	THERMOPLASTIC PAVEMENT MARKING - LINE 24"	FOOT	224	224					
40600895	CONSTRUCTING TEST STRIP	EACH	2	2						* 78100100	RAISED REFLECTIVE PAVEMENT MARKER	EACH	1245	1245					
40600982	HOT-MIX ASPHALT SURFACE REMOVAL - BUTT JOINT	SO YD	606.8	606.8						* 78201000	TERMINAL MARKER - DIRECT APPLIED	EACH	14	14					
40603340	HOT-MIX ASPHALT SURFACE COURSE, MIX "D", N70	TON	8280	8280						78300200	RAISED REFLECTIVE PAVEMENT MARKER REMOVAL	EACH	1150	1150					
42001300	PROTECTIVE COAT	SO YD	66.7	66.7						* 88600600	DETECTOR LOOP REPLACEMENT	FOOT	1860	1860					
44000158	HOT-MIX ASPHALT SURFACE REMOVAL, 2 1/4"	SO YD	98571	98571						X2020110	GRADING AND SHAPING SHOULDERS	UNIT	137	137					
44000500	COMBINATION CURB AND GUTTER REMOVAL	FOOT	200	200						X4060826	POLYMERIZED LEVELING BINDER (MACHINE METHOD), IL-4.75, N50	TON	3998	3998					
44201798	CLASS D PATCHES, TYPE I, 13 INCH	SO YD	936	936						X7012620	TRAFFIC CONTROL AND PROTECTION, STANDARD 701501	EACH	1	1					
44201803	CLASS D PATCHES, TYPE II, 13 INCH	SO YD	1690	1690						Z0030850	TEMPORARY INFORMATION SIGNING	SO FT	205.6	205.6					
44201807	CLASS D PATCHES, TYPE III, 13 INCH	SO YD	1666	1666						Z0004562	COMBINATION CONCRETE CURB AND GUTTER REMOVAL AND REPLACEMENT	FOOT	1880	1880					
44201809	CLASS D PATCHES, TYPE IV, 13 INCH	SO YD	2310	2310															
48101620	AGGREGATE SHOULDERS, TYPE B 10"	SO YD	255	255															
48102100	AGGREGATE WEDGE SHOULDER, TYPE B	TON	1307	1307															
X6030310	FRAMES AND LIDS TO BE ADJUSTED (SPECIAL)	EACH	10	10															
60605000	COMBINATION CONCRETE CURB AND GUTTER, TYPE B-6, 24	FOOT	200	200															
* 63100167	TRAFFIC BARRIER TERMINAL, TYPE I (SPECIAL) TANGENT	EACH	14	14															
63200310	GUARDRAIL REMOVAL	FOOT	850	850															
67000400	ENGINEER'S FIELD OFFICE, TYPE A	CAL MO	5	5															
67100100	MOBILIZATION	L SUM	1	1															
70100450	TRAFFIC CONTROL AND PROTECTION, STANDARD 701201	L SUM	1	1															
70102625	TRAFFIC CONTROL AND PROTECTION, STANDARD 701606	L SUM	1	1															
70100460	TRAFFIC CONTROL AND PROTECTION, STANDARD 701326	L SUM	1	1															
70102635	TRAFFIC CONTROL AND PROTECTION, STANDARD 701701	L SUM	1	1															
70300100	SHORT TERM PAVEMENT MARKING	FOOT	13526	13526															

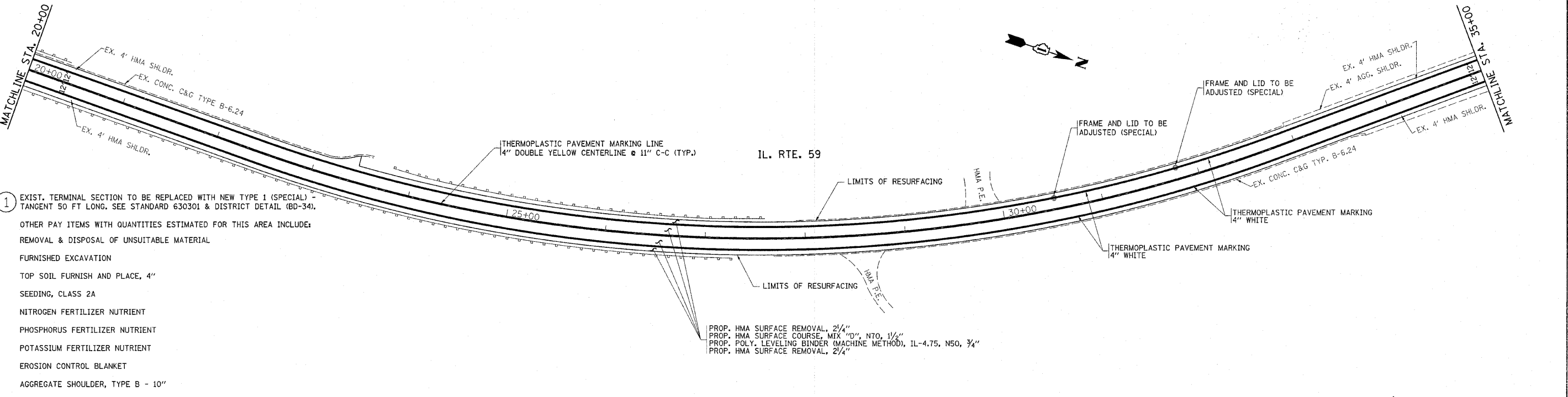
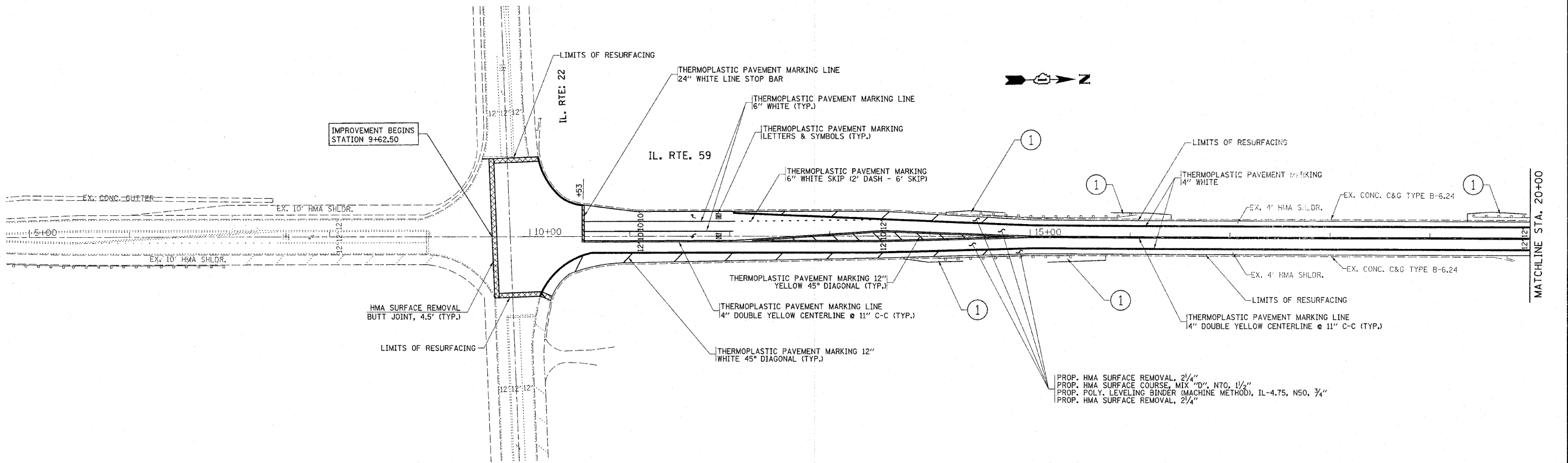

- ① EXIST. TERMINAL SECTION TO BE REPLACED WITH NEW TYPE 1 (SPECIAL) - TANGENT 50 FT LONG. SEE STANDARD 630301 & DISTRICT DETAIL (BD-34).
- OTHER PAY ITEMS WITH QUANTITIES ESTIMATED FOR THIS AREA INCLUDE:
- REMOVAL & DISPOSAL OF UNSUITABLE MATERIAL
- FURNISHED EXCAVATION
- TOP SOIL FURNISH AND PLACE, 4"
- SEEDING, CLASS 2A
- NITROGEN FERTILIZER NUTRIENT
- PHOSPHORUS FERTILIZER NUTRIENT
- POTASSIUM FERTILIZER NUTRIENT
- EROSION CONTROL BLANKET
- AGGREGATE SHOULDER, TYPE B - 10"
- GUARDRAIL REMOVAL

PROP. HMA SURFACE REMOVAL, 2 1/4"
 PROP. HMA SURFACE COURSE, MIX "D", N70, 1 1/2"
 PROP. POLY. LEVELING BINDER (MACHINE METHOD), IL-4.75, N50, 3/4"
 PROP. HMA SURFACE REMOVAL, 2 1/4"

FILE NAME =	USER NAME = hmandenh	DESIGNED -	REVISED -	STATE OF ILLINOIS DEPARTMENT OF TRANSPORTATION	ROADWAY AND PAVEMENT MARKING PLAN IL. RTE. 59 FROM IL. RTE. 22 TO U.S. RTE 12 (RAND RD.)			F.A.P. RTE.	SECTION	COUNTY	TOTAL SHEETS	SHEET NO.
ct:\pw_work\pw\dot\hmandenh\d8223594\011	ill-shrt-plan.dgn	DRAWN -	REVISED -					338	107-RS-3	LAKE	30	5
	PLOT SCALE = 50.0000' / 1" IN.	CHECKED -	REVISED -					CONTRACT NO. 60M58				
	PLOT DATE = 12/11/2010	DATE -	REVISED -					ILLINOIS FED. AID PROJECT				

Rev. Sheet 1-3-11

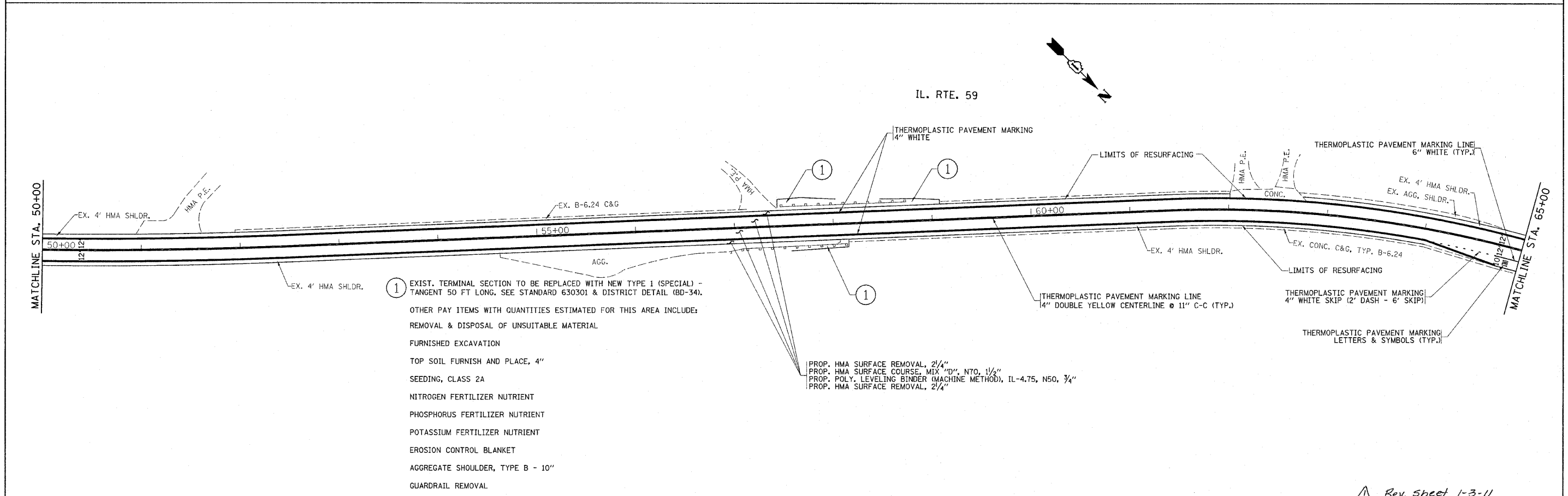
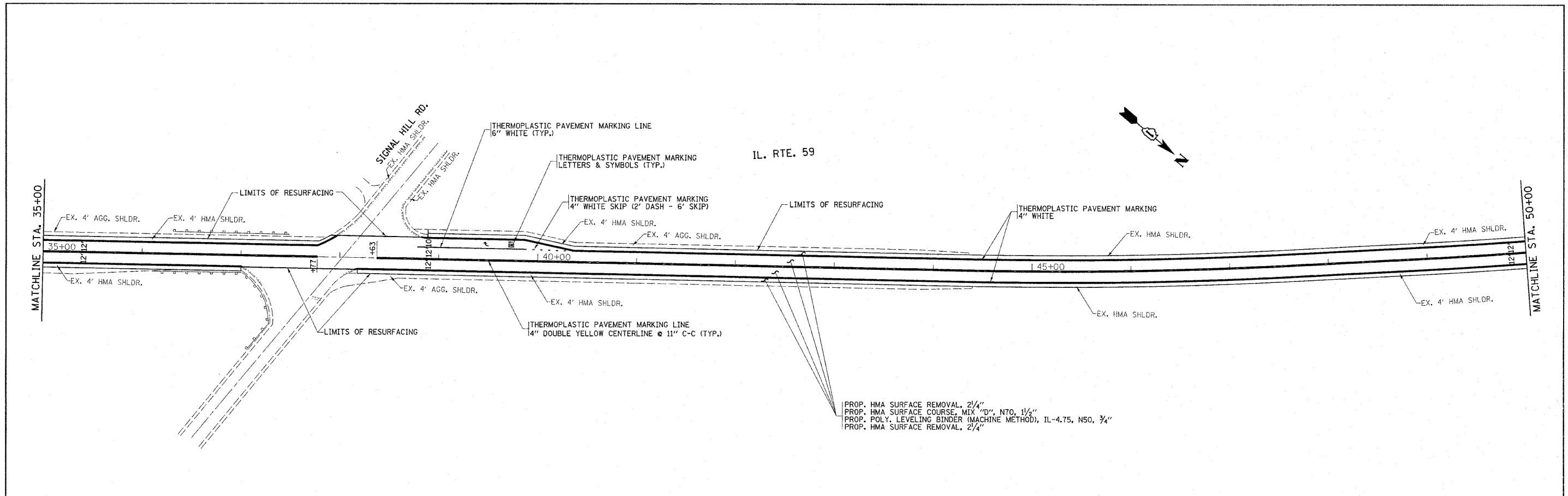

- ① EXIST. TERMINAL SECTION TO BE REPLACED WITH NEW TYPE 1 (SPECIAL) - TANGENT 50 FT LONG. SEE STANDARD 630301 & DISTRICT DETAIL (8D-34).
- OTHER PAY ITEMS WITH QUANTITIES ESTIMATED FOR THIS AREA INCLUDE:
- REMOVAL & DISPOSAL OF UNSUITABLE MATERIAL
 - FURNISHED EXCAVATION
 - TOP SOIL FURNISH AND PLACE, 4"
 - SEEDING, CLASS 2A
 - NITROGEN FERTILIZER NUTRIENT
 - PHOSPHORUS FERTILIZER NUTRIENT
 - POTASSIUM FERTILIZER NUTRIENT
 - EROSION CONTROL BLANKET
 - AGGREGATE SHOULDER, TYPE B - 10"
 - GUARDRAIL REMOVAL

PROP. HMA SURFACE REMOVAL, 2 1/4"
 PROP. HMA SURFACE COURSE, MIX "D", N70, 1 1/2"
 PROP. POLY. LEVELING BINDER (MACHINE METHOD), IL-4.75, N50, 3/4"
 PROP. HMA SURFACE REMOVAL, 2 1/4"

PROP. HMA SURFACE REMOVAL, 2 1/4"
 PROP. HMA SURFACE COURSE, MIX "D", N70, 1 1/2"
 PROP. POLY. LEVELING BINDER (MACHINE METHOD), IL-4.75, N50, 3/4"
 PROP. HMA SURFACE REMOVAL, 2 1/4"

FILE NAME =	USER NAME = hmdenh	DESIGNED -	REVISED -	STATE OF ILLINOIS DEPARTMENT OF TRANSPORTATION	ROADWAY AND PAVEMENT MARKING PLAN IL. RTE. 59 FROM IL. RTE. 22 TO U.S. RTE 12 (RAND RD.)				F.A.P. RTE.	SECTION	COUNTY	TOTAL SHEETS	SHEET NO.
c:\pv\work\p\dot\hmdenh\d0223594\011111-sht-plan.dgn		DRAWN -	REVISED -		338	107-RS-3	LAKE	30	6				
PLOT SCALE = 50.0000' / IN.		CHECKED -	REVISED -		CONTRACT NO. 60M58				ILLINOIS FED. AID PROJECT				
PLOT DATE = 12/11/2010		DATE -	REVISED -		SCALE:	SHEET NO.	OF SHEETS	STA.	TO STA.				

Rev Sheet 1-3-11

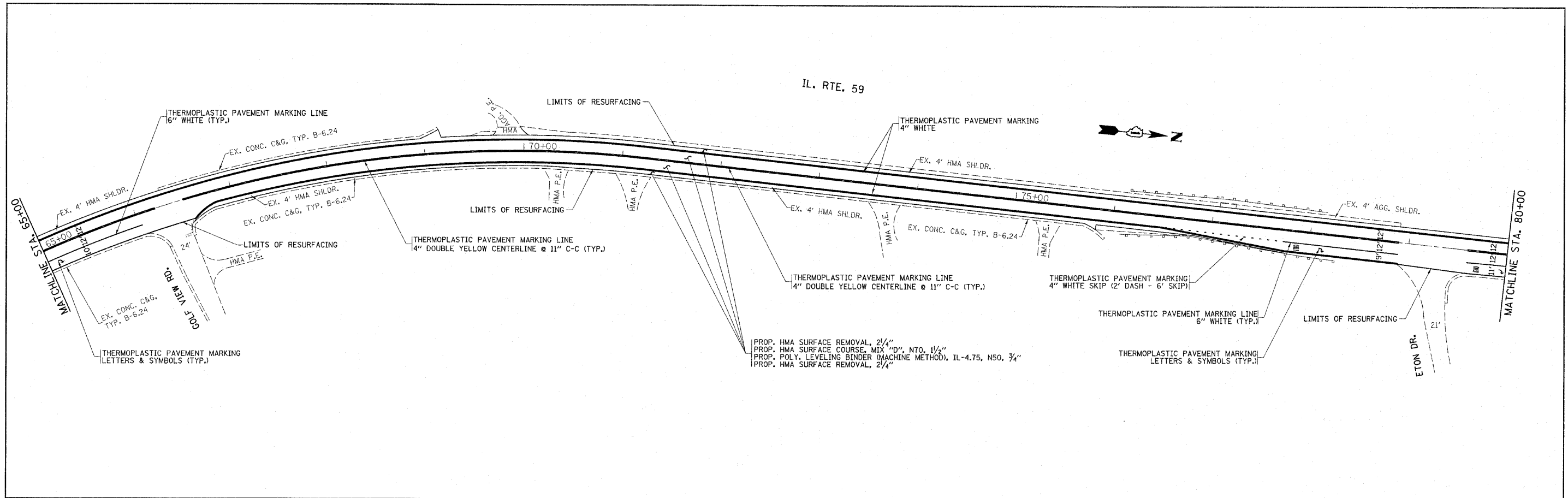

- ① EXIST. TERMINAL SECTION TO BE REPLACED WITH NEW TYPE 1 (SPECIAL) - TANGENT 50 FT LONG. SEE STANDARD 630301 & DISTRICT DETAIL (RD-34).
- OTHER PAY ITEMS WITH QUANTITIES ESTIMATED FOR THIS AREA INCLUDE:
- REMOVAL & DISPOSAL OF UNSUITABLE MATERIAL
 - FURNISHED EXCAVATION
 - TOP SOIL FURNISH AND PLACE, 4"
 - SEEDING, CLASS 2A
 - NITROGEN FERTILIZER NUTRIENT
 - PHOSPHORUS FERTILIZER NUTRIENT
 - POTASSIUM FERTILIZER NUTRIENT
 - EROSION CONTROL BLANKET
 - AGGREGATE SHOULDER, TYPE B - 10"
 - GUARDRAIL REMOVAL

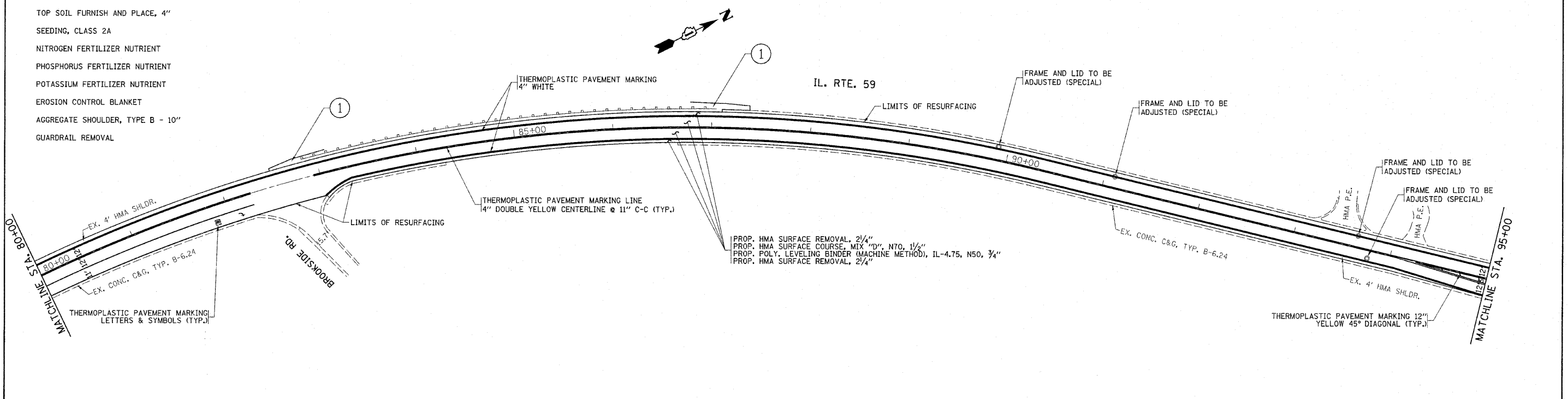

FILE NAME =	USER NAME = hamdaneh	DESIGNED -	REVISED -	STATE OF ILLINOIS DEPARTMENT OF TRANSPORTATION	ROADWAY AND PAVEMENT MARKING PLAN IL. RTE. 59 FROM IL. RTE. 22 TO U.S. RTE 12 (RAND RD.)	F.A.P. RTE.	SECTION	COUNTY	TOTAL SHEETS	SHEET NO.	
c:\pw_work\pwsdot\hamdaneh\0223594\011	III-sht-plan06	DRAWN -	REVISED -			338	107-RS-3	LAKE	30	7	
PLOT SCALE = 50.0000' / IN.		CHECKED -	REVISED -			CONTRACT NO. 60M58					
PLOT DATE = 12/11/2010		DATE -	REVISED -			ILLINOIS FED. AID PROJECT					

Rev. Sheet 1-3-11

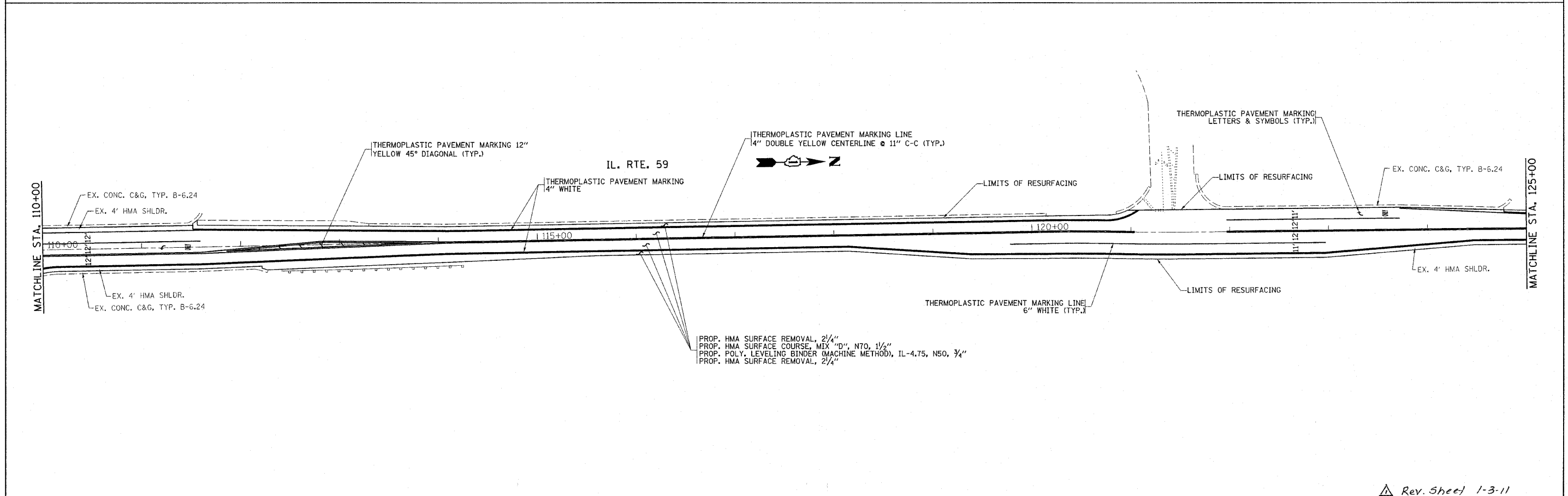
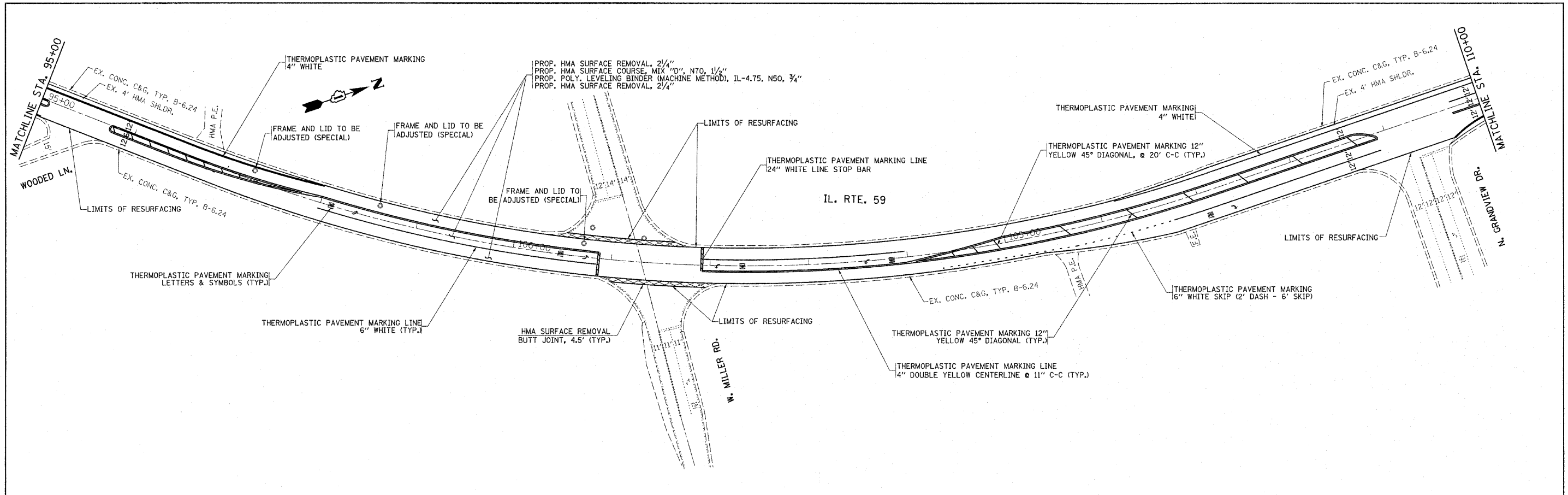

FILE NAME =	USER NAME = hamdaneh	DESIGNED -	REVISED -	STATE OF ILLINOIS DEPARTMENT OF TRANSPORTATION	ROADWAY AND PAVEMENT MARKING PLAN IL. RTE. 59 FROM IL. RTE. 22 TO U.S. RTE 12 (RAND RD.)	F.A.P. RTE.	SECTION	COUNTY	TOTAL SHEETS	SHEET NO.	
c:\pwwork\pwwid\hamdaneh\d0223594\011111-sht-plen.dgn	1111-sht-plen.dgn	DRAWN -	REVISED -			338	107-RS-3	LAKE	30	8	
PLOT SCALE = 50.0000' / IN.		CHECKED -	REVISED -			CONTRACT NO. 60M58					
PLOT DATE = 12/11/2010		DATE -	REVISED -			ILLINOIS FED. AID PROJECT					
						SCALE:	SHEET NO.	OF	SHEETS	STA.	TO

Rev. Sheet 1-3-11

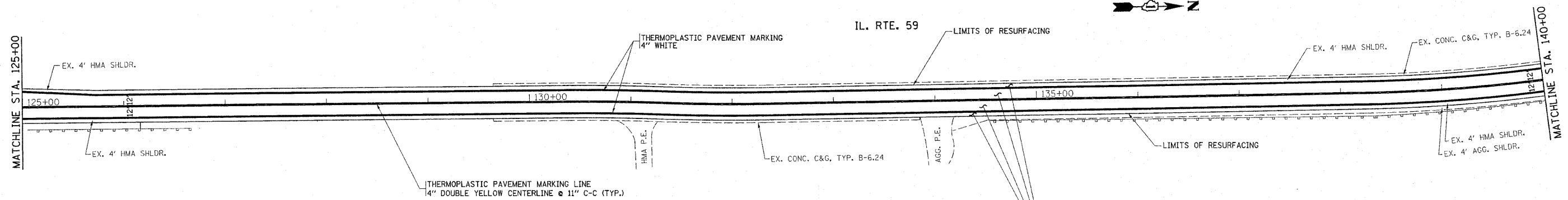

PROP. HMA SURFACE REMOVAL, 2 1/4"
PROP. HMA SURFACE COURSE, MIX "D", N70, 1 1/2"
PROP. POLY. LEVELING BINDER (MACHINE METHOD), IL-4.75, N50, 3/4"
PROP. HMA SURFACE REMOVAL, 2 1/4"

- ① EXIST. TERMINAL SECTION TO BE REPLACED WITH NEW TYPE 1 (SPECIAL) - TANGENT 50 FT LONG. SEE STANDARD 630301 & DISTRICT DETAIL (BD-34).
- OTHER PAY ITEMS WITH QUANTITIES ESTIMATED FOR THIS AREA INCLUDE:
- REMOVAL & DISPOSAL OF UNSUITABLE MATERIAL
 - FURNISHED EXCAVATION
 - TOP SOIL FURNISH AND PLACE, 4"
 - SEEDING, CLASS 2A
 - NITROGEN FERTILIZER NUTRIENT
 - PHOSPHORUS FERTILIZER NUTRIENT
 - POTASSIUM FERTILIZER NUTRIENT
 - EROSION CONTROL BLANKET
 - AGGREGATE SHOULDER, TYPE B - 10"
 - GUARDRAIL REMOVAL

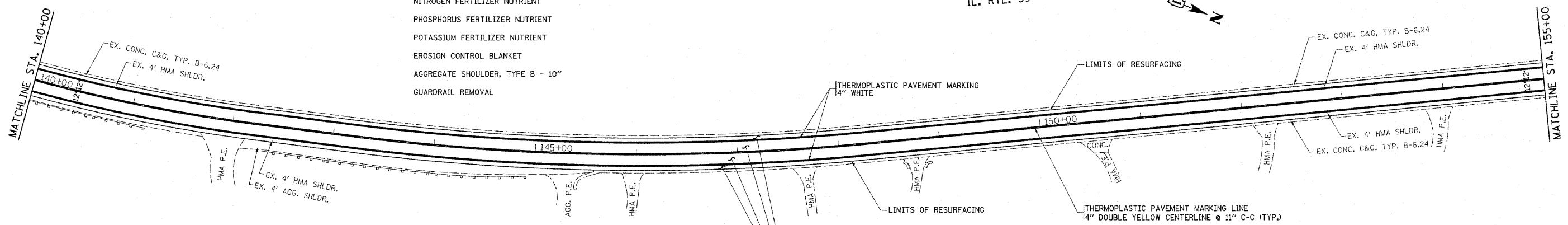

PROP. HMA SURFACE REMOVAL, 2 1/4"
PROP. HMA SURFACE COURSE, MIX "D", N70, 1 1/2"
PROP. POLY. LEVELING BINDER (MACHINE METHOD), IL-4.75, N50, 3/4"
PROP. HMA SURFACE REMOVAL, 2 1/4"

Rev. Sheet 1-3-11

FILE NAME =	USER NAME = hmdanah	DESIGNED -	REVISED -	STATE OF ILLINOIS DEPARTMENT OF TRANSPORTATION	ROADWAY AND PAVEMENT MARKING PLAN IL. RTE. 59 FROM IL. RTE. 22 TO U.S. RTE 12 (RAND RD.)	F.A.P. RTE.	SECTION	COUNTY	TOTAL SHEETS	SHEET NO.	
c:\pwwork\pwwork\hmdanah\d0223594\011111-sht-plan.dgn	PLOT SCALE = 50.0000' / 1" IN.	DRAWN -	REVISED -			338	107-RS-3	LAKE	30	9	
PLOT DATE = 12/11/2018	DATE -	CHECKED -	REVISED -			CONTRACT NO. 60M58					
						ILLINOIS FED. AID PROJECT					

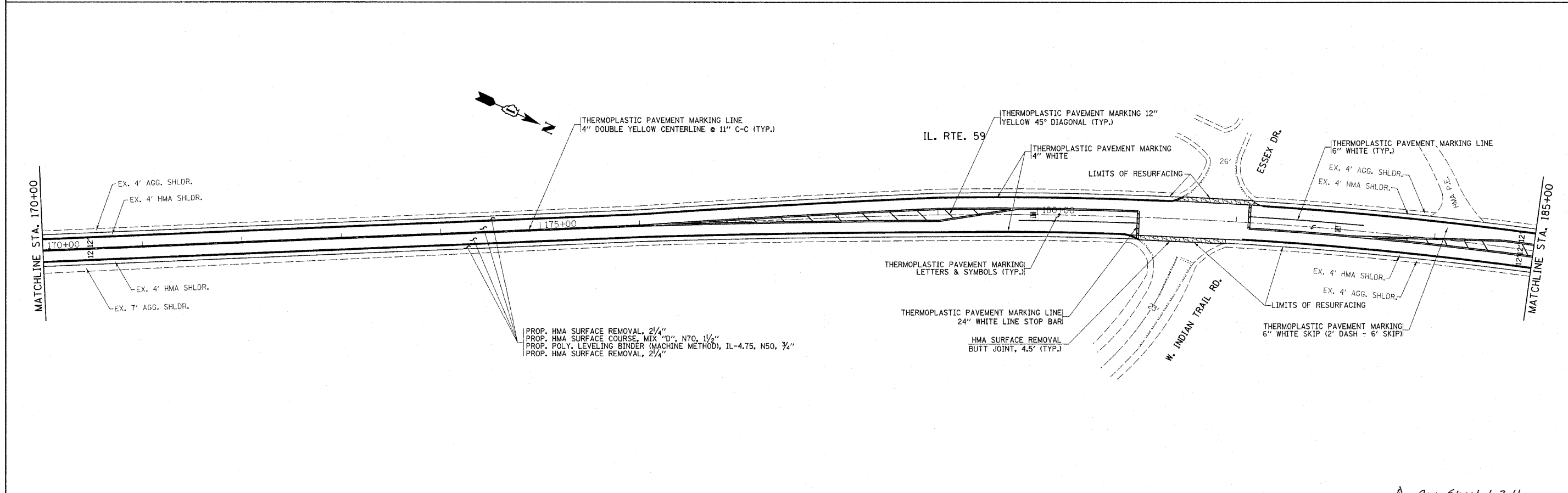
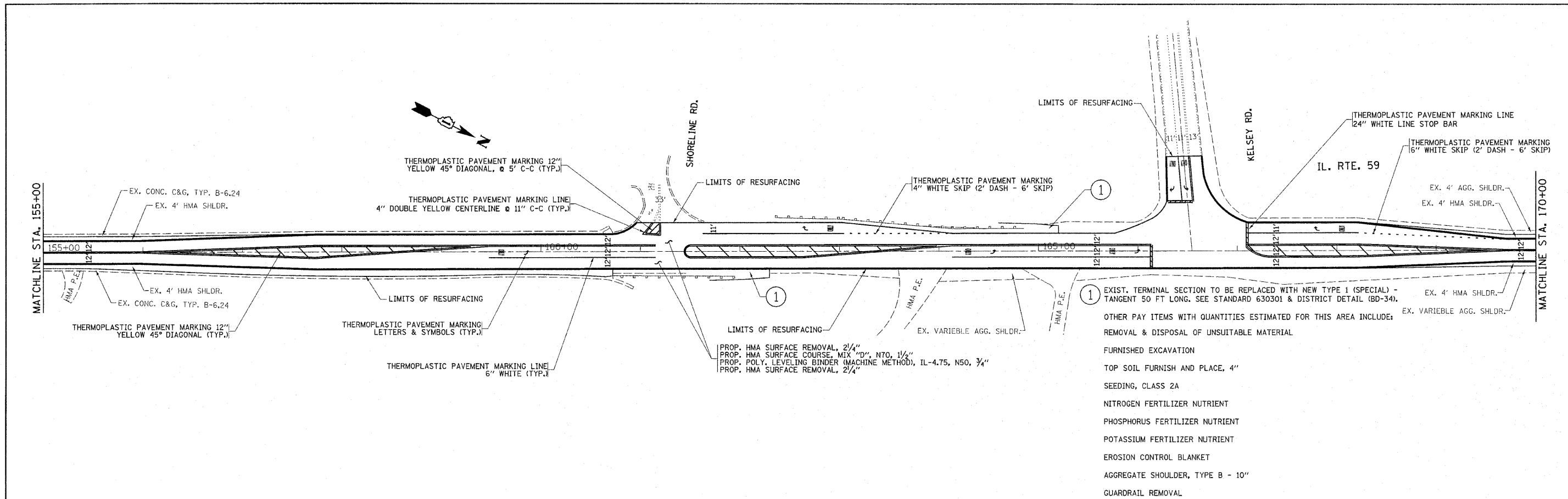

FILE NAME =	USER NAME = hmdenh	DESIGNED -	REVISED -	STATE OF ILLINOIS DEPARTMENT OF TRANSPORTATION	ROADWAY AND PAVEMENT MARKING PLAN IL. RTE. 59 FROM IL. RTE. 22 TO U.S. RTE 12 (RAND RD.)	F.A.P. RTE.	SECTION	COUNTY	TOTAL SHEETS	SHEET NO.	
c:\pwwork\pwwork\hmdenh\d0223594\011	111-sht-plan.dgn	DRAWN -	REVISED -			338	107-RS-3	LAKE	30	10	
	PLOT SCALE = 50.0000' / IN.	CHECKED -	REVISED -			CONTRACT NO. 60M58					
	PLOT DATE = 12/11/2010	DATE -	REVISED -			ILLINOIS FED. AID PROJECT					

Rev. Sheet 1-3-11

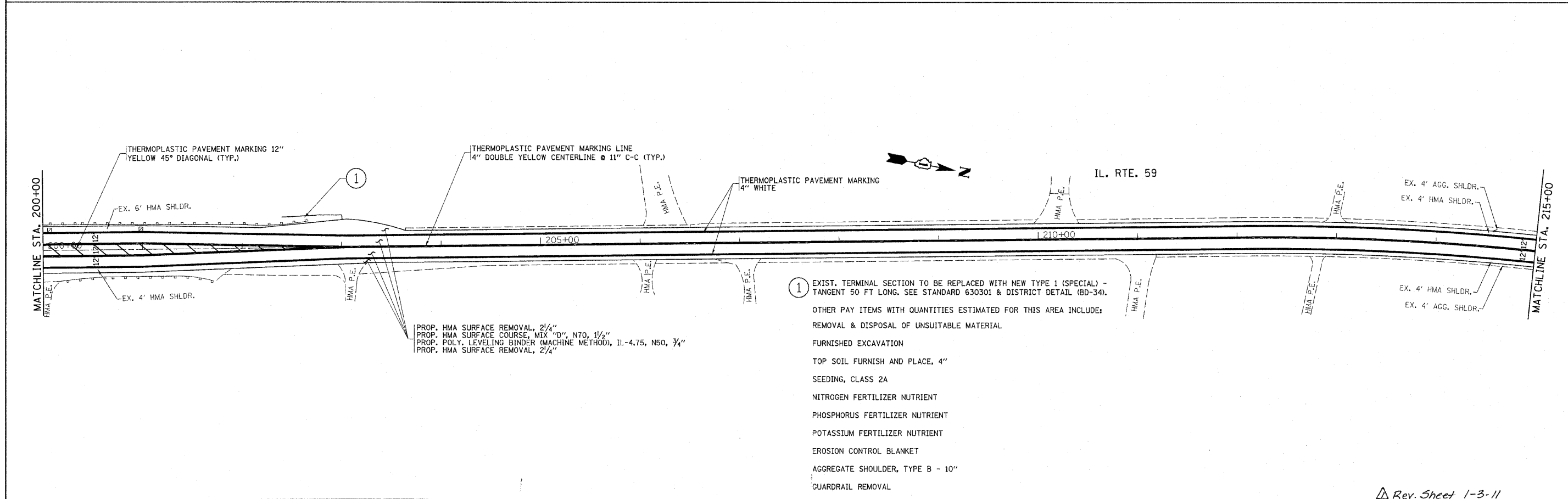
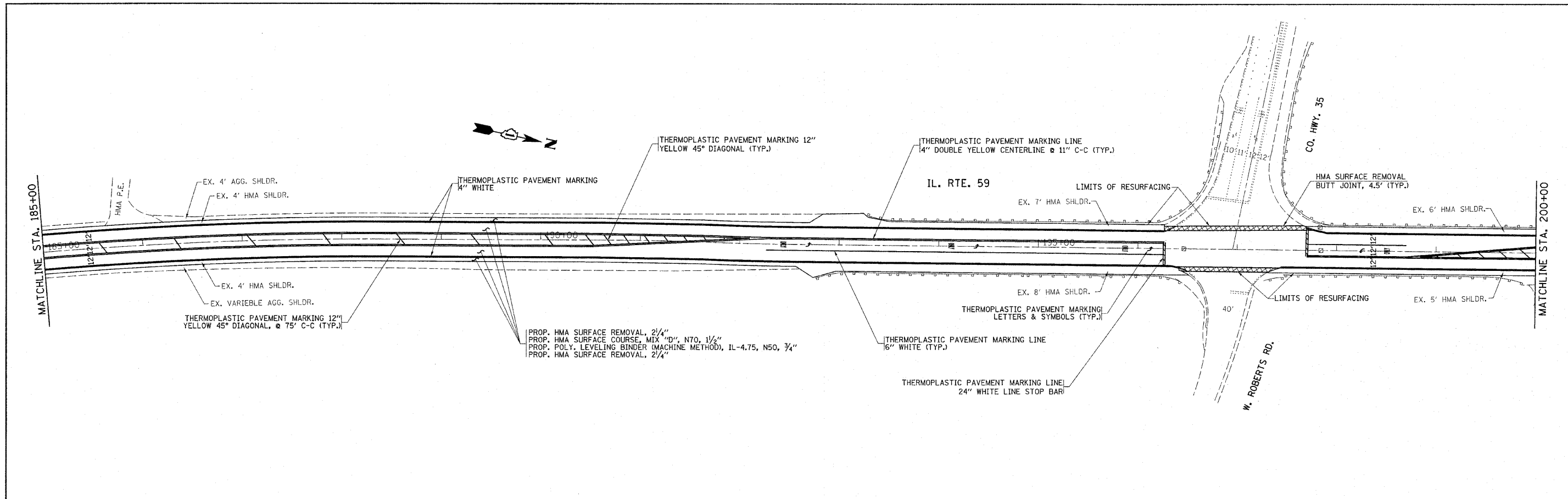

- ① EXIST. TERMINAL SECTION TO BE REPLACED WITH NEW TYPE 1 (SPECIAL) - TANGENT 50 FT LONG. SEE STANDARD 630301 & DISTRICT DETAIL (BD-34).
- OTHER PAY ITEMS WITH QUANTITIES ESTIMATED FOR THIS AREA INCLUDE:
- REMOVAL & DISPOSAL OF UNSUITABLE MATERIAL
 - FURNISHED EXCAVATION
 - TOP SOIL FURNISH AND PLACE, 4"
 - SEEDING, CLASS 2A
 - NITROGEN FERTILIZER NUTRIENT
 - PHOSPHORUS FERTILIZER NUTRIENT
 - POTASSIUM FERTILIZER NUTRIENT
 - EROSION CONTROL BLANKET
 - AGGREGATE SHOULDER, TYPE B - 10"
 - GUARDRAIL REMOVAL

FILE NAME =	USER NAME = hmdenah
ct:\pwwork\pwwd\hmdenah\d2223594\011	111-shtr-plan.dgn
PLOT SCALE = 50.0000' / 1" IN.	CHECKED -
PLOT DATE = 12/11/2010	DATE -

DESIGNED -	REVISED -
DRAWN -	REVISED -
CHECKED -	REVISED -
DATE -	REVISED -

**STATE OF ILLINOIS
DEPARTMENT OF TRANSPORTATION**

**ROADWAY AND PAVEMENT MARKING PLAN
IL. RTE. 59 FROM IL. RTE. 22 TO U.S. RTE 12 (RAND RD.)**

F.A.P. RTE.	SECTION	COUNTY	TOTAL SHEETS	SHEET NO.
338	107-RS-3	LAKE	30	11
CONTRACT NO. 60M58			ILLINOIS FED. AID PROJECT	

Rev. Sheet 1-3-11

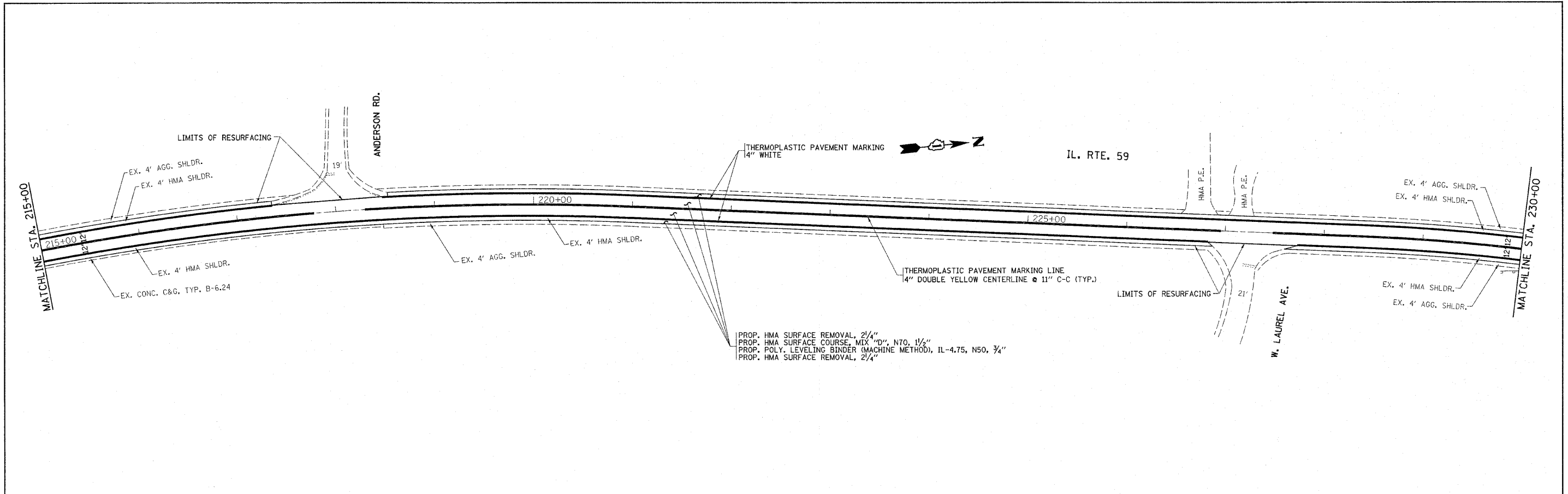

① EXIST. TERMINAL SECTION TO BE REPLACED WITH NEW TYPE 1 (SPECIAL) - TANGENT 50 FT LONG. SEE STANDARD 630301 & DISTRICT DETAIL (BD-34).

- OTHER PAY ITEMS WITH QUANTITIES ESTIMATED FOR THIS AREA INCLUDE:
- REMOVAL & DISPOSAL OF UNSUITABLE MATERIAL
 - FURNISHED EXCAVATION
 - TOP SOIL FURNISH AND PLACE, 4"
 - SEEDING, CLASS 2A
 - NITROGEN FERTILIZER NUTRIENT
 - PHOSPHORUS FERTILIZER NUTRIENT
 - POTASSIUM FERTILIZER NUTRIENT
 - EROSION CONTROL BLANKET
 - AGGREGATE SHOULDER, TYPE B - 10"
 - GUARDRAIL REMOVAL

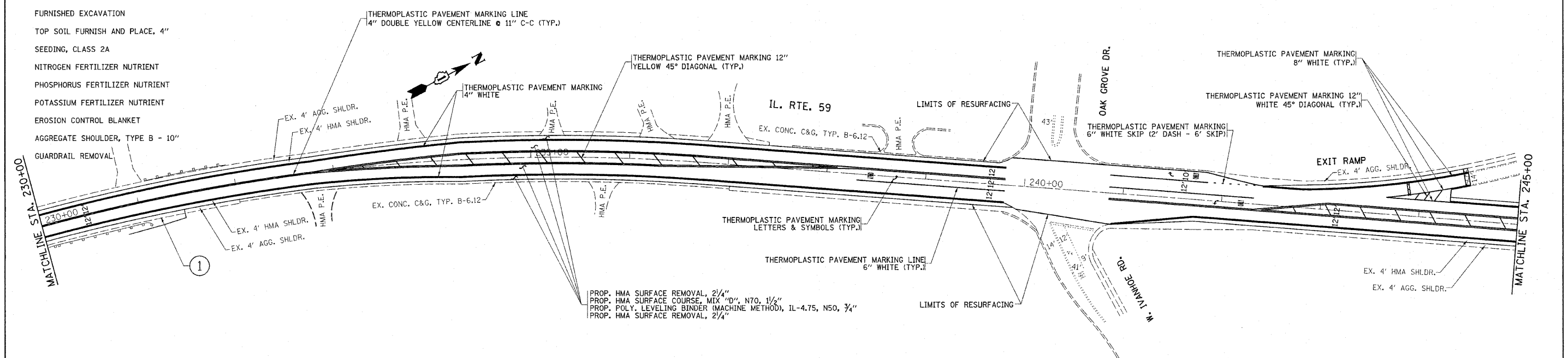

FILE NAME =	USER NAME = hamdenah	DESIGNED -	REVISED -	STATE OF ILLINOIS DEPARTMENT OF TRANSPORTATION	ROADWAY AND PAVEMENT MARKING PLAN IL. RTE. 59 FROM IL. RTE. 22 TO U.S. RTE 12 (RAND RD.)	F.A.P. RTE. 338	SECTION 107-RS-3	COUNTY LAKE	TOTAL SHEETS 30	SHEET NO. 12	
ct:\pw\work\pwsdot\hamdenah\08223594\DI1111-sht-plan.dgn	PLOT SCALE = 50.0000' / IN.	DRAWN -	REVISED -			SCALE:	SHEET NO. OF SHEETS STA. TO STA.	CONTRACT NO. 60M58			
	PLOT DATE = 12/11/2010	CHECKED -	REVISED -			ILLINOIS FED. AID PROJECT					
		DATE -	REVISED -								

Rev. Sheet 1-3-11

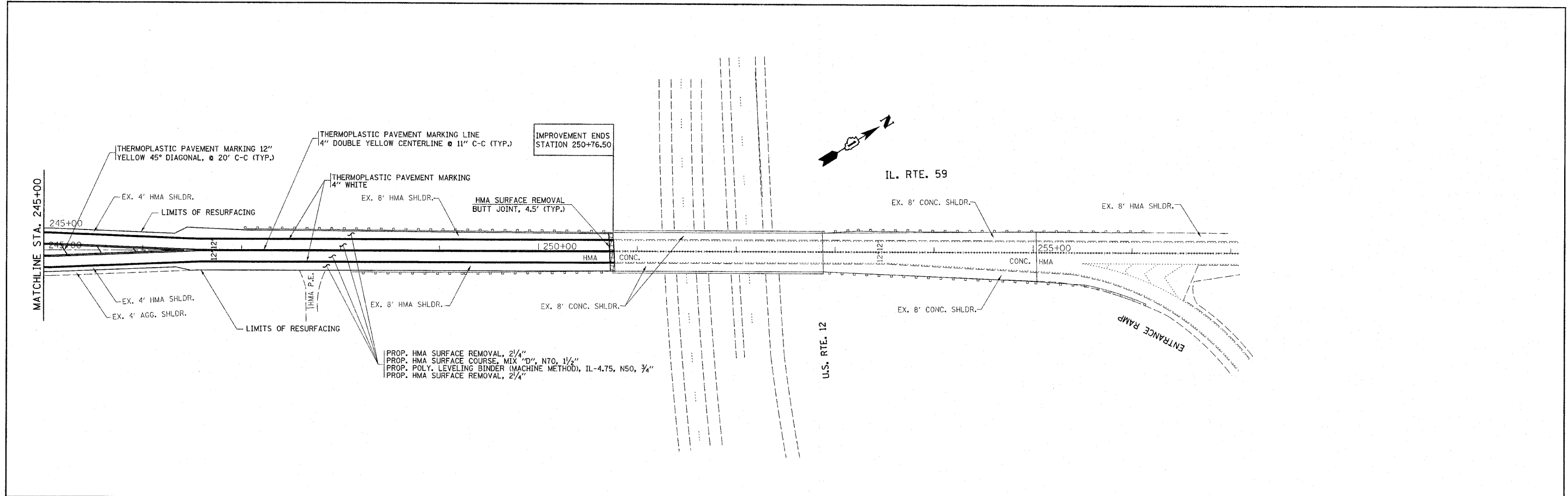

PROP. HMA SURFACE REMOVAL, 2/4"
 PROP. HMA SURFACE COURSE, MIX "D", N70, 1 1/2"
 PROP. POLY. LEVELING BINDER (MACHINE METHOD), IL-4.75, NS0, 3/4"
 PROP. HMA SURFACE REMOVAL, 2/4"

Rev. Sheet 1-3-11

FILE NAME =	USER NAME = hmdanah	DESIGNED -	REVISED -	STATE OF ILLINOIS DEPARTMENT OF TRANSPORTATION	ROADWAY AND PAVEMENT MARKING PLAN IL. RTE. 59 FROM IL. RTE. 22 TO U.S. RTE 12 (RAND RD.)				F.A.P. RTE.	SECTION	COUNTY	TOTAL SHEETS	SHEET NO.
ca:\pwwork\pwwork\hmdanah\0223594\011111-sht-plan.dgn	1111-sht-plan.dgn	DRAWN -	REVISED -		338	107-RS-3	LAKE	30	13				
PLOT SCALE = 50.0000' / IN.		CHECKED -	REVISED -		CONTRACT NO. 60M58				ILLINOIS FED. AID PROJECT				
PLOT DATE = 12/11/2010		DATE -	REVISED -		SCALE:	SHEET NO.	OF	SHEETS	STA.	TO STA.			