

ROUTE	SECTION	COUNTY	TOTAL SHEETS	SHEET NUMBER
VARIOUS	2010-130-I	COOK	* 40	1

FOR INDEX OF SHEETS SEE SHEET 2

IMPROVEMENTS ARE LOCATED
IN THE CITY OF CHICAGO.

**STATE OF ILLINOIS
DEPARTMENT OF TRANSPORTATION
DIVISION OF HIGHWAYS
DISTRICT ONE
PROPOSED HIGHWAY PLANS**

⚠ +2 = 42

CONTRACT NO. 60N04

D-91-210-11

VARIOUS ROUTES
VARIOUS LOCATIONS
(I-90 and I-90/94 (KENNEDY EXPY)
- OVERHEAD BRIDGES)
SECTION 2010-130-I
BRIDGE DECK SEALING
COOK COUNTY
C-91-210-11

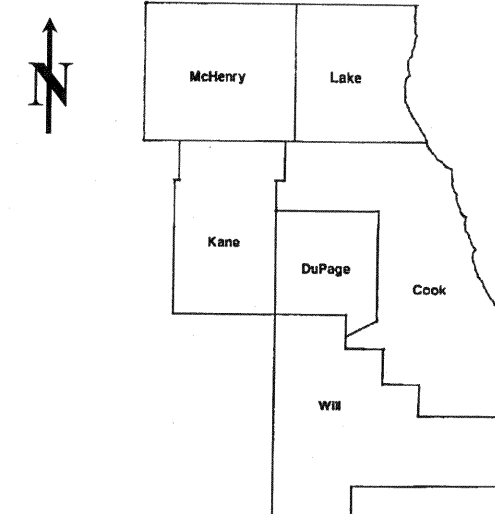

LOCATION OF IMPROVEMENTS INDICATED THUS: ■

SEE LOCATION MAPS
SHEETS 7 - 12

STATE OF ILLINOIS
DEPARTMENT OF TRANSPORTATION
DIVISION OF HIGHWAYS

SUBMITTED: Nov 4 2010
[Signature]
DEPUTY DIRECTOR OF HIGHWAYS, REGION ENGINEER

Dec 10 2010
Scott E. Still, P.E.
acting ENGINEER OF DESIGN AND ENVIRONMENT

Dec 10 2010
Christine M. Reed
DIRECTOR, DIVISION OF HIGHWAYS

PRINTED BY THE AUTHORITY
OF THE STATE OF ILLINOIS

C.U.A.N.
CHICAGO UTILITY ALERT NETWORK
(312) 744-7000

PROJECT ENGINEER ROBERT BORO (847) 705-4178
PROJECT MANAGER ISSAM RAYYAN



CONTRACT NO. 60N04

⚠ Rev. 1-4-11

ROUTE	SECTION	COUNTY	TOTAL SHEETS	SHEET NUMBER
VARIOUS	2010-130-I	COOK	40	2

CONTRACT NO. 60N04

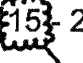
INDEX OF SHEETS

- | | |
|---|--|
| <p>1 TITLE SHEET</p> <p>2 INDEX OF SHEETS</p> <p>3 STATE STANDARDS AND GENERAL NOTES</p> <p>4 SUMMARY OF QUANTITIES</p> <p>5 SCHEDULE OF QUANTITIES, LOCATIONS 1 - 14 </p> <p>6 SCHEDULE OF QUANTITIES, LOCATIONS 15 - 28 </p> <p>7 LOCATION MAP, LOCATIONS 1 & 2 </p> <p>8 LOCATION MAP, LOCATIONS 3 - 6</p> <p>9 LOCATION MAP, LOCATIONS 7 - 10</p> <p>10 LOCATION MAP, LOCATIONS 11 - 16</p> <p>11 LOCATION MAP, LOCATIONS 17 - 21</p> <p>12 LOCATION MAP, LOCATIONS 22 - 28</p> <p>13 LOCATIONS 1 & 2 BRIDGE PLANS (SN 016-2717, 2718)</p> <p>14 LOCATION 3 BRIDGE PLANS (SN 016-0707)</p> <p>15 LOCATION 4 BRIDGE PLANS (SN 016-0309)</p> <p>16 LOCATION 5 BRIDGE PLANS (SN 016-1106)</p> <p>17 LOCATION 6 BRIDGE PLANS (SN 016-0708)</p> <p>18 LOCATION 7 BRIDGE PLANS (SN 016-1100)</p> <p>19 LOCATION 8 BRIDGE PLANS (SN 016-1107)</p> <p>20 LOCATION 9 BRIDGE PLANS (SN 016-1105)</p> <p>21 LOCATION 10 BRIDGE PLANS (SN 016-0852)</p> | <p>22 LOCATION 11 BRIDGE PLANS (SN 016-2045)</p> <p>23 LOCATION 12 BRIDGE PLANS (SN 016-2046)</p> <p>24 LOCATIONS 13 & 14 BRIDGE PLANS (SN 016-2047, 2049)</p> <p>25 LOCATION 15 BRIDGE PLANS (SN 016-2118)</p> <p>26 LOCATION 16 BRIDGE PLANS (SN 016-2048)</p> <p>27 LOCATION 17 BRIDGE PLANS (SN 016-0136)</p> <p>28 LOCATION 18 BRIDGE PLANS (SN 016-2056)</p> <p>29 LOCATION 19 BRIDGE PLANS (SN 016-2057)</p> <p>30 LOCATION 20 BRIDGE PLANS (SN 016-2051)</p> <p>31 LOCATION 21 BRIDGE PLANS (SN 016-2052)</p> <p>32 LOCATION 22 BRIDGE PLANS (SN 016-0608)</p> <p>33 LOCATION 23 BRIDGE PLANS (SN 016-0601)</p> <p>34 LOCATION 24 BRIDGE PLANS (SN 016-2053)</p> <p>35 LOCATION 25 BRIDGE PLANS (SN 016-2054)</p> <p>36 LOCATION 26 BRIDGE PLANS (SN 016-0589)</p> <p>37 LOCATION 27 BRIDGE PLANS (SN 016-0588)</p> <p>38 LOCATION 28 BRIDGE PLANS (SN 016-2055)</p> <p>39 FREEWAY ENTRANCE AND EXIT RAMP CLOSURE DETAILS (TC-08)</p> <p>40 ARTERIAL ROAD INFORMATION SIGN (TC-22)</p> <p>40A TRAFFIC CONTROL AND PROTECTION FOR SIDE ROADS, INTERSECTIONS, AND DRIVEWAYS (TC-10)</p> <p>40B TRAFFIC CONTROL AND PROTECTION AT TURN BAYS (TO REMAIN OPEN TO TRAFFIC) (TC-14) </p> |
|---|--|

 Revised 12/23/2010 BN

**ILLINOIS DEPARTMENT OF
TRANSPORTATION**

INDEX OF SHEETS

ROUTE	SECTION	COUNTY	TOTAL SHEETS	SHEET NUMBER
VARIOUS	2010-130-I	COOK	40	4

CONTRACT NO. 60N04

SUMMARY OF QUANTITIES				
CODE NO	DESCRIPTION	UNITS	100% STATE	
			URBAN TOTAL	CONSTRUCTION TYPE CODE: 0014
58700300	CONCRETE SEALER	SQ FT	645584	645584
67000400	ENGINEER'S FIELD OFFICE, TYPE A	CAL MO	6	6
67100100	MOBILIZATION	L SUM	1	1
70102620	TRAFFIC CONTROL AND PROTECTION, STANDARD 701501	L SUM	1	1
70102625	TRAFFIC CONTROL AND PROTECTION, STANDARD 701606	L SUM	1	1
70102630	TRAFFIC CONTROL AND PROTECTION, STANDARD 701601	L SUM	1	1
70102635	TRAFFIC CONTROL AND PROTECTION, STANDARD 701701	L SUM	1	1
70102640	TRAFFIC CONTROL AND PROTECTION, STANDARD 701801	L SUM	1	1
X7011420	TRAFFIC CONTROL AND PROTECTION, STANDARD 701411	L SUM	1	1
X7011015	TRAFFIC CONTROL AND PROTECTION (EXPRESSWAYS)	L SUM	1	1
Z0026346	NIGHTTIME WORK ZONE LIGHTING	L SUM	1	1
Z0030850	TEMPORARY INFORMATION SIGNING	SQ FT	359.8	359.8
 Z0048665	RAILROAD PROTECTIVE LIABILITY INSURANCE	L SUM	1	1

ILLINOIS DEPARTMENT OF
TRANSPORTATION

SUMMARY OF QUANTITIES

ROUTE	SECTION	COUNTY	TOTAL SHEETS	SHEET NUMBER
VARIOUS	2010-130-I	COOK	40	5

SCHEDULE OF QUANTITIES														
LOCATION	1	2	3	4	5	6	7	8	9	10	11	12	13	14
STRUCTURE NUMBER	016-2717	016-2718	016-0707	016-0309	016-1106	016-0708	016-1100	016-1107	016-1105	016-0852	016-2045	016-2046	016-2047	016-2049
CONCRETE SEALER	33584	25519	15216	22579	12667	21625	32601	17725	17891	40694	42375	25555	12464	12256
MOBILIZATION	0.036	0.036	0.036	0.036	0.036	0.036	0.036	0.036	0.036	0.036	0.036	0.036	0.036	0.036
TRAFFIC CONTROL AND PROTECTION, STANDARD 701400														
TRAFFIC CONTROL AND PROTECTION, STANDARD 701401														
TRAFFIC CONTROL AND PROTECTION, STANDARD 701501					0.16				0.16					
TRAFFIC CONTROL AND PROTECTION, STANDARD 701606			0.14			0.15						0.15		
TRAFFIC CONTROL AND PROTECTION, STANDARD 701601	0.067	0.067		0.067			0.067	0.066		0.067	0.067		0.066	0.066
TRAFFIC CONTROL AND PROTECTION, STANDARD 701701			0.25	0.25		0.25								0.25
TRAFFIC CONTROL AND PROTECTION, STANDARD 701801			0.04	0.04	0.04	0.04	0.04	0.04	0.04	0.04	0.04	0.04	0.04	0.04
TRAFFIC CONTROL AND PROTECTION (EXPRESSWAYS)														
TRAFFIC CONTROL AND PROTECTION, STANDARD 701411	0.5	0.5												
NIGHTTIME WORK ZONE LIGHTING	0.036	0.036	0.036	0.036	0.036	0.036	0.036	0.036	0.036	0.036	0.036	0.036	0.036	0.036
RAILROAD PROTECTIVE LIABILITY INSURANCE	0.084	0.083	0.083	0.083	0.083	0.083	0.084	0.083	0.083	0.084				

ILLINOIS DEPARTMENT OF
TRANSPORTATION

SCHEDULE OF QUANTITIES
LOCATIONS 1 - 14

Revised Sheet 12/23/2010 BN

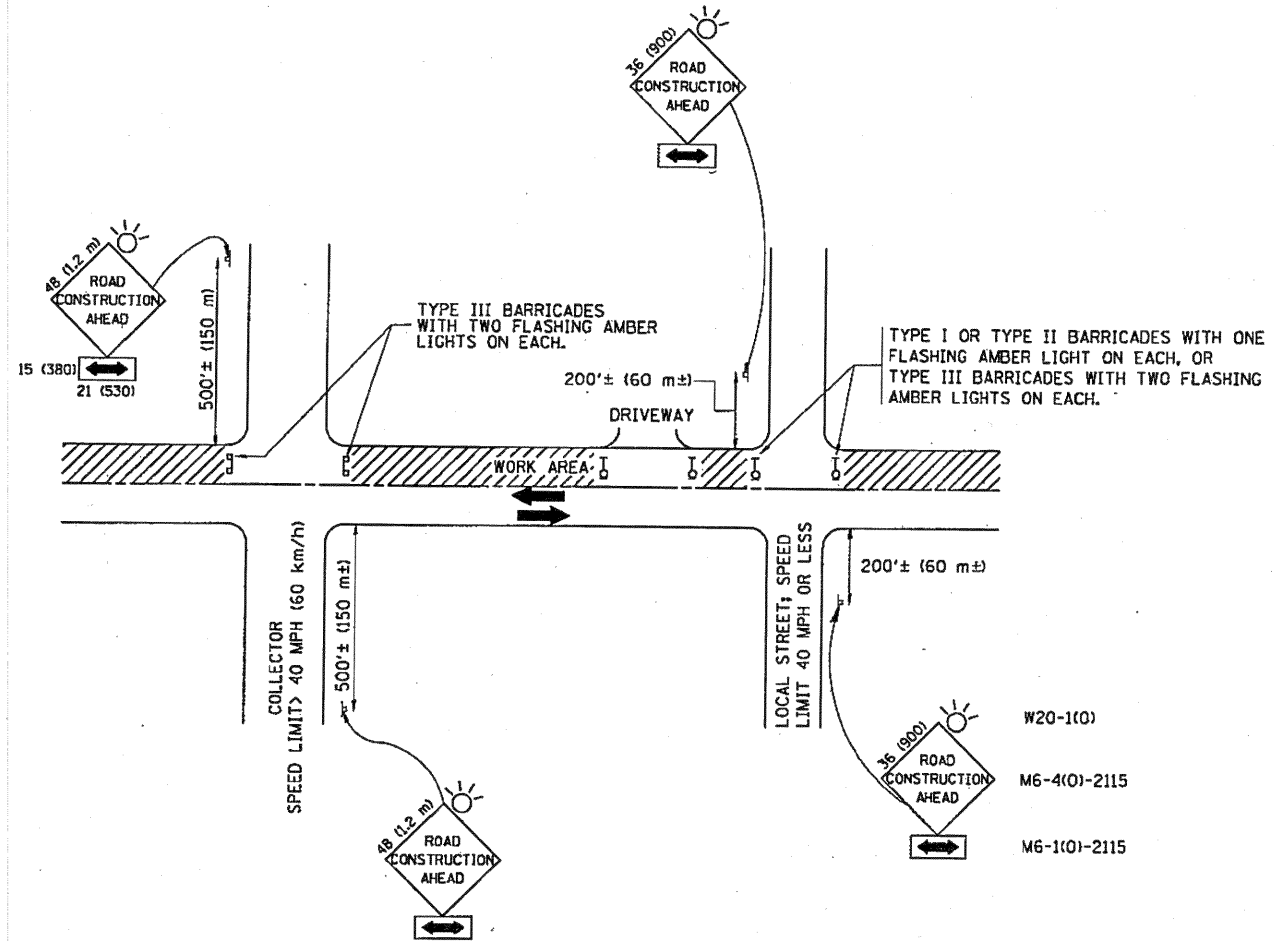

TRAFFIC CONTROL AND PROTECTION FOR SIDE ROADS, INTERSECTIONS, AND DRIVEWAYS

NOTES:

- A. FOR NO LANE RESTRICTION ON THE SIDE ROAD OR DRIVEWAYS
 - 1. SIDE ROAD WITH A SPEED LIMIT OF 40 MPH (60 km/h) OR LESS AS SHOWN ON THE DRAWING AND AS DIRECTED BY THE ENGINEER:
 - a) ONE ROAD CONSTRUCTION AHEAD SIGN 36 x 36 (900x900) WITH A FLASHER AND FLAG MOUNTED ON IT APPROXIMATELY 200' (60 m) IN ADVANCE OF THE MAIN ROUTE.
 - b) THE CLOSED PORTION OF THE MAIN ROUTE SHALL BE PROTECTED BY BLOCKING WITH TYPE I, TYPE II OR TYPE III BARRICADES, 1/3 OF THE CROSS SECTION OF THE CLOSED PORTION.
 - 2. SIDE ROAD WITH A SPEED LIMIT GREATER THAN 40 MPH (60 km/h) AS SHOWN ON THE DRAWING AND AS DIRECTED BY THE ENGINEER:
 - a) ONE ROAD CONSTRUCTION AHEAD SIGN 48 x 48 (1.2 m x 1.2 m) WITH A FLASHER MOUNTED ON IT APPROXIMATELY 500' (150 m) IN ADVANCE OF THE MAIN ROUTE.
 - b) THE CLOSED PORTION OF THE MAIN ROUTE SHALL BE PROTECTED BY BLOCKING WITH TYPE III BARRICADES, 1/2 OF THE CROSS SECTION OF THE CLOSED PORTION.
- 3. WHEN THE SIDE ROAD LIES BETWEEN THE BEGINNING OF THE MAINLINE SIGNING AND THE WORK ZONE, A SINGLE HEADED ARROW (M6-1) SHALL BE USED IN LIEU OF THE DOUBLE HEADED ARROW (M6-4).

- B. FOR A LANE CLOSURE ON A SIDE ROAD OR DRIVEWAY:
 - USE APPLICABLE PORTIONS OF THE TYPICAL APPLICATION OF TRAFFIC CONTROL DEVICES (STD. 701501, STD. 701606 OR THE APPROPRIATE STANDARD). THE SPACING OF SIGNS AND BARRICADES SHALL BE ADJUSTED FOR FIELD CONDITIONS AS DIRECTED BY THE ENGINEER. THE DIRECTIONAL ARROW SHALL BE COVERED OR REMOVED WHEN NO LONGER CONSISTENT WITH THE SIDE ROAD LANE CLOSURE.
- C. ADVANCE WARNING SIGNS ARE TO BE OMITTED ON DRIVEWAY UNLESS OTHERWISE NOTED.
- D. THE TRAFFIC CONTROL AND PROTECTION FOR SIDE ROADS, INTERSECTIONS, AND DRIVEWAYS SHALL BE INCIDENTAL TO THE COST OF SPECIFIED TRAFFIC CONTROL STANDARDS OR ITEMS.

Added Sheet 12/23/2010 BN

All dimensions are in millimeters (inches) unless otherwise shown.

FILE NAME =	USER NAME = netherbo	DESIGNED - LHA	REVISED - J. OBERLE 10-18-95
c:\pwork\pwork\dot\netherbo\d8248644\Di	Std.dgn	DRAWN -	REVISED - A. HOUSEH 03-06-96
PLOT SCALE = 100.0000 ' / IN.	CHECKED -	RECHECKED -	REVISED - A. HOUSEH 10-15-96
PLOT DATE = 1/3/2011	DATE - 06-89	RECHECKED -	REVISED - T. RAMMACHER 01-06-00

STATE OF ILLINOIS
DEPARTMENT OF TRANSPORTATION

TRAFFIC CONTROL AND PROTECTION FOR SIDE ROADS, INTERSECTIONS, AND DRIVEWAYS	
SCALE: NONE	SHEET NO. 1 OF 1 SHEETS STA. TO STA.

F.A. RTE.	SECTION	COUNTY	TOTAL SHEETS	SHEET NO.
VAR.	2010-130-1	COOK	40	40A
TC-10		CONTRACT NO. 60N04		
FED. ROAD DIST. NO. 1 ILLINOIS FED. AID PROJECT				

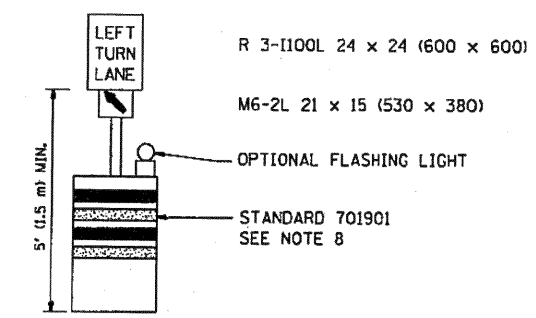
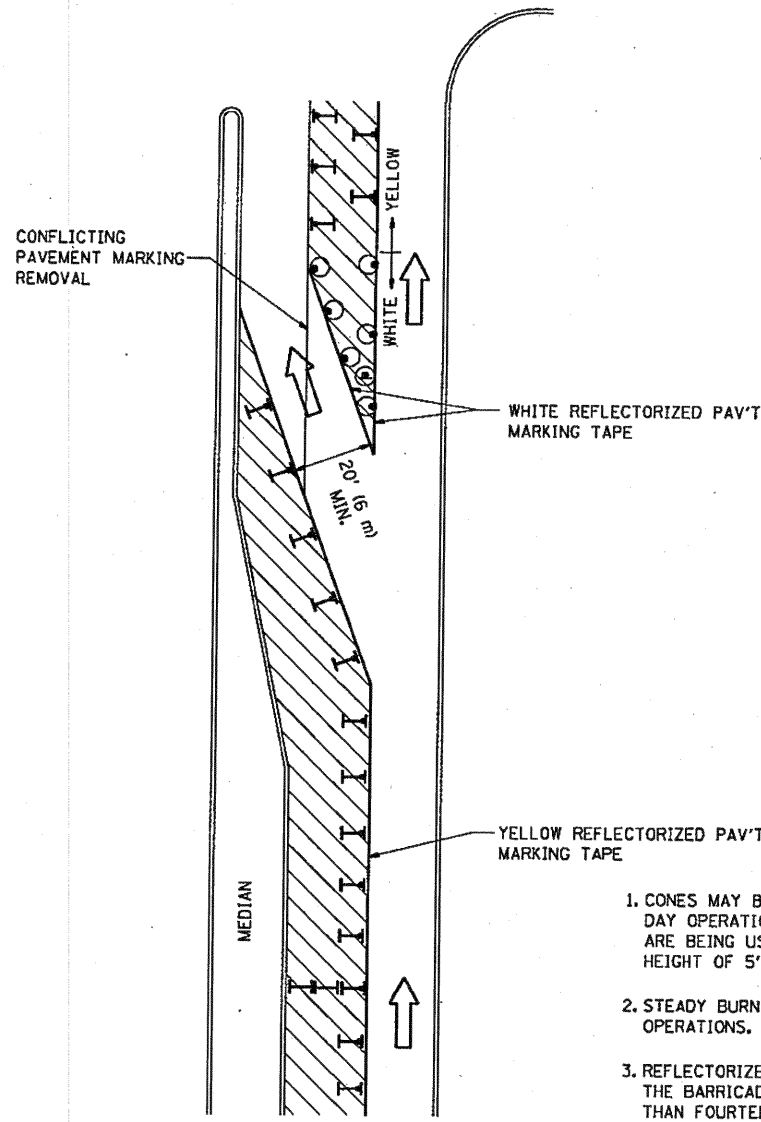





GENERAL NOTES

1. CONES MAY BE SUBSTITUTED FOR BARRICADES OR DRUMS AT HALF THE SPACING DURING DAY OPERATIONS. CONES SHALL BE A MINIMUM OF 28 (710) IN HEIGHT. WHEN CONES ARE BEING USED, THE "LEFT TURN LANE" SIGN MAY BE SKID MOUNTED AT A MINIMUM HEIGHT OF 5' (1.5 m).
2. STEADY BURNING LIGHTS WILL NOT BE REQUIRED ON BARRICADES OR DRUMS FOR DAY OPERATIONS. ALL LIGHTS SHALL BE MONODIRECTIONAL.
3. REFLECTORIZED TEMPORARY PAVEMENT MARKING TAPE SHALL BE PLACED THROUGHOUT THE BARRICADED AREA OF EACH TURN BAY WHERE THE CLOSURE TIME IS GREATER THAN FOURTEEN DAYS.
4. THIS APPLICATION ALSO APPLIES WHEN WORK IS BEING PERFORMED IN THE RIGHT LANE(S) AND THE RIGHT TURN BAY IS TO REMAIN OPEN. UNDER THIS CONDITION, "RIGHT TURN LANE" R3-100 24 x 24 (600 x 600) AND M6-2R 21 x 15 (530 x 380) SHALL BE USED.
5. THESE CONTROLS SHALL SUPPLEMENT MAINLINE TRAFFIC CONTROL FOR LANE CLOSURES.
6. LONGITUDINAL DIMENSIONS MAY BE ADJUSTED TO FIT FIELD CONDITIONS.
7. FORM OPER 725 IS REQUIRED.
8. IF A DRUM OR TYPE II BARRICADE WITH AN ATTACHED SIGN PANEL WHICH MEETS NCHRP 350 REQUIREMENTS IS NOT AVAILABLE, THE SIGNS SHALL BE MOUNTED, ABOVE THE BARRICADES, ON SEPARATE SIGNS SUPPORTS THAT MEET NCHR 350 PREUIREMENTS.
9. TRAFFIC CONTROL AND PROTECTION AT TURN BAYS (TO REMAIN OPEN TO TRAFFIC) SHALL BE INCLUDED IN THE COST SPECIFIED TRAFFIC CONTROL STANDARDS OR ITEMS.

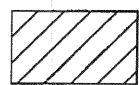
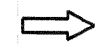
All dimensions are in inches (millimeters) unless otherwise shown.

LEGEND

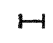
-  WORK AREA
-  LANE OPEN TO TRAFFIC
-  TYPE I OR II BARRICADE WITH STEADY BURN LIGHT
-  DRUM WITH STEADY BURN LIGHT
-  DRUM WITH SIGN (WITH OPTIONAL FLASHING LIGHT) SEE DETAIL
-  TYPE I OR II CHECK BARRICADE WITH FLASHING LIGHT

Added Sheet 12/23/2010 BU

FILE NAME =	USER NAME = nathanbo	REVISED - T. RAMMACHER 09-08-94	REVISED - R. BORO 09-14-09	STATE OF ILLINOIS DEPARTMENT OF TRANSPORTATION	TRAFFIC CONTROL AND PROTECTION AT TURN BAYS (TO REMAIN OPEN TO TRAFFIC)	F.A. RTE.	SECTION	COUNTY	TOTAL SHEETS	SHEET NO.	
Plot Scale = 1/8" = 100'	Plot Date = 1/3/2011	REVISED - A. HOUSEH 11-07-95	REVISED -			VAR.	2010-130-1	COOK	40	40B	
		REVISED - A. HOUSEH 10-12-96	REVISED -			TC-14		CONTRACT NO. 60N04			
		REVISED - T. RAMMACHER 01-06-00	REVISED -			SCALE: NONE	SHEET NO. 1 OF 1 SHEETS	STA.	TO STA.		FED. ROAD DIST. NO. 1 (ILLINOIS) FED. AID PROJECT