

LEGEND

	PAVEMENT REMOVAL
	PAVED SHOULDER REMOVAL
	COMBINED CURB & GUTTER REMOVAL
	MEDIAN REMOVAL
	HOT-MIX ASPHALT SURFACE REMOVAL
	APPROX. SOIL BORING LOCATION

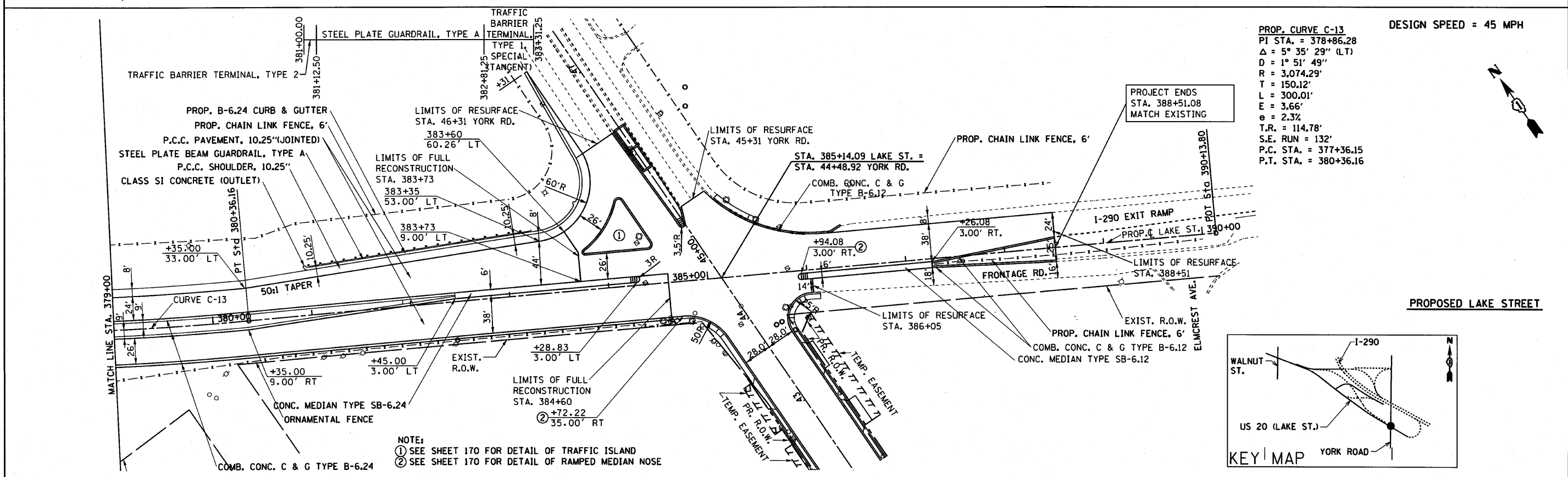
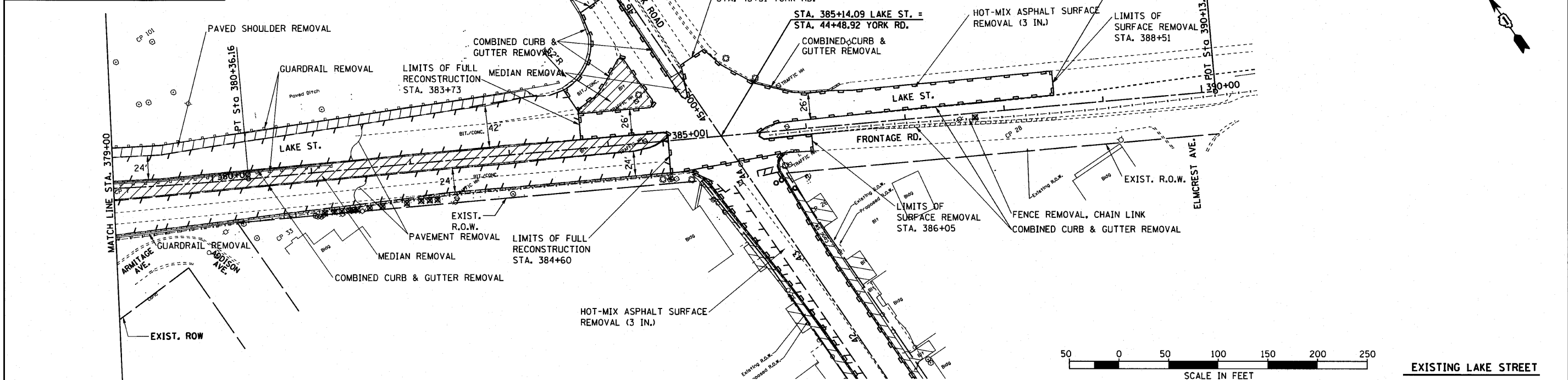

PROP. CURVE C-13
 PI STA. = 378+86.28
 Δ = 5° 35' 29" (LT)
 D = 1° 51' 49"
 R = 3,074.29'
 T = 150.12'
 L = 300.01'
 E = 3.66'
 e = 2.3%
 T.R. = 114.78'
 S.E. RUN = 132'
 P.C. STA. = 377+36.15
 P.T. STA. = 380+36.16

DESIGN SPEED = 45 MPH

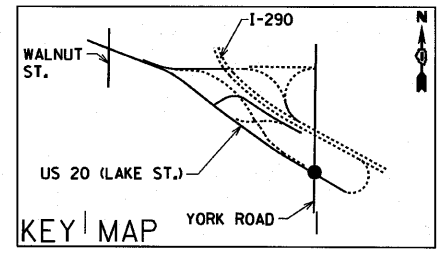

FILE NAME =	USER NAME = nranpfer	DESIGNED -	REVISED -	STATE OF ILLINOIS DEPARTMENT OF TRANSPORTATION		U.S. ROUTE 20 (LAKE STREET) ROADWAY PLAN		F.A.J. RTE.	SECTION	COUNTY	TOTAL SHEETS	SHEET NO.
FILEL		DRAWN - BLV	REVISED -					3537	(4Y & 22-3R-2)	DUPAGE	284	45
		CHECKED - SRG	REVISED -					CONTRACT NO. 62093				
		DATE - 1/18/10	REVISED -					FED. ROAD DIST. NO. [ILLINOIS] FED. AID PROJECT				
				SCALE: 1"=50'		SHEET NO. 45 OF SHEETS		STA. 379+00 TO STA. 390+25				