

PLAN	SURVEYED	DATE
	ALIGNED	
	NOTE BOOK	
	NO. OF WAY CHECKED	
	ROAD FILE NAME	

PROFILE	SURVEYED	DATE
	PLANNED	
	NOTE BOOK	
	NO. OF WAY CHECKED	
	STRUCTURE NOTATIONS CHRD	

BM#3 ELEV. 686.637 PKN
 STA. 384+38.99 "LAKE ST.", 42.66' LT.
 BM#7 ELEV. 690.152 PKN
 STA. 379+27.63 "LAKE ST.", 6.89' LT.

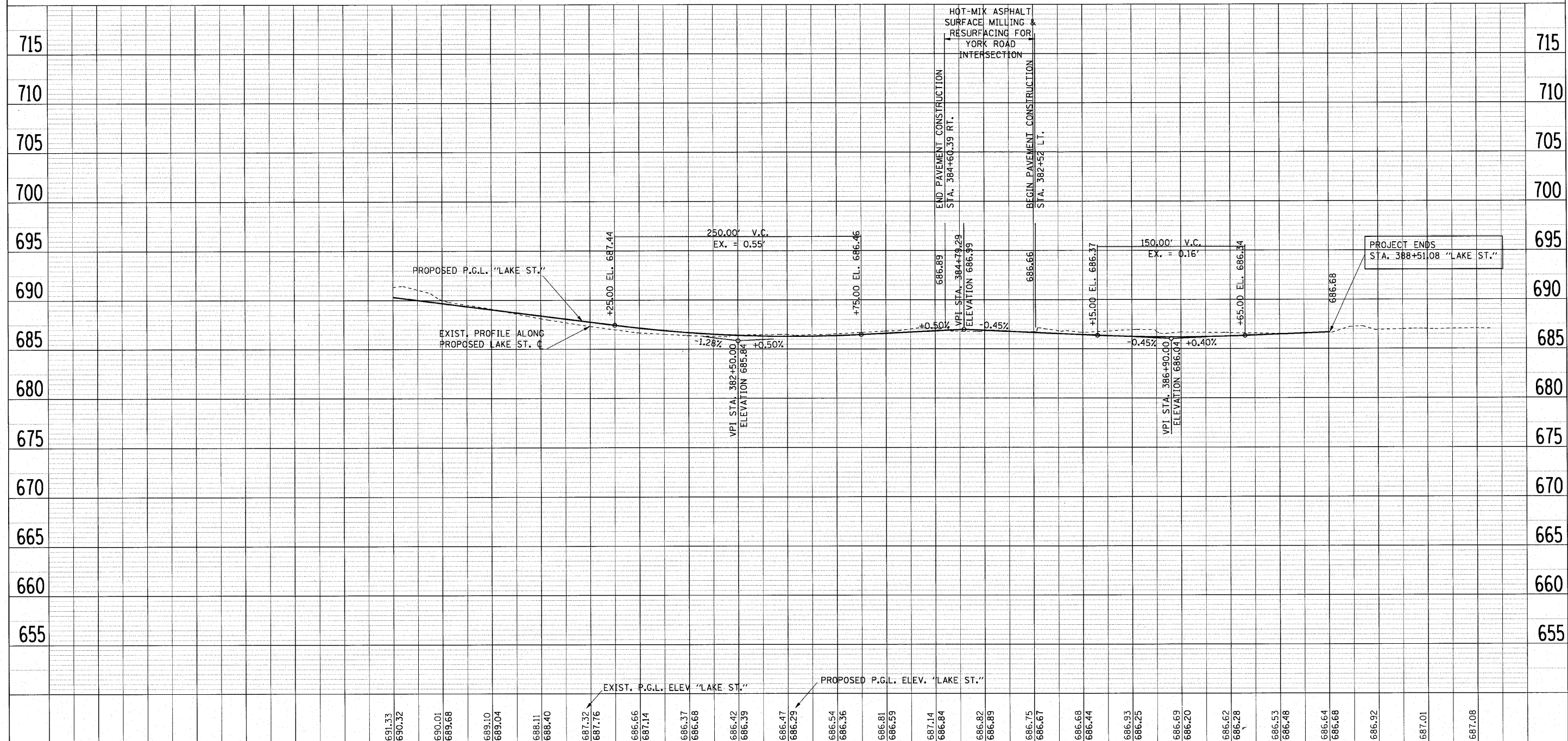

691.33	690.32	690.01	689.68	689.10	689.04	688.11	688.40	687.32	687.76	686.66	687.14	686.37	686.68	686.42	686.39	686.47	686.29	686.54	686.36	686.81	686.59	687.14	686.84	686.82	686.89	686.75	686.67	686.68	686.44	686.93	686.25	686.69	686.20	686.62	686.28	686.53	686.48	686.64	686.68	686.92	687.01	687.08					
379+00				380+00				381+00				382+00				383+00				384+00				385+00				386+00				387+00				388+00				389+00				390+00			

FILE NAME = 001.profile.dgn	USER NAME = IDDTIeng	DESIGNED -	REVISED -	STATE OF ILLINOIS DEPARTMENT OF TRANSPORTATION	U.S. ROUTE 20 (LAKE STREET) ROADWAY PROFILE				F.A.U. RTE. 3537	SECTION (4Y & 22-3R-2)	COUNTY DUPAGE	TOTAL SHEETS 284	SHEET NO. 51
PLOT SCALE = 50.0000' / 1"	CHECKED - SRG	REVISED -	REVISED -		SCALE: 1:50 H 1:5 V	SHEET NO. 51 OF	SHEETS	STA. 379+00	TO STA. 390+25	FED. ROAD DIST. NO.	ILLINOIS FED. AID PROJECT	CONTRACT NO. 62093	
PLOT DATE = 3/23/2010	DATE - 1/18/10	REVISED -	REVISED -										