

RAMP 'WB' / US ROUTE 20 (LAKE STREET)  
 STA. 17+50 'WB' TO STA. 384+60 LAKE STREET  
 MAINTENANCE OF TRAFFIC  
 STAGE I  
 TYPICAL SECTION 4

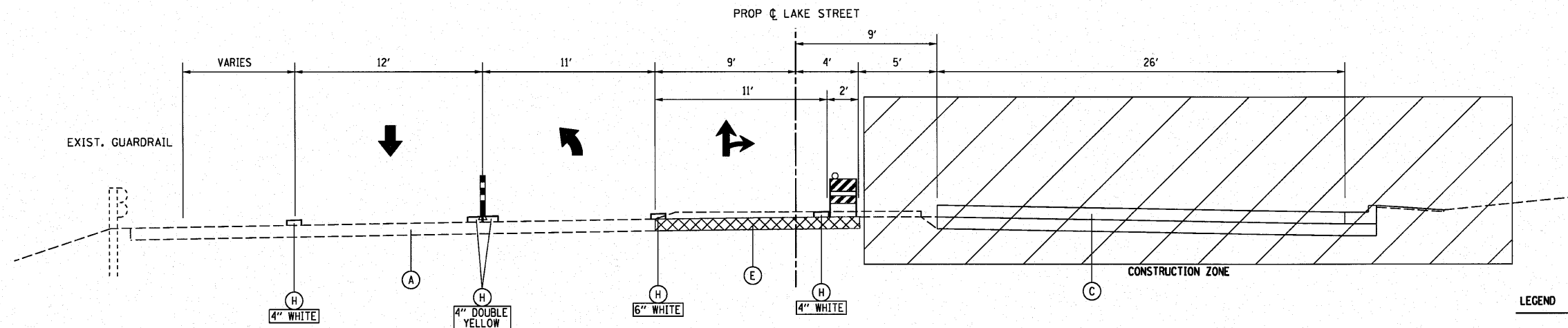

US ROUTE 20 (LAKE STREET)  
 STA. 381+00 TO STA. 384+60  
 MAINTENANCE OF TRAFFIC  
 STAGE I  
 TYPICAL SECTION 5

LEGEND

- (A) EXISTING PAVEMENT
- (B) PROPOSED PAVEMENT CONSTRUCTED IN PRESTAGE
- (C) PROPOSED PAVEMENT CONSTRUCTED IN STAGE I
- (D) PROPOSED PAVEMENT CONSTRUCTED IN STAGE II
- (E) TEMPORARY PAVEMENT CONSTRUCTED IN PRESTAGE
- (F) TEMPORARY PAVEMENT CONSTRUCTED IN STAGE III
- (G) EXISTING/PROPOSED PAVEMENT MARKING (TYP.)
- (H) TEMPORARY PAVEMENT MARKING (TYP.)
- (I) TEMPORARY CONCRETE MEDIAN BARRIER

FILE NAME = *FILEL*	USER NAME = *USER*	DESIGNED -	REVISED -	<b>STATE OF ILLINOIS DEPARTMENT OF TRANSPORTATION</b>	<b>MAINTENANCE OF TRAFFIC TYPICAL SECTION STAGE I</b>			F.A.U. RTE. 3537	SECTION (4Y&22-3R-2)	COUNTY DUPAGE	TOTAL SHEETS 284	SHEET NO. 61
	PLOT SCALE = *SCALE*	CHECKED - SRG	REVISED -		SCALE: N.T.S.	SHEET NO. 61 OF	SHEETS	STA.	TO STA.	CONTRACT NO. 62093		
PLOT DATE = *DATE*	DATE - 1/18/10	REVISED -	REVISED -						FED. ROAD DIST. NO.	ILLINOIS	FED. AID PROJECT	