

**LEGEND**

- TEMPORARY PAVEMENT 10" (SEE SPECIAL PROVISION)
- WORK AREA
- CONSTRUCTION SIGN
- TYPE II BARRICADE/ REFLECTORIZED DRUM
- TYPE III BARRICADE W/2 FLASHING BEACONS (NO. OF BARRICADES AS DIRECTED BY THE ENGINEER)
- DIRECTION OF TRAFFIC
- TEMPORARY PAVEMENT MARKING
- FLASHING ARROW BOARD
- CONSTRUCTION SIGN LABEL. REFER TO GENERAL NOTES FOR MAINTENANCE OF TRAFFIC
- TEMPORARY CONCRETE BARRIER

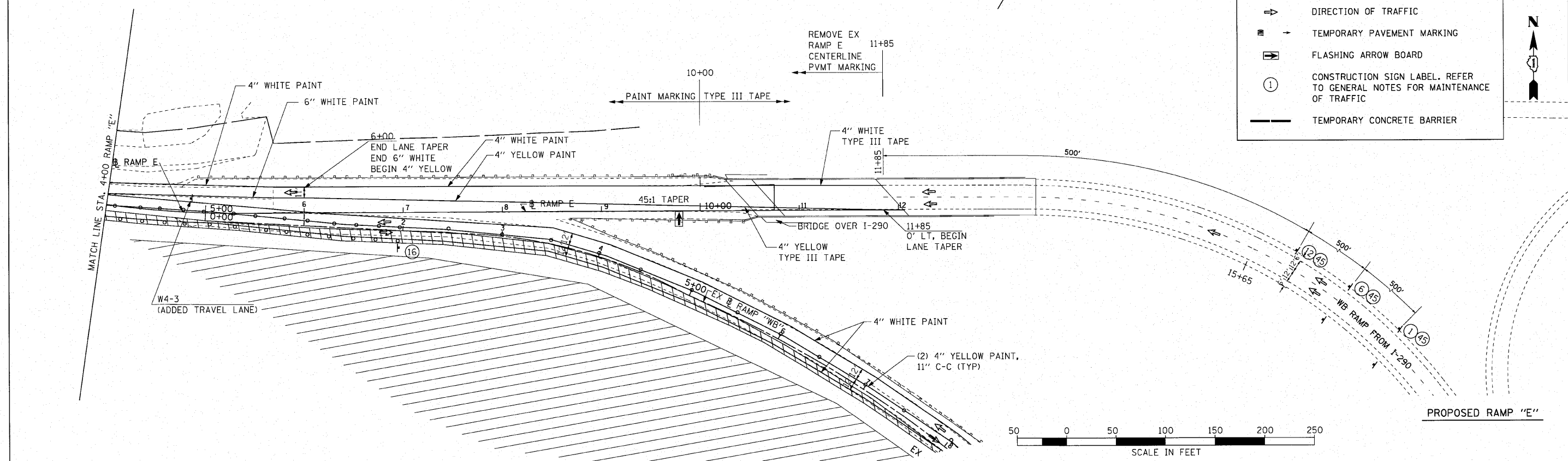

FILE NAME = 001_MOT.dgn	USER NAME = Matt Rempfer 1DDT V8	DESIGNED -	REVISED -	<b>STATE OF ILLINOIS DEPARTMENT OF TRANSPORTATION</b>	<b>RAMPS "E", "F", "WB", "O" AND I-290 MAINTENANCE OF TRAFFIC STAGE I</b>	F.A.U. RTE.	SECTION	COUNTY	TOTAL SHEETS	SHEET NO.
	PLDT SCALE = 5/8"=0'00" / in.	DRAWN - BLV	REVISED -			3537	(4)822-3R-2	DUPAGE	284	73
	PLDT DATE = 4/12/2010	CHECKED - SRG	REVISED -			CONTRACT NO. 62093				
		DATE - 1/18/10	REVISED -			FED. ROAD DIST. NO. ILLINOIS FED. AID PROJECT				