

| LEGEND | |
|--------|---|
| | TEMPORARY PAVEMENT 10\"/> |
| | WORK AREA |
| | CONSTRUCTION SIGN |
| | TYPE II BARRICADE/ REFLECTORIZED DRUM |
| | TYPE III BARRICADE W/2 FLASHING BEACONS (NO. OF BARRICADES AS DIRECTED BY THE ENGINEER) |
| | DIRECTION OF TRAFFIC |
| | TEMPORARY PAVEMENT MARKING |
| | FLASHING ARROW BOARD |
| | CONSTRUCTION SIGN LABEL. REFER TO GENERAL NOTES FOR MAINTENANCE OF TRAFFIC |
| | TEMPORARY CONCRETE BARRIER |

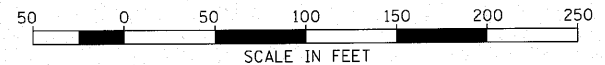
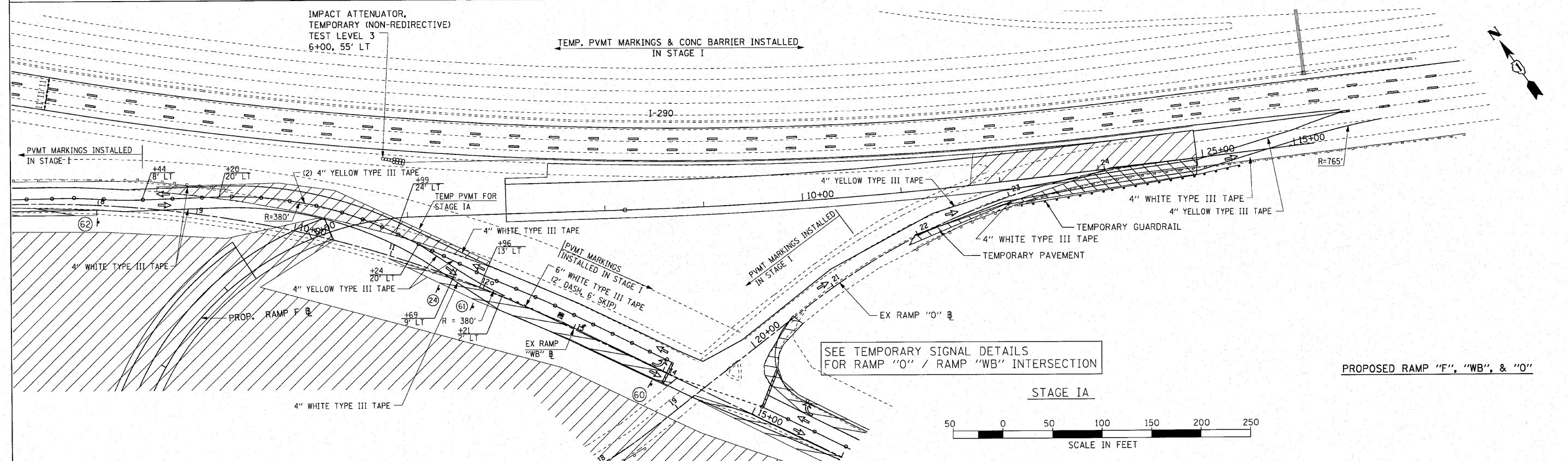

| | | | | | | | | | | | | |
|-----------------------------|----------------------------------|------------|-----------|---|--|-----------------|--------|------------------|----------------------|--------------------|------------------|--------------|
| FILE NAME = 021_MDT.dgn | USER NAME = Matt Rampfer 1007 V8 | DESIGNED - | REVISED - | STATE OF ILLINOIS DEPARTMENT OF TRANSPORTATION | RAMPS "F", "E", "WB", "O", & I-290 MAINTENANCE OF TRAFFIC STAGE IA & IB | | | F.A.U. RTE. 3537 | SECTION (4Y&22-3)R-2 | COUNTY DUPAGE | TOTAL SHEETS 284 | SHEET NO. 75 |
| PLOT SCALE = 50.0000' / in. | CHECKED - SRG | REVISED - | REVISED - | | SCALE: 1"=50' | SHEET NO. 75 OF | SHEETS | STA. | TO STA. | CONTRACT NO. 62093 | | |
| PLOT DATE = 4/12/2010 | DATE - 1/18/10 | REVISED - | REVISED - | | FED. ROAD DIST. NO. ILLINOIS FED. AID PROJECT | | | | | | | |
| | | | | | | | | | | | | |