

CULVERT REMOVAL				STORM SEWER REMOVAL				INLET REMOVAL TYPE 1 (SPECIAL)		INLET REMOVAL		CATCH BASIN REMOVAL	
STA.	TO STA.	LF	PIPE	STA.	TO STA.	LF	PIPE	STA.	OFFSET	STA.	OFFSET	STA.	OFFSET
376+40	376+50	50	24\" RCP	368+24	368+24	82	15\" RCP	368+24	35' RT.	368+24	23.0' RT.	376+15	82.0' RT.
				368+24	368+24	12	12\" RCP	372+28	44' RT.	372+30	30.0' RT.		
				372+34	372+44	46	15\" RCP	375+34	44' RT.				
				375+70	376+15	45	12\" RCP	376+20	45' RT.				
				376+15	376+21	6	12\" RCP						
				376+15	376+20	34	12\" RCP						
				376+20	376+30	50	12\" RCP						

NOTE:
HEADWALL OR END SECTION REMOVAL IS INCLUDED IN THE COST OF REMOVING THE STORM SEWER OR CULVERT

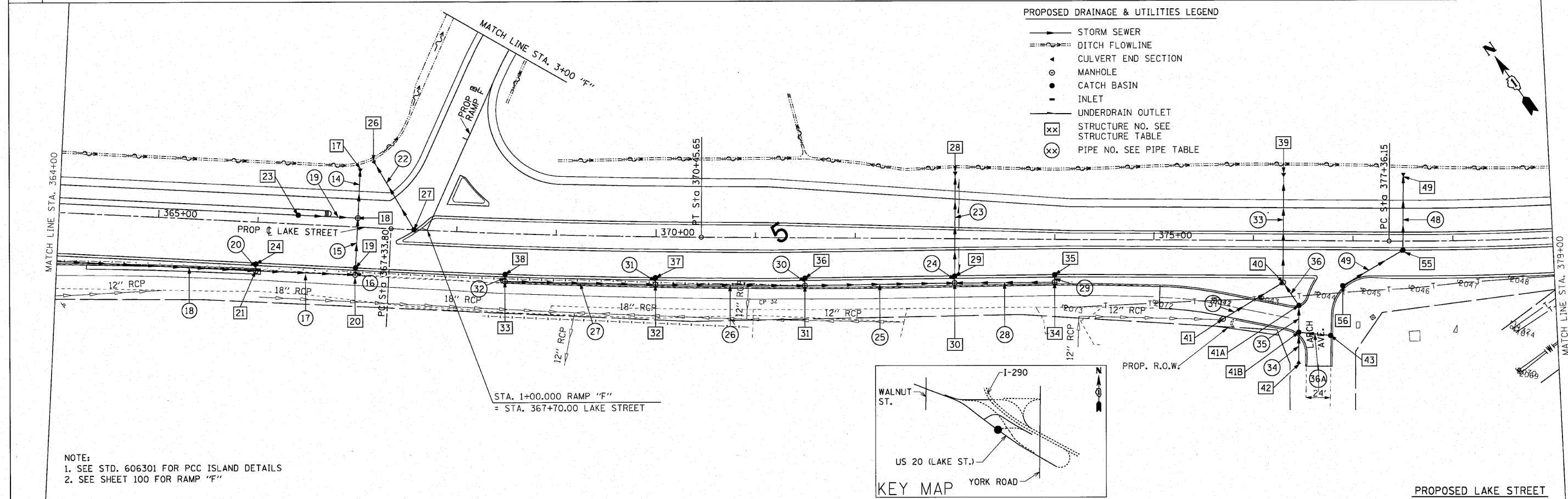
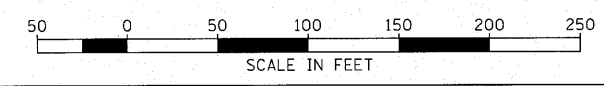

NOTE:
1. SEE STD. 606301 FOR PCC ISLAND DETAILS
2. SEE SHEET 100 FOR RAMP "F"

FILE NAME = DU.plan.dgn	USER NAME = ID07(eng)	DESIGNED -	REVISED -	STATE OF ILLINOIS DEPARTMENT OF TRANSPORTATION	U.S. ROUTE 20 (LAKE STREET) DRAINAGE AND UTILITIES	F.A.U. RTE. 3537	SECTION (4Y & 22-3R-2)	COUNTY DUPAGE	TOTAL SHEETS 284	SHEET NO. 97		
		DRAWN - PRH	REVISED -			SCALE: 1"=50'	SHEET NO. 97 OF SHEETS	STA. 364+00 TO STA. 379+00	CONTRACT NO. 62093			
		CHECKED - SRG	REVISED -			FED. ROAD DIST. NO. ILLINOIS FED. AID PROJECT						
		DATE - 1/18/10	REVISED -									