

BOX CULVERT REMOVAL				PAVED DITCH REMOVAL			CATCH BASIN REMOVAL	
STA.	TO STA.	LF	PIPE	STA.	TO STA.	LF	STA.	OFFSET
382+65	382+65	120	24"x48" BOX	380+46	382+59	227	382+65	0' RT.
							383+45	40' LT.

STORM SEWER REMOVAL				INLET REMOVAL	
STA.	TO STA.	LF	PIPE	STA.	OFFSET
380+46	380+46	90	15" RCP	380+46	40.0' RT.
383+45	383+45	40	12" RCP	382+65	34.0' RT.
383+45	384+27	110	12" RCP	384+27	33.0' RT.
386+80	386+80	30	12" RCP	386+80	10.0' LT.

NOTE:
HEADWALL OR END SECTION REMOVAL IS INCLUDED IN THE COST OF REMOVING THE STORM SEWER OR CULVERT

- EXISTING DRAINAGE & UTILITIES LEGEND**
- STORM SEWER
 - STORM SEWER TO BE REMOVED
 - PIPE CULVERT
 - PIPE CULVERT TO BE REMOVED
 - - - COMBINATION SEWER
 - MANHOLE
 - CATCH BASIN
 - INLET
 - X STRUCTURE TO BE REMOVED
 - PAVED DITCH TO BE REMOVED

EXISTING LAKE STREET

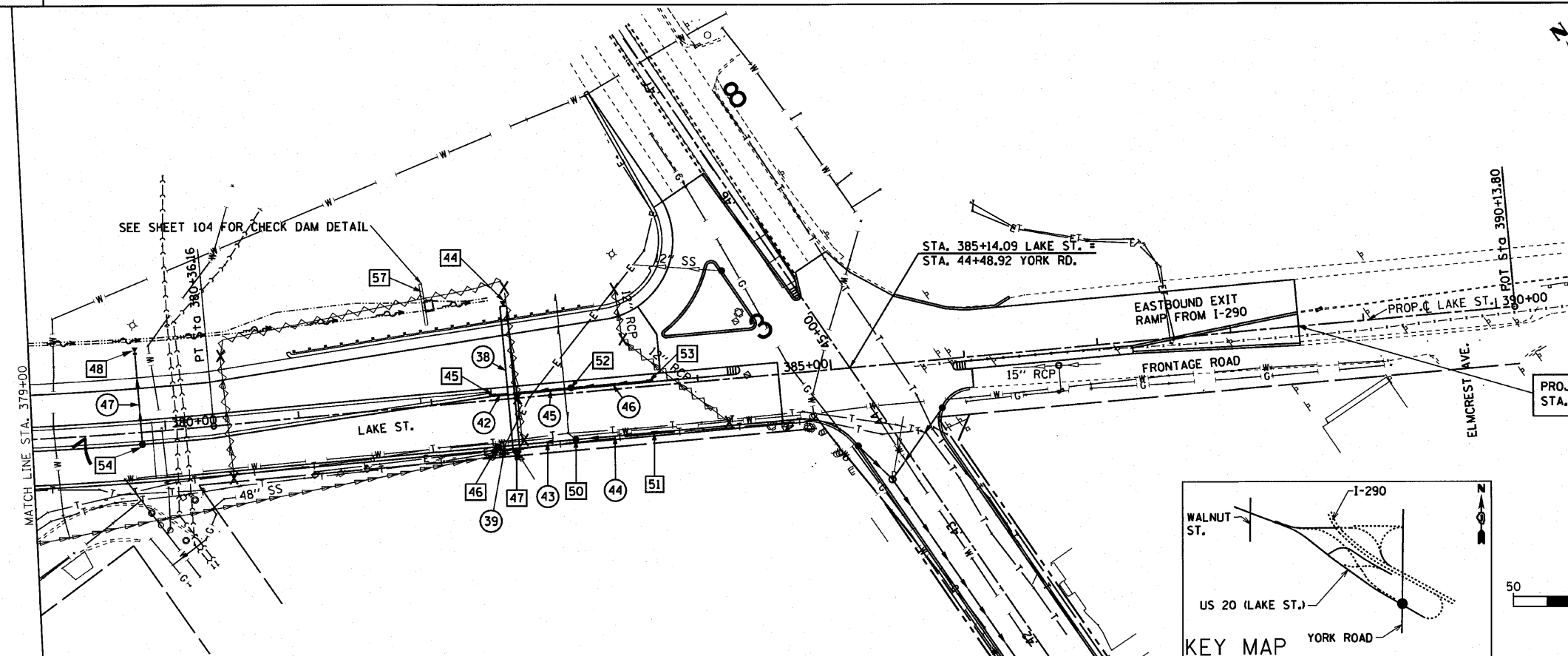

- PROPOSED DRAINAGE & UTILITIES LEGEND**
- STORM SEWER
 - DITCH FLOWLINE
 - ◁ CULVERT END SECTION
 - MANHOLE
 - CATCH BASIN
 - INLET
 - UNDERDRAIN OUTLET
 - ☒ STRUCTURE NO. SEE STRUCTURE TABLE
 - ⊙ PIPE NO. SEE PIPE TABLE

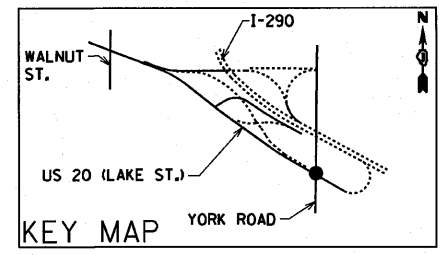
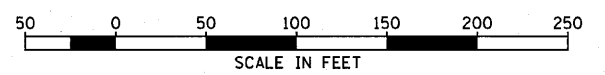

PROPOSED LAKE STREET

FILE NAME = DU.pln.dgn	USER NAME = mrcmpfer	DESIGNED -	REVISED -	STATE OF ILLINOIS DEPARTMENT OF TRANSPORTATION	U.S. ROUTE 20 (LAKE STREET) DRAINAGE AND UTILITIES			F.A.U. RTE. 3537	SECTION (4Y & 22-3R-2)	COUNTY DUPAGE	TOTAL SHEETS 284	SHEET NO. 98
\$FILEL*	PLOT SCALE = 1"=50'	DRAWN - PRH	REVISED -		SCALE: 1"=50'	SHEET NO. 98 OF	SHEETS	STA. 379+00	TO STA. 390+25	CONTRACT NO. 62093		
	PLOT DATE = 6/4/2010	CHECKED - SRG	REVISED -		FED. ROAD DIST. NO. ILLINOIS FED. AID PROJECT							
		DATE - 1/18/10	REVISED -									