

Part of the Northeast 1/4 of Section 35, Township 40 North, Range 11, East of the Third Principal Meridian, DuPage Co. Illinois.

PARCEL NUMBER	OWNER	TOTAL HOLDINGS ACRES	PART TAKEN		AREA IN EXISTING R.O.W. ACRES	REMAINDER ACRES	EASEMENT AREA		PURPOSE OF EASEMENT	PROPERTY ACQUIRED BY
			ACRES	SQ. FT.			ACRES	SQ. FT.		
1CU0117	Forest Park National Bank & Trust Company, as trustee, under Trust No. 981104 dated December 03, 1998	0.696	0.004	158		0.692	-	-		

LEGEND

SECTION CORNER
QUARTER SECTION CORNER

SECTION LINE
QUARTER SECTION LINE
PROPERTY LINE (SURVEY)
PLATTED LOT LINE (RECORD)
EXISTING RIGHT OF WAY LINE
CENTER LINE (EXST. R.O.W.)
PROPOSED BASELINE (CONSTRUCTION)
PROPOSED RIGHT OF WAY LINE
PROPOSED EASEMENT
MEASURED/COMPUTED DIMENSION
RECORD DIMENSION
METRIC DIMENSION
EXISTING BUILDING

SCALE 1"=30'

ALL BEARINGS ARE BASED ON ILLINOIS PLANE COORDINATE SYSTEM EAST ZONE GRID.

○ IRON PIPE OR ROD FOUND
● REPLACED AFTER CONSTRUCTION
+ CUT CROSS FOUND OR SET
■ STAKING OF PROPOSED RIGHT OF WAY. SET DIVISION OF HIGHWAYS SURVEY MARKER TO MONUMENT THE POSITION SHOWN. IDENTIFIED BY INSCRIPTION DATA AND SURVEYORS REGISTRATION NUMBER.
■ STAKING OF PROPOSED RIGHT OF WAY IN CULTIVATED AREAS. BURIED 5/8 INCH METAL ROD 20 INCHES BELOW GROUND TO MARK FUTURE SURVEY MARKER POSITION IDENTIFIED BY COLORED PLASTIC CAP BEARING SURVEYORS REGISTRATION NUMBER
⊙ PERMANENT SURVEY MARKER, I.D.O.T STD 2135 (TO BE SET BY OTHERS)



STATE OF ILLINOIS }
COUNTY OF COOK } SS

THIS IS TO CERTIFY THAT I, DAVID D. O'BRIEN, AN ILLINOIS PROFESSIONAL LAND SURVEYOR, HAVE SURVEYED THE PLAT OF HIGHWAYS SHOWN HEREON, SECTION 35, TOWNSHIP 40 N., RANGE 11 E. OF THE THIRD PRINCIPAL MERIDIAN, DuPage COUNTY, THAT THE SURVEY IS TRUE AND COMPLETE AS SHOWN TO THE BEST OF MY KNOWLEDGE AND BELIEF; THAT THE PLAT CORRECTLY REPRESENTS SAID SURVEY, THAT ALL MONUMENTS FOUND AND ESTABLISHED ARE OF PERMANENT QUALITY AND OCCUPY THE POSITIONS SHOWN THEREON AND THAT THE MONUMENTS ARE SUFFICIENT TO ENABLE THE SURVEY TO BE RETRACED. MADE FOR THE DEPARTMENT OF TRANSPORTATION, STATE OF ILLINOIS.

DATED AT Rolling Meadows, ILLINOIS THIS 20th DAY OF January, 2000 A.D.

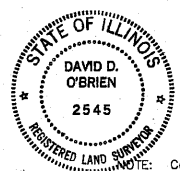

Point Number	Tie Point	Distance	Point Description
935	T1	76.77'	Corner of building
	T2	23.23'	Corner of building
	T3	59.76'	Corner of building
936	T2	71.95'	Corner of building
	T3	82.11'	Corner of building
	T4	82.93'	Corner of building

NOTE: Coordinates are ground values and can be converted to Grid Values by multiplying the published ground coordinates by 0.9999862547

COORDINATE TABLE				
NO.	STATION	OFFSET	NORTH	EAST
935	375+63.00	86.37' RT.	1911507.523	1090636.450
936	376+26.11	95.00' RT.	1911463.886	1090682.857

Mail to: Illinois Department of Transportation
ATTN: Land Acquisition - 3rd Floor
201 W. Center Court
Schaumburg, IL 60196-1096



US 20 / LAKE STREET
PROPOSED CURVE DATA

CURVE NO. 13
Δ = 5°35'20" Lt.
R = 3,075.65'
T = 150.12'
L = 300.00'
PC = 377+36.15
PT = 380+36.16

PLAT OF HIGHWAYS
STATE OF ILLINOIS
DEPARTMENT OF TRANSPORTATION
US 20 FAU 3537 (US 20) LAKE STREET
DuPage COUNTY

PROJECT STATION 374+00 TO STATION 377+00
JOB NO. R-91-013-99
SCALE 1"=30' SHEET 33 OF 35

BUREAU OF LAND ACQUISITION
201 WEST CENTER COURT
SCHAUMBURG, ILLINOIS 60196